

X
Kontaktanordnung
Contact arrangement

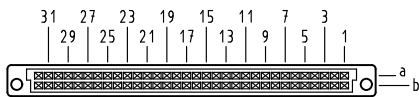

64 Einlöt-Kontakte
64 solder-contacts

- ⊠ = Einlöt-Kontakt
= solder-contact
- = Kontaktposition nicht belegt
= position without contact

X
(Lochbild)
(Board drillings)

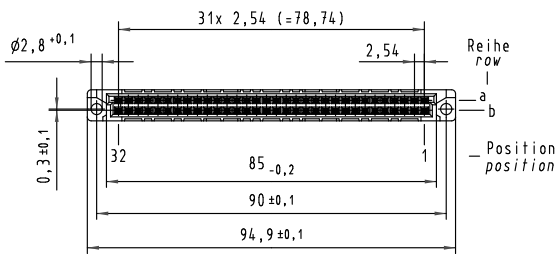
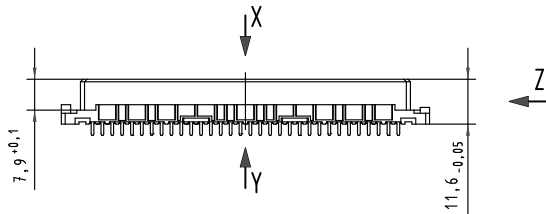
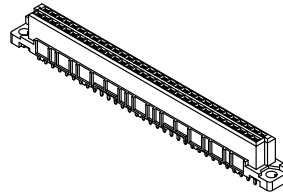
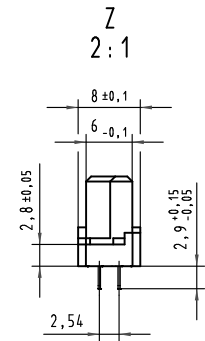
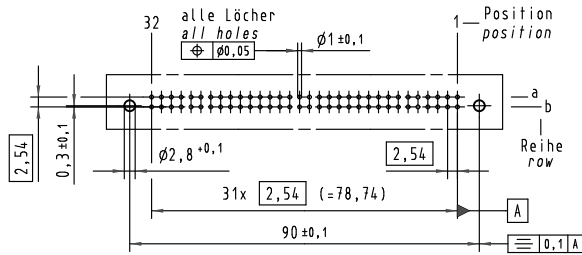

Y
10:1
Querschnitt der Lötanschlüsse:
cross-section of solder terminations:

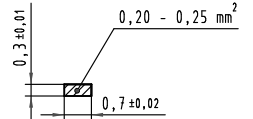

-	-	-
09 02 264 6824	2	Au über/over Ni
09 02 264 2824	1	Au über/over Ni
Bestell-Nr. part-no.	Anforderungsstufe nach IEC performance level acc.to IEC	Kontaktoberfläche contact plating

All Dimensions in mm Original Size DIN A 3			Techn. Character.			Nicht tolerierte Maß/Free size tolerances IEC 60603-2	
			Detail.	12.10.99	Rie.	1:1	har-bus B Federleiste Einlöt 2,9, 64 pol. har-bus B female connector solder 2,9, 64 pol.
			Insp.	12.10.99	Pa.		
34306	02.07.07	LehT	Stand.			2:1	
30231	08.02.02	Rie.	HARTING Electronics GmbH & Co. KG		Sub.		TB 09 02 264 x824
26962	24.01.00	Rie.	D-32339 ESPELKAMP				
26091							Blatt/page
Mod.	Dat.	Name					