

Recommended PCB Layout (Bottom View)

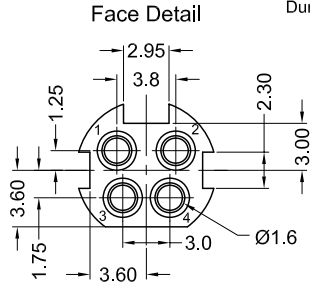

**Material and Finish**

Inner Shield: copper alloy, tin plated  
 Body: PBT thermoplastic UL94V-0 rated color - black  
 Contacts: brass, tin plated

**Electrical Characteristics**

Contact Rating: 7.5A max. @ 20V DC  
 Insulation Resistance: 50 Megohms min. at 250V DC  
 Dielectric Strength: 250 V AC rms for 1 minute  
 Contact Resistance: 30 milliohms max.  
 Operating Temperature: -40°C to +85°C

**Mechanical Specifications**

Insertion Force: 6.0Kg Max.  
 Extraction Force: 0.5-6.0 Kg  
 Durability: 1000 cycles



Tolerances	
X.X	± 0.25
X.XX	± 0.15
Unless Stated Otherwise	

REV.	DATE	DESCRIPTION	REV. BY	CHK. BY	DRAWN BY	DATE
A1	4/13/05	New Drawing	H. MA	C. Furumasa	H. MA	3/8/05
A2	03/17/10	ECO #10-018	S. Vlen	H. MA		
A3	10/19/10	Add Operating Temp.	S. Vlen	H. MA		
A4	03/04/11	Remove Dim	S. Vlen	H. MA		
A5	04/19/11	Remove Dim	S. Vlen	H. MA		

**KPJX-4S**

UNITS: mm

DC Power Jack, RoHS Compliant  
 4 Position, Non-Shielded

