

Materials and Finish

Housing: PBT Thermoplastic, UL94V-0 rated
 Insulator Material Color: black
 Center Pin: copper alloy, nickel plated
 Pins #1, 3: brass, tin plated
 Pin #2: phosphor bronze, tin plated

Mechanical Characteristics

Durability Test: 5000 cycles min.
 Insertion Force: 0.3 kg - 2.0 kg
 Extraction Force: 0.3 kg - 2.0 kg
 Operating Temperature: -25°C to 85°C

Electrical Properties

Contact resistance
 Before Test
 Between Terminals: 30 milliohms max.
 Plug to Sleeve, Tip Ring: 50 milliohm
 After Test
 Between Terminals: 60 milliohms max.
 Plug to Sleeve, Tip Ring: 100 milliohm
 Rated Voltage: DC 24V
 Rated Current: 2.5 Amps
 Insulation Resistance:
 100 Megohm min. at 500V DC

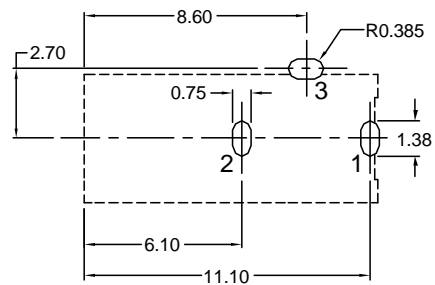

Recommended PCB Layout
(Bottom View)

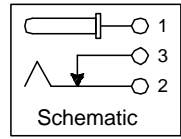

Part Number	Center Post Diameter
KLDX-0201-A	Ø1.00±0.05
KLDX-0201-B	Ø1.30±0.05

RoHS COMPLIANT
 EU Directive 2002/95/EC

Tolerances
 X.X ± 0.25
 X.XX ± 0.15
 Unless Stated
 Otherwise

REV.	DATE	DESCRIPTION	REV. BY	CHK. BY	DRAWN BY	DATE
A1	6/24/05	New Drawing	H. MA	C. Furumasa	H. MA	6/24/05

KLDX-0201-x

Mini DC Power Jack, RoHS Compliant
 1.0 or 1.3mm Center Pin

