

5

4

3

2

1

D

C

B

A

D

C

B

A



Description: H.D. Crimp Pin ,Male,100/Bag
 Part No: 40-9428M
 Application: D-Sub Pin& Sockets
 Crimp Tool: N/A
 Impedance: N/A
 Frequency Range: N/A
 Material: Pin Brass, Gold plated
 RoHS Compliance: Yes
 Technical Detail: N/A

DRAWING NO.
40-9428M-CUST

REVISIONS

| | | | | |
|----|------------------|---|---|---|
| 01 | OFFICIAL RELEASE | | | |
| | 11-27-09 | U | U | H |

| 受控 CONTROLLED DOCUMENT | | | | | |
|------------------------|----------|-----------|----|------------------|-----------|
| 编号 P/N | 40 9428M | 版本 Rev | 01 | 日期 Rel'd Date | DEC 17,09 |

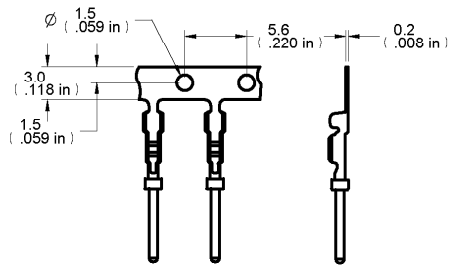

DIM OUTLINE

CUSTOMER COPY

| | | |
|--------------------------------------|-------------|----------|
| TOLERANCE UNLESS OTHERWISE SPECIFIED | DRAWN BY | DATE |
| DECIMALS | BETTY.YU | 11-27-09 |
| X | CHECKED BY | DATE |
| ± 0.5 | BETTY.YU | 11-27-09 |
| XX | APPROVED BY | DATE |
| ± 0.3 | THOMAS | 11-27-09 |
| X XX | | |
| ± 0.1 | | |
| ANGLES | U/M | mm |
| ± 0.5° | | |

EMERSON
Network Power

Connectivity Solutions

TITLE
H.D. CRIMP PIN ,FEMALE,100/BAG

THIS DRAWING WAS PRODUCED BY COMPUTER, DO NOT SCALE DRAWING OR UPDATE MANUALLY.

| | | |
|--------|---------------|------|
| SHEET | DRAWING NO. | SIZE |
| 1 OF 1 | 40-9428M-CUST | A |

5

4

3

2

1