

KYCON, Inc. 1810 Little Orchard Street, San Jose, CA 95125 (408)494-0330

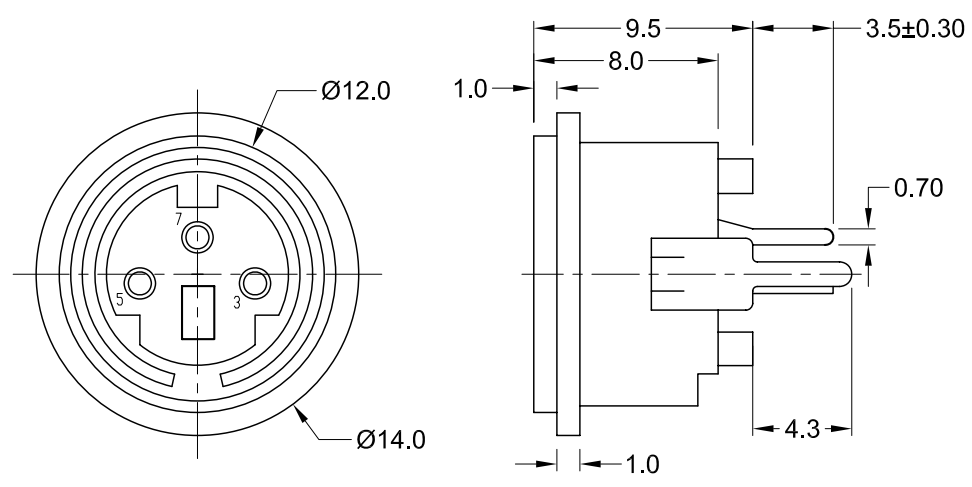

Recommended PCB Layout
(Bottom View)

Material And Finish

Insert- PBT Thermoplastic, Black Color
UL94V-0 Rated
Contact Material- Phosphor Bronze
Contact Plating- Silver Plated

Mechanical Characteristics

Insertion Force- 0.5kg-4.5kg
Withdrawal Force- 0.4kg-3.5kg
Durability- 5000 Cycles Min.

Electrical Characteristics

Contact Current Rating-
2 Amp Max. @ 12V DC
Insulation Resistance-
100 Megohms Min. at 250V DC
Contact Resistance-
Before Durability Testing-
Plug to Shield- 50 milliohms max.
Plug to Terminals- 30 milliohms max.
After Durability Testing-
Plug to Shield- 100 milliohms max.
Plug to Terminals- 60 milliohms max.
Dielectric Withstanding Voltage-
250VAC for 1 Minute
Operating Temperature-
-25°C to +80°C

RoHS COMPLIANT
EU Directive 2002/95/EC

Tolerances
X.X ± 0.25
X.XX ± 0.15
Unless Stated
Otherwise

REV.	DATE	DESCRIPTION	REV. BY	CHK. BY	DRAWN BY	DATE
A1	4/18/05	New Drawing	H. MA	C. Furumasa	H. MA	4/18/05
A2	8/6/09	Remove non use Dlm	H. MA	N/A		

KMDVLX-3S-N

Mini-Din 3 position, Vertical Mount, RoHS Compliant
thru hole, Snap and Lock Compatible,