

D

DELPHI PACKARD ELECTRIC SYSTEMS
WILSON, OHIO 44468

DO NOT SCALE

PRINT NO
1219 1020

DATE	SYM	REVISION RECORD	AUTH	DR	CK
29NO96		121291B3 & 12191019 -			
		WERE SEPARATE "C" SIZE -			
		NO REV UPDATE REQ'D	96007B61MVA		

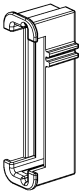

SCALE 2:1

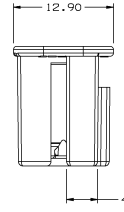
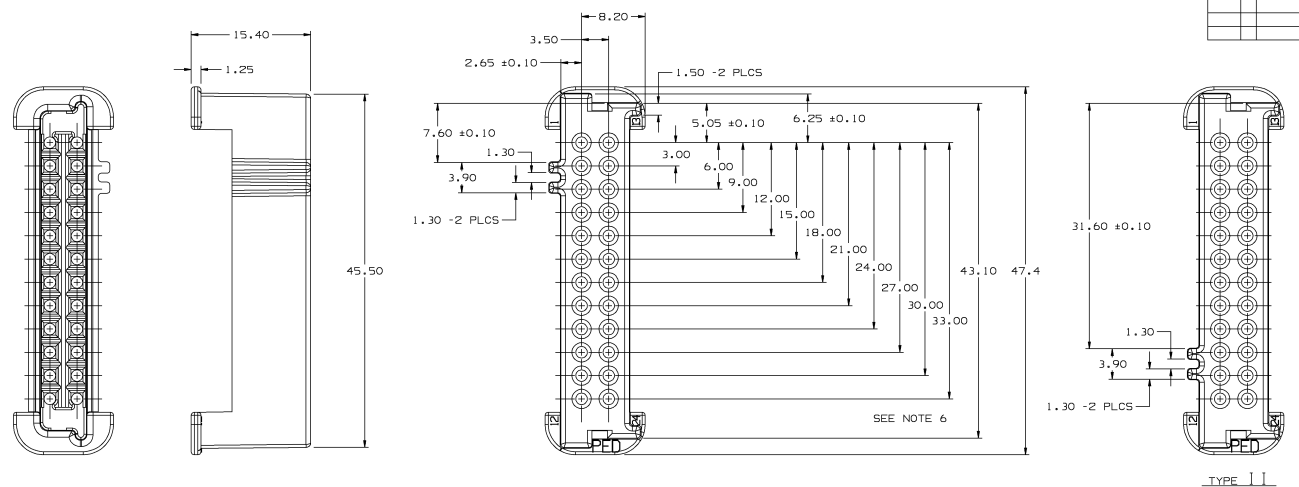

PART NO
1219 1020

TYPE II
SAME AS TYPE I
EXCEPT AS SHOWN

NOTES:

- 1. MATING HEADER CONNECTOR ASM -12092320, OR EQUIVALENT.
- 2. THIS PART ACCEPTS 12110152 CONNECTOR, OR EQUIVALENT.
- 3. THIS PART ALSO USED WITH SEAL 12110403, STRAIN RELIEF 12110155, CAVITY PLUGS 12129557, TERMINAL 120B4912 AND C.P.A. 12110299 OR EQUIVALENTS.
- 4. SEALING CODE 3.
- 5. UNLESS OTHERWISE SPECIFIED AND/OR INDICATED: DIMENSIONS ARE TO FACE OR VIEW SHOWN AND AUTOMATICALLY ROUNDED BY COMPUTER FOR INSPECTION. (SEE MATH MODEL FOR PRECISE DIMENSION) FOR ALL OTHER DIMENSIONS NOT SHOWN BUT REQUIRED FOR TOOL BUILD, SEE MATH MODEL FOR PRECISE TOOL PATH DATA.
- 6. PART IS MANUFACTURED TO GEOMETRIC TOLERANCES. CENTERLINE DIMENSIONS ARE FOR REFERENCE ONLY.

PART NO	REV	STATUS	TYPE	MATERIAL (F) PARTS	MATERIAL SPEC & COLOR	VOL. CM³
12191019	A		II	12129225 12191017	PM002060-002-POLYCARBONATE-CLEAR TRANS	2.059
121291B3	B		I	12129225 12092320	PM002060-014-POLYCARBONATE-BLK TRANS	2.059

DRAWING TYPE	OTHER DRAWINGS AVAILABLE
PID	DETAIL
THIRD ANGLE PROJECTION	
METRIC DIMENSIONS ARE IN MILLIMETERS UNLESS OTHERWISE SPECIFIED OTHERWISE SPECIFY SIZE AND UNIT	
CODE NO: 6900	SEE CHART
DWG DATE: 29NO96	OR 9.6.12001ER00 29NO96
SCALE: 4:1	OR MANUEL VEGA 04DE96
REFERENCE NO	APPROV. BANDHOFF 10DE96
MATERIAL SPEC	VOL. CM³ SEE CHART
NAME: TAXI RETAINER 24F MIC/P 100W	
PART NUMBER: 1219 1020	SIZE: A1