

REV	DATE	DESCRIPTION	BY	CHK
0001	08/14/03	NEW PART		
0002	08/14/03	CHANGED REV VOL, ADDED DELPHI LOGO NOTE & RECYCLING CODE NOTE AND REVISED MAT'L SPEC.		
0003	08/14/03	2-D +0.21/0.10 WMS 23 AND 1075 +0.20/-0.15 WMS 1075		

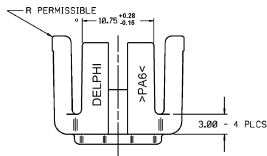
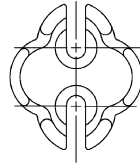
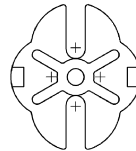
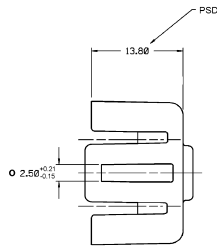
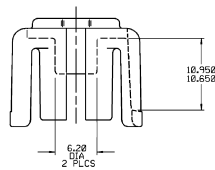

- NOTES** —
- ALL RADI 0.40, UNLESS OTHERWISE SPECIFIED.
 - DIMENSIONS ARE TO FACE OF VIEW SHOWN UNLESS OTHERWISE INDICATED.
 - 3° DRAFT ON ALL OUTSIDE SURFACES UNLESS OTHERWISE SPECIFIED.
 - CAVITIES ARE IDENTICAL, EXCEPT AS SHOWN.
 - WATER CONNECTOR 5558440 OR EQUIVALENT.
 - SECONDARY LOCK FEATURES ARE IDENTICAL.
 - THIS PART IS NOT CONTROLLED FOR AUTOMATIC FEEDING.
 - (2.3) X (0.1) RAISED DELPHI CORPORATE BRAND TO BE LOCATED ON ANY EXTERIOR SURFACE, PREVIOUSLY VISIBLY AT FINAL ADDRESS.
 - OPTIONAL CONSTRUCTION TO BE PREP OR NO LOGO.
 - MATERIAL RECYCLING CODE 17MRS88 PER SAE J1404 (2.3) X (0.1) RAISED CHARACTER AS SHOWN TO BE LOCATED ON ANY EXTERIOR SURFACE. OPTIONAL CONSTRUCTION TO BE NO MATERIAL RECYCLING CODE.

DATE	08/14/03
TIME	10:00 AM
BY	...
CHK	...
APP	...
REV	...
DATE	...
TIME	...
BY	...
CHK	...
APP	...
REV	...

DELPHI
DELPHI PACKARD ELECTRIC SYSTEMS
WARREN, OH

DATE	08/14/03
TIME	10:00 AM
BY	...
CHK	...
APP	...
REV	...
DATE	...
TIME	...
BY	...
CHK	...
APP	...
REV	...

12065279

1 OF 1 | 1 OF 1 | R | A4