

Dimensions (In.)

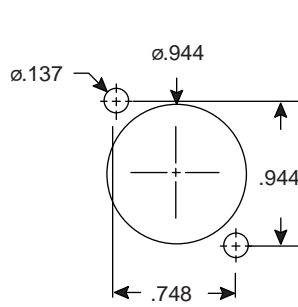

Panel Cut-out

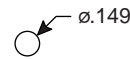

Optional Color Coded Button

- 174-7280(Black)
- 174-7281(Brown)
- 174-7282(Red)
- 174-7283(Orange)
- 174-7284(Yellow)
- 174-7285(Green)
- 174-7286(Blue)
- 174-7287(Violet)
- 174-7288(Gray)
- 174-7289(White)

Specifications:

- Type: universal panel mount, female, latching
- Housing material (see chart): zinc high-pressure diecasting
- Contacts material: silver (3 microns) or gold (0.5 microns) plated brass
- Earth tag: spring steel, nickel plate 3 microns silver plate
- Contact base: valox DR48 UL 94V-0
- Operating temp: -30°C ~ +80°C
- Insertion force: < 20N
- Withdrawal force: < 10N
- Minimum number of insertions: 10,000
- Voltage rating: 250VAC
- Test voltage: 1500VAC.
- Contact resistance: < 3mΩ
- Insulation resistance: > 1GΩ

| Mouser Stock No. | No. of Pins | Contact Plating | Housing Material | Rated Current | Wire Size (max) | Capacitance (pf) |
|------------------|-------------|-----------------|------------------|---------------|-----------------|------------------|
| 164-7163 | 3 | silver | nickel | 16A | 12AWG | < 4 |
| 164-7164 | 4 | silver | nickel | 10A | 4-16AWG | < 7 |
| 164-7165 | 5 | silver | nickel | 5-7.5A | 5-18AWG | < 7 |
| 164-7183 | 3 | silver | black | 16A | 12AWG | < 4 |
| 164-7184 | 4 | silver | black | 10A | 4-16AWG | < 7 |
| 164-7185 | 5 | silver | black | 5-7.5A | 5-18AWG | < 7 |
| 164-72203 | 3 | gold | nickel | 16A | 12AWG | < 4 |
| 164-72204 | 4 | gold | nickel | 10A | 4-16AWG | < 7 |
| 164-72205 | 5 | gold | nickel | 5-7.5A | 5-18AWG | < 7 |
| 164-72403 | 3 | gold | black | 16A | 12AWG | < 4 |
| 164-72404 | 4 | gold | black | 10A | 4-16AWG | < 7 |
| 164-72405 | 5 | gold | black | 5-7.5A | 5-18AWG | < 7 |