

M6 Knurled Nut Included  
(not installed)

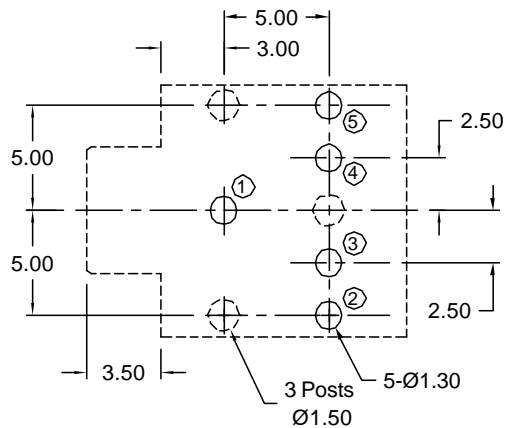
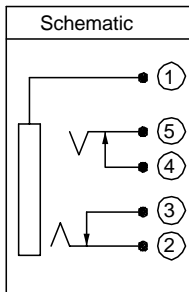
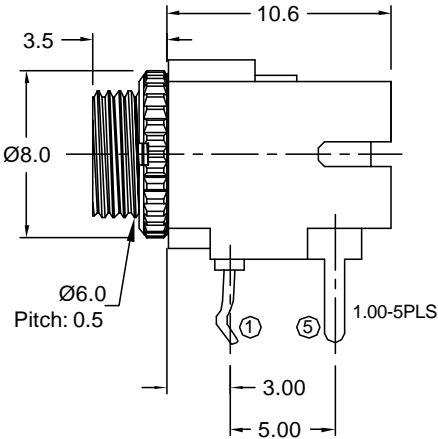

PCB LAYOUT  
(BOTTOM VIEW)

**Materials and Finish**

Housing: PBT Thermoplastic  
30% Glass Filled, Black  
UL 94V-0 Rated

**Terminals:**

- Pin #1 : SPCC, Nickel Plated
- Pin #5 & Pin #2 Contacts:  
Phosphor Bronze, Tin Plated
- Pin #3 and Pin #4 terminals:  
Brass, tin plated
- Bushing: Brass, Nickel plated

**Mechanical Characteristics**

- Insertion Force:  
0.4kg - 2.0kg
- Extraction Force:  
0.3kg - 2.0kg
- Durability: 5000 mating cycles

**Electrical Characteristics**

- Contact Resistance:  
Before Test: 30mohms Max.  
After Durability Test:  
60 mohms Max.
- Insulation Resistance:  
More than 100 Megohms  
at 250V DC
- Dielectric Strength: 250V AC RMS for 1 minute
- Operating Temp:  
-25°C to +80°C



Tolerances	
X.X ± 0.25	
X.XX ± 0.15	
Unless Stated	
Otherwise	

REV.	DATE	DESCRIPTION	REV. BY	CHK. BY	DRAWN BY	DATE
A1	9/6/05	New Drawing	R. Aguirre	H. MA	R. Aguirre	07/13/05
A2	11/8/06	ECO 06-046	R. Aguirre	H. MA		

**STX-3100-5C**

3.5mm Stereo Jack ,RoHS Compliant

One Single Throw Double Pole Switch

