

**SPECIFICATIONS**

**ELECTRICAL**

RESISTANCE RANGE ----- SEE CHART  
 RESISTANCE TOLERANCE ----- ±3%  
 LINEARITY TOLERANCE ----- ±0.25%  
 RESOLUTION ----- SEE CHART  
 END RESISTANCE AT TERM. ----- 1 OHM OR 0.1%  
 ELECTRICAL ANGLE ----- 3600±5°  
 ELECTRICAL NOISE ----- 100 OHM MAX.  
 POWER RATING ----- 1.5 WATTS  
 MAXIMUM VOLTAGE ----- 450 VOLTS  
 INSULATION RESISTANCE ----- 1,000 MEGOHMS @ 500 V.D.C.  
 DIELECTRIC STRENGTH ----- 1,000 V.A.C.

**MECHANICAL**

NUMBER OF TURNS ----- 10  
 MECHANICAL ANGLE ----- 3600±15°-0°  
 TORQUE ----- 0.4 OZ. IN. MAX.  
 STOP STRENGTH ----- 20 OZ. IN. MAX.  
 WEIGHT ----- 0.35 OZ.

**ENVIRONMENTAL**

OPERATING TEMPERATURE ----- -55°c to +105°c  
 TEMPERATURE COEFFICIENT ----- SEE CHART  
 VIBRATION ----- 10HZ TO 2000HZ 15G  
 SHOCK ----- 50G 11ms  
 MOISTURE RESISTANCE ----- 40°C 95%RH 120 HOURS  
 ROTATIONAL LIFE ----- 1,000,000 SHAFT REVOLUTIONS

**MATERIALS**

HOUSING ----- HIGH TEMPERATURE PLASTIC  
 SHAFT ----- STAINLESS STEEL  
 BUSHING ----- BRASS  
 TERMINALS ----- GOLD PLATED  
 ELEMENT ----- WIREWOUND

RESISTANCE	20	50	100	200	500	1K	2K	5K	10K	20K	50K	100K
RESOLUTION	.070	.050	.059	.054	.039	.040	.033	.024	.021	.016	.012	.009
TEMPERATURE COEFFICIENT, PPM/°C	700	700	80	80	80	20	20	20	20	20	20	20

REV.	BY	DATE	PART NO.
C	BT	11-21 87	MW12B-10
			MECH. ANGLE WAS 3600±5° ADDED OPERATING TEMPERATURE

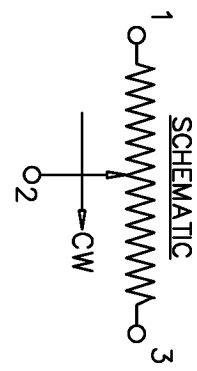
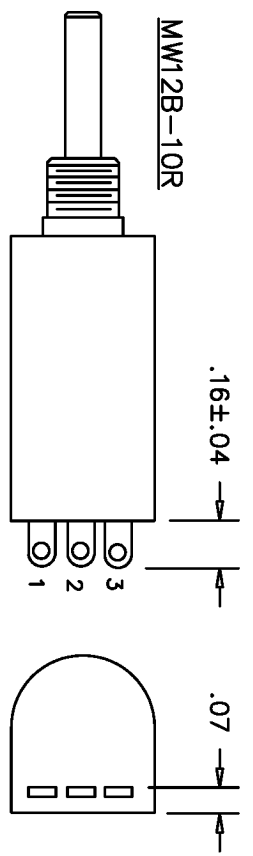
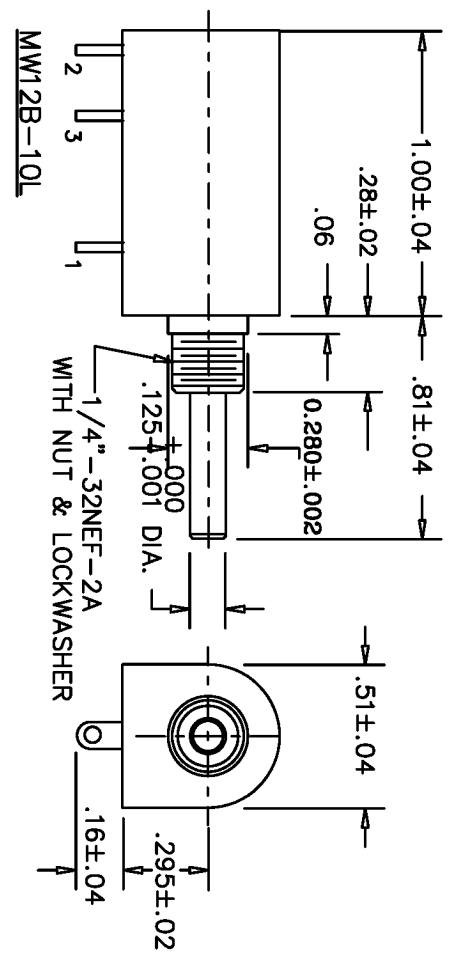

THIS DOCUMENT CONTAINS PROPRIETARY DATA OF POLARIS INDUSTRIAL ENTERPRISES, INC. NO DISCLOSURE, REPRODUCTION, OR USE OF ANY PART THERE OF MAY BE MADE EXCEPT BY WRITTEN PERMISSION.

**TOLERANCES**

XX = +/- .010" FRACT. = +/- 1/64"  
 XXX = +/- .005" ANGLES = +/- 1/2°  
 ALL SPECIFICATIONS SUBJECT TO CHANGE WITHOUT NOTICE.

SCALE	NONE
DATE:	4-3-79
BY	
APPRVD	BT
CODE IDENT:	19477

TITLE  
 MULTI-TURN  
 POTENTIOMETER

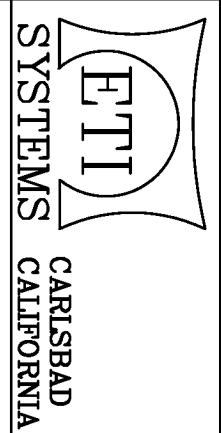

PART NO.  
 MW12B-10