



## Potentiometers

### 317-2090F-Value



RoHS Compliant

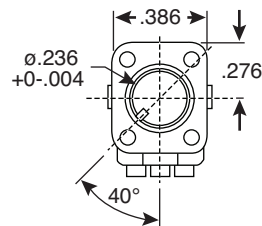
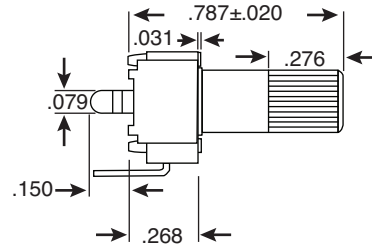
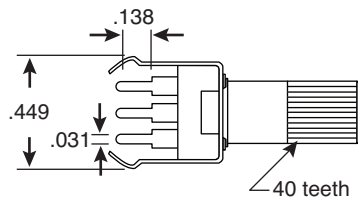
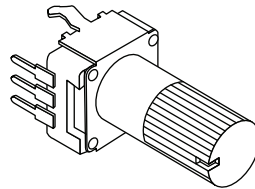

Shaft shown in  
full CCW position.

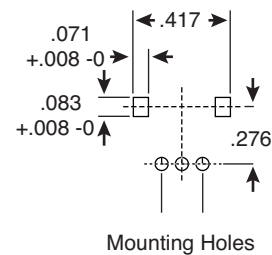

### Dimensions (in.)

#### Specifications:

- Type: miniature, vertical mount snap-in
- Total rotational angle:  $280^{\circ} \pm 5^{\circ}$
- Rotation torque: 10~100g/cm
- Breakdown voltage: 250VAC for 1 minute
- Rated Wattage: .1W
- Working Voltage: 50VAC, 20VDC max.
- Rotational Life: 10,000±100 cycles (No load, 600 cycles/hour)
- Operating Temperature:  $-10^{\circ}\text{C} \sim +70^{\circ}\text{C}$
- Taper: Linear
- Values( $\Omega$ ) : 1K, 2K, 5K, 10K, 50K, 100K, 500K, 1M
- RoHS Compliant