

Coil type EMI Filters (Digital Noise Filters) SMD

Series: **ELKE**

■ Features

- 3218 case size, 2 A rated current.
- No variation in attenuation characteristics as current changes.
- The stable P/N marking using laser technology makes the part number check easier.

■ Typical Specification

- Operating temperature : -20 to +85 °C
- Rated Voltage : DC 50 V (Except ELKE333FA : DC25 V)
- Rated Current : DC 2 A
- Reliability characteristics endurance (High Temp.)
Soldering condition (reflow) : 85 °C 50 V 2 A 1000 h (Spec : 500 h)

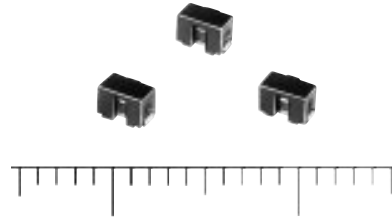

■ Standard Parts

Part No.	Cut off frequency (MHz)	Inner Capacitance (pF typ.)	Rated Voltage (V)	Rated Current (A)	Indication	min. Packaging unit (pcs.)
ELKE100FA	250	10	50	2.0	100□	2000
ELKE220FA	200	22			220□	
ELKE470FA	100	47			470□	
ELKE101FA	50	100			101□	
ELKE221FA	25	220			221□	
ELKE471FA	10	470			471□	
ELKE102FA	5	1000			102□	
ELKE222FA	2	2200			222□	
ELKE103FA	0.5/DC	10000			103□	
ELKE333FA	0.2/DC	33000			25	

note1 : 4th letter (□) of marking indicates the Month Code.

■ Performance characteristics (Reference)

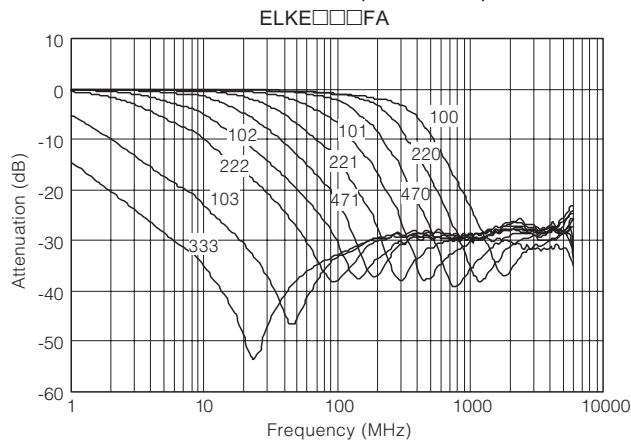

■ Equivalent circuit, measurement block diagram

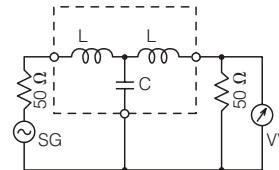

■ Indication Examples



1 0 3 P
 └───┬───┘
 Month Code : 1 Letter
 Inner Capacitance : 3 Letters

Coil type EMI Filters (Digital Noise Filters)

Series: **ELKE**□

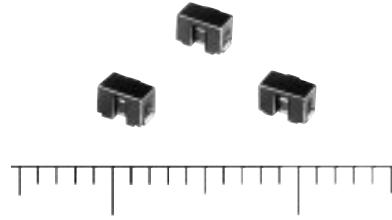

■ Features

- 3218 case size, 5 A rated current (ELKEA) and 2 A rated current (ELKE).
- High ESD suppression with varistor and included coils.
- No variation in attenuation characteristics as current changes.
- The stable P/N marking using laser technology makes the part number check easier.

■ Recommended Applications

- Data lines, secondary power supply lines (DC lines) for game, digital AV and communications equipment.

■ Explanation of Part Numbers

[ELKE, ELKEA Series]

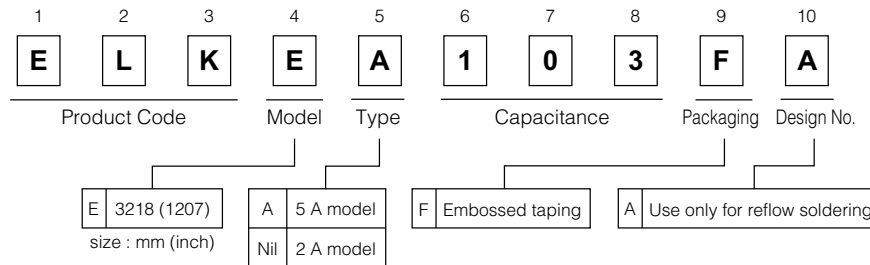

[ELKEV Series]

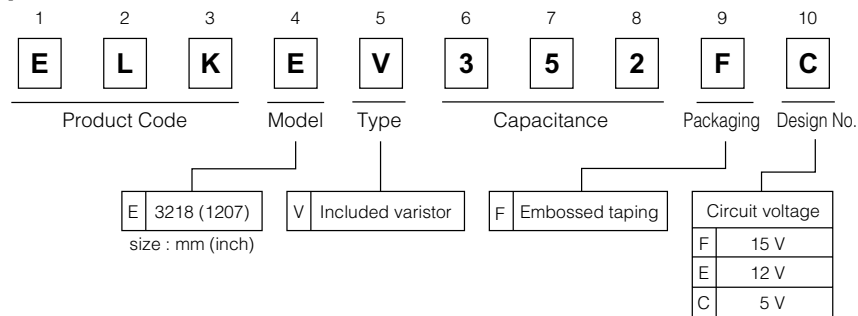

■ Construction

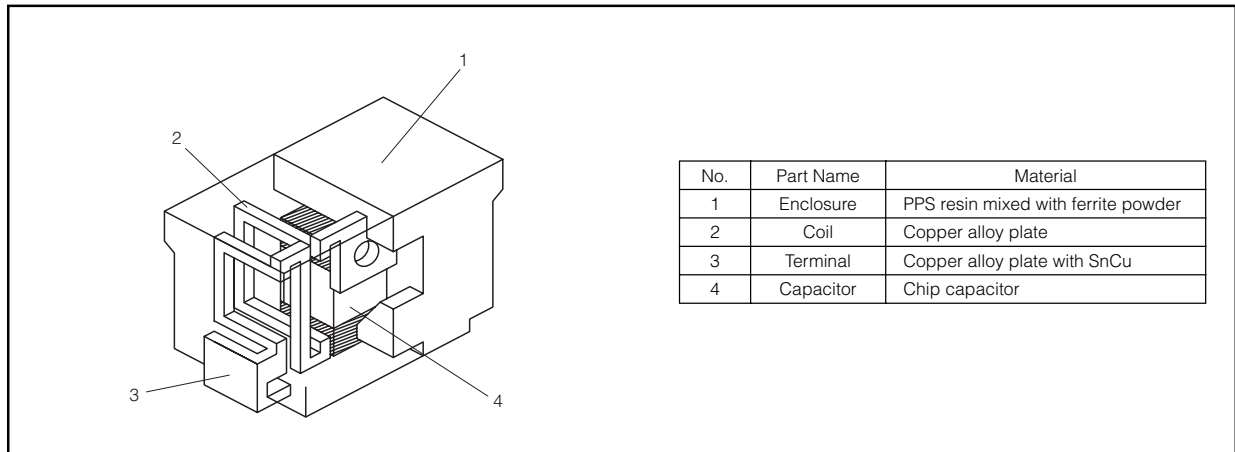

Design and specifications are each subject to change without notice. Ask factory for the current technical specifications before purchase and/or use. Should a safety concern arise regarding this product, please be sure to contact us immediately.

■ Dimensions in mm (not to scale)

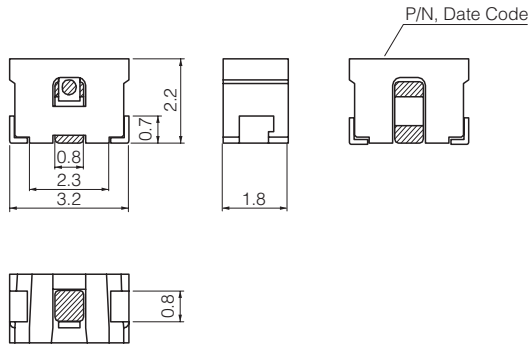

■ Land Pattern in mm (not to scale)

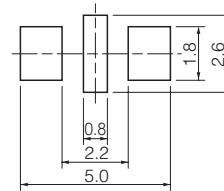

■ Packaging state

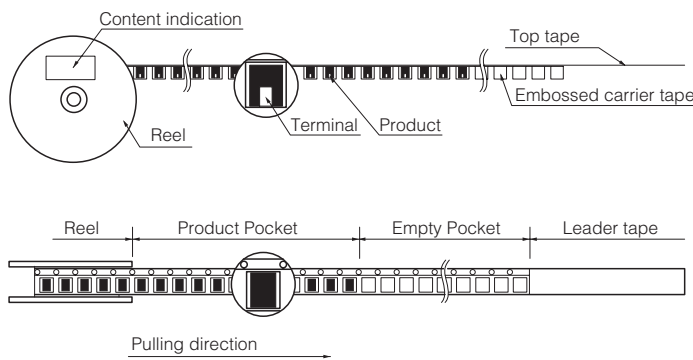

Reel Size : $\phi 178$
 Q'ty : 2000 pcs./Reel
 Packaging : Embossed taping

■ Soldering conditions for reflow

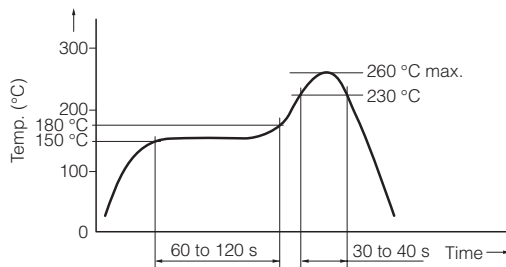

■ Storage Conditions

- Package : Normal temperature (-5 to 35 °C), normal humidity (85 %RH max.), shall not be exposed to direct sunlight and harmful gases and care should be taken so as not to cause dew.
- Operating Temperature : -20 to +85 °C

■ Storage Period

- Solderability may be reduced due to the conditions of high temperature and high humidity which causes the oxidation of tin-plated terminals. Even if storage conditions are within specified limits, solderability may be reduced with the passage of time. Therefore, please control the storage conditions and try to use the product within 6 months of receipt.

Design and specifications are each subject to change without notice. Ask factory for the current technical specifications before purchase and/or use. Should a safety concern arise regarding this product, please be sure to contact us immediately.

Nov. 2007