

CMSSH-3  
 CMSSH-3A  
 CMSSH-3C  
 CMSSH-3S

**SURFACE MOUNT  
 SILICON SCHOTTKY DIODES**

**SUPERmini™**



**SOT-323 CASE**



[www.centrasemi.com](http://www.centrasemi.com)

**DESCRIPTION:**

The CENTRAL SEMICONDUCTOR CMSSH-3 Series types are Silicon Schottky Diodes, epoxy molded in a SUPERmini™ surface mount package, designed for fast switching applications requiring a low forward voltage drop.

**CMSSH-3:** SINGLE  
**CMSSH-3A:** DUAL, COMMON ANODE  
**CMSSH-3C:** DUAL, COMMON CATHODE  
**CMSSH-3S:** DUAL, IN SERIES

**MARKING CODE: 95D**  
**MARKING CODE: B1D**  
**MARKING CODE: B2D**  
**MARKING CODE: A5D**

**MAXIMUM RATINGS: (T<sub>A</sub>=25°C)**

Peak Repetitive Reverse Voltage  
 Continuous Forward Current  
 Peak Repetitive Forward Current  
 Peak Forward Surge Current, tp=10ms  
 Power Dissipation  
 Operating and Storage Junction Temperature  
 Thermal Resistance

**SYMBOL**

V<sub>RRM</sub> 30  
 I<sub>F</sub> 100  
 I<sub>FRM</sub> 200  
 I<sub>FSM</sub> 750  
 P<sub>D</sub> 275  
 T<sub>J</sub>, T<sub>stg</sub> -65 to +150  
 Θ<sub>JA</sub> 455

**UNITS**

V  
 mA  
 mA  
 mA  
 mW  
 °C  
 °C/W

**ELECTRICAL CHARACTERISTICS PER DIODE: (T<sub>A</sub>=25°C unless otherwise noted)**

| SYMBOL          | TEST CONDITIONS  | MIN | TYP  | MAX  | UNITS |
|-----------------|--|-----|------|------|-------|
| I <sub>R</sub>  | V <sub>R</sub> =25V  |     | 90   | 500  | nA    |
| I <sub>R</sub>  | V <sub>R</sub> =25V, T <sub>A</sub> =100°C   |     | 25   | 100  | μA    |
| BV <sub>R</sub> | I <sub>R</sub> =100μA  | 30  |      |      | V     |
| V <sub>F</sub>  | I <sub>F</sub> =2.0mA  |     | 0.29 | 0.33 | V     |
| V <sub>F</sub>  | I <sub>F</sub> =15mA   |     | 0.40 | 0.45 | V     |
| V <sub>F</sub>  | I <sub>F</sub> =100mA  |     | 0.74 | 1.00 | V     |
| C <sub>T</sub>  | V <sub>R</sub> =1.0V, f=1.0MHz   |     | 7.0  |      | pF    |
| t <sub>rr</sub> | I <sub>F</sub> =I <sub>R</sub> =10mA, I <sub>rr</sub> =1.0mA, R <sub>L</sub> =100Ω |     |      | 5.0  | ns    |

R3 (9-February 2010)

CMSSH-3  
 CMSSH-3A  
 CMSSH-3C  
 CMSSH-3S

SURFACE MOUNT  
 SILICON SCHOTTKY DIODES



SOT-323 CASE - MECHANICAL OUTLINE

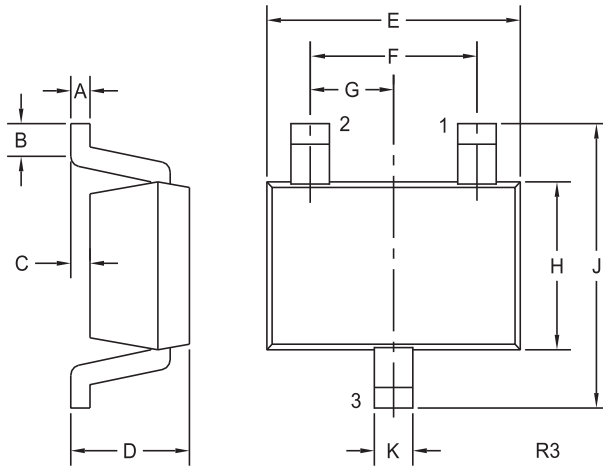

| SYMBOL | DIMENSIONS |       |             |      |
|--------|------------|-------|-------------|------|
|        | INCHES     |       | MILLIMETERS |      |
|        | MIN        | MAX   | MIN         | MAX  |
| A      | 0.002      | 0.008 | 0.05        | 0.20 |
| B      | 0.004      | -     | 0.10        | -    |
| C      | -          | 0.004 | -           | 0.10 |
| D      | 0.031      | 0.043 | 0.80        | 1.10 |
| E      | 0.071      | 0.087 | 1.80        | 2.20 |
| F      | 0.051      |       | 1.30        |      |
| G      | 0.026      |       | 0.65        |      |
| H      | 0.045      | 0.053 | 1.15        | 1.35 |
| J      | 0.079      | 0.087 | 2.00        | 2.20 |
| K      | 0.008      | 0.016 | 0.20        | 0.40 |

SOT-323 (REV: R3)

PIN CONFIGURATIONS

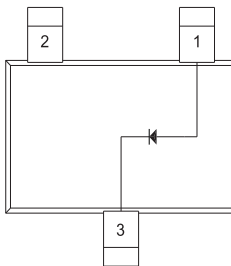

**CMSSH-3**

**LEAD CODE:**

- 1) Anode
- 2) NC
- 3) Cathode

**MARKING CODE: 95D**

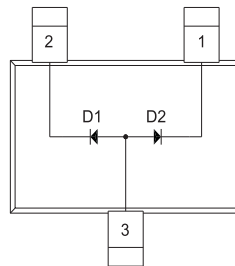

**CMSSH-3A**

**LEAD CODE:**

- 1) Cathode D2
- 2) Cathode D1
- 3) Anode D1, D2

**MARKING CODE: B1D**

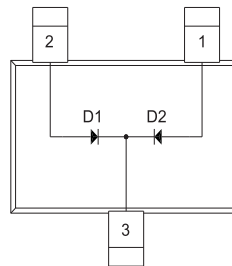

**CMSSH-3C**

**LEAD CODE:**

- 1) Anode D2
- 2) Anode D1
- 3) Cathode D1, D2

**MARKING CODE: B2D**

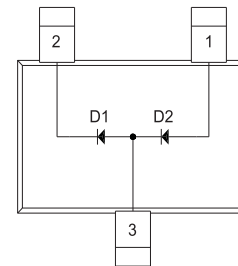

**CMSSH-3S**

**LEAD CODE:**

- 1) Anode D2
- 2) Cathode D1
- 3) Anode D1, Cathode D2

**MARKING CODE: A5D**

R3 (9-February 2010)