

NOTES:

- 1) MATES TO HELIEON MODULE 180081-****
SEE SHEET 2 FOR DIMENSIONS WITH MODULE.
- 2) SOCKET TO BE MOUNTED TO FLAT SURFACE.
SEE SHEET 3 FOR MOUNTING DIMENSIONS.
- 3) ASSEMBLY IS SHIPPED WITH WIRES ROUTED
STRAIGHT OUT. WIRES MAY BE BENT 90°
TO ROUTE DOWN. SEE SHEET 4 FOR ROUTING
INSTRUCTIONS.
- 4) WIRE LENGTH SHOWN NOT TO SCALE.

| | | | | | | |
|---|--|---------------------------------------|--------------------|-------|---|------------------------|
| ENTER DESCRIPTION EC NO: SSL2011-0005 DRAWN:DMCGOWAN 2010/07/27 CHKD: 2010/08/10 APPR:DMCGOWAN 2010/08/10 DESCRIPTION A1 REV | QUALITY SYMBOLS | GENERAL TOLERANCES (UNLESS SPECIFIED) | DIMENSION STYLE | SCALE | DESIGN UNITS | THIRD ANGLE PROJECTION |
| | ▽=0 | mm INCH | MM/IN | 1:1 | METRIC | |
| | ▽=0 | 4 PLACES ± --- ± --- | DRAWN BY DATE | TITLE | HELIEON 80MM SOCKET SALES DRAWING | |
| | ▽=0 | 3 PLACES ± --- ± .005 | MCGOWAN 2010/02/08 | | | |
| | 2 PLACES ± 0.13 ± .01 | CHECKED BY DATE | | | | |
| | 1 PLACE ± 0.25 ± --- | APPROVED BY DATE | | | | |
| | ANGULAR ± 1/2° | DMCGOWAN 2010/03/22 | | | | |
| | DRAFT WHERE APPLICABLE MUST REMAIN WITHIN DIMENSIONS | MATERIAL NO. | 180080-0000 | | DOCUMENT NO. | SD-180080-000 |
| | | SIZE | B | | THIS DRAWING CONTAINS INFORMATION THAT IS PROPRIETARY TO MOLEX INCORPORATED AND SHOULD NOT BE USED WITHOUT WRITTEN PERMISSION | |
| | | | | | SHEET NO. | 1 OF 3 |

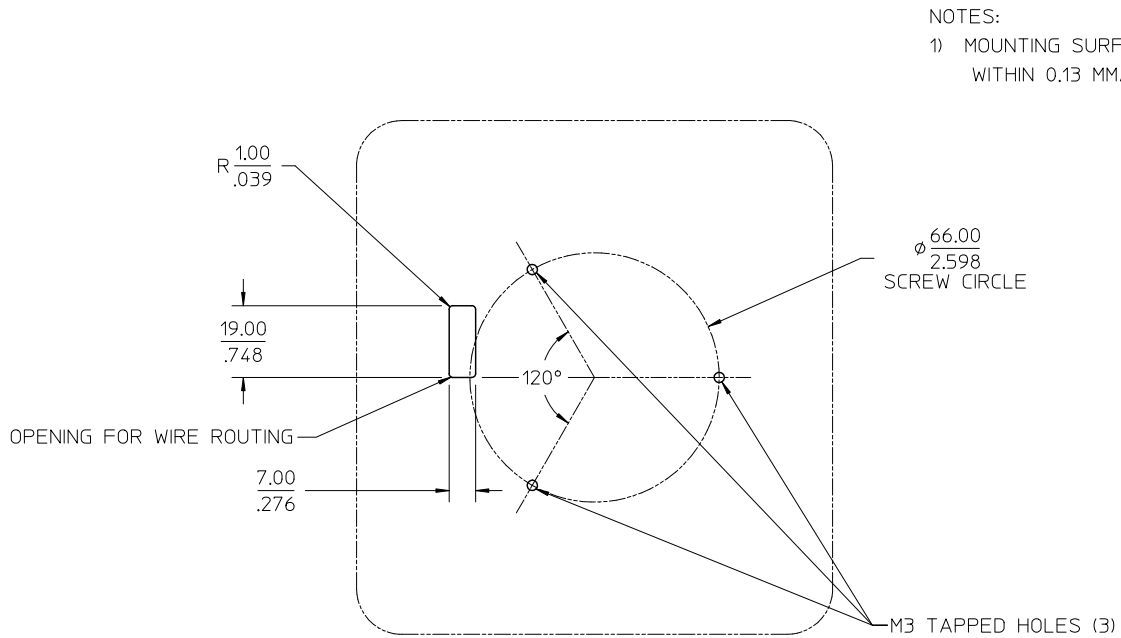

NOTES:
 1) MOUNTING SURFACE SHALL BE FLAT
 WITHIN 0.13 MM/.005 INCH.

RECOMMENDED MOUNTING DIMENSIONS

| | | | | | | | |
|---|-----------------|--|-----------------------|---|-------------|-----------------------------------|-------------------------------------|
| ENTER DESCRIPTION EC NO: SSL2011-0005 DRAWN:DMCGOWAN 2010/07/27 CHKD: 2010/08/10 APPR:DMCGOWAN 2010/08/10 DESCRIPTION REV A1 | QUALITY SYMBOLS | GENERAL TOLERANCES (UNLESS SPECIFIED) | | DIMENSION STYLE | SCALE | DESIGN UNITS | THIRD ANGLE PROJECTION |
| | $\nabla=0$ | mm | INCH | MM/IN | 1:1 | METRIC | <input checked="" type="checkbox"/> |
| | $\nabla=0$ | 4 PLACES ± --- ± --- | 3 PLACES ± --- ± .005 | DRAWN BY | DATE | TITLE | |
| | $\nabla=0$ | 2 PLACES ± 0.13 ± .01 | 1 PLACE ± 0.25 ± --- | MCGOWAN | 2010/02/08 | HELIEON 80MM SOCKET SALES DRAWING | |
| | | ANGULAR ± 1/2° | | CHECKED BY | DATE | APPROVED BY | |
| | | DRAFT WHERE APPLICABLE MUST REMAIN WITHIN DIMENSIONS | | DMCGOWAN | 2010/03/22 | DATE | |
| | | | | MATERIAL NO. | 180080-0000 | DOCUMENT NO. | |
| | | | | SIZE | B | MOLEX INCORPORATED | |
| | | | | THIS DRAWING CONTAINS INFORMATION THAT IS PROPRIETARY TO MOLEX INCORPORATED AND SHOULD NOT BE USED WITHOUT WRITTEN PERMISSION | | | |
| | | | | | | SHEET NO. | |
| | | | | | | 2 OF 3 | |

10 9 8 7 6 5 4 3 2 1

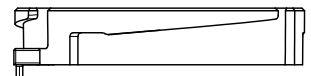
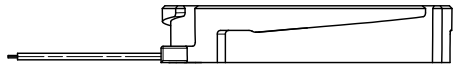
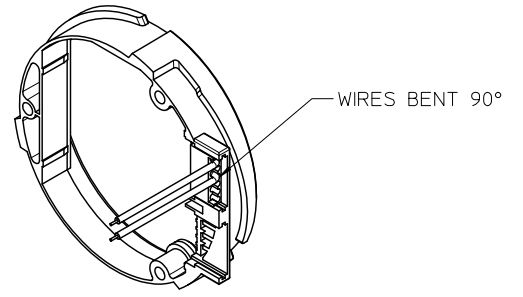
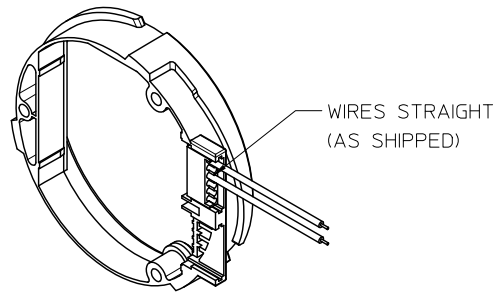

WIRES ROUTED STRAIGHT OUT

WIRES ROUTED DOWN

WIRE ROUTING OPTIONS

| | | | | | | | |
|---|-----------------------|--|-------------|-----------------|---|-----------------------------------|------------------------|
| ENTER DESCRIPTION EC NO: SSL2011-0005 DRAWN:DMCGOWAN 2010/07/27 CHKD: 2010/08/10 APPR:DMCGOWAN 2010/08/10 A1 | QUALITY SYMBOLS | GENERAL TOLERANCES (UNLESS SPECIFIED) | | DIMENSION STYLE | SCALE | DESIGN UNITS | THIRD ANGLE PROJECTION |
| | $\nabla=0$ | mm | INCH | MM/IN | 1:1 | METRIC | |
| | $\nabla=0$ | 4 PLACES ± --- ± --- | | DRAWN BY | DATE | TITLE | |
| | $\nabla=0$ | 3 PLACES ± --- ± .005 | | MCGOWAN | 2010/02/08 | HELIEON 80MM SOCKET SALES DRAWING | |
| | 2 PLACES ± 0.13 ± .01 | | CHECKED BY | DATE | MOLEX INCORPORATED DOCUMENT NO. SD-180080-000 SHEET NO. 3 OF 3 | | |
| | 1 PLACE ± 0.25 ± --- | | APPROVED BY | DATE | | | |
| | ANGULAR ± 1/2° | DRAFT WHERE APPLICABLE MUST REMAIN WITHIN DIMENSIONS | | MATERIAL NO. | THIS DRAWING CONTAINS INFORMATION THAT IS PROPRIETARY TO MOLEX INCORPORATED AND SHOULD NOT BE USED WITHOUT WRITTEN PERMISSION | | |
| | | | | 180080-0000 | | | |