

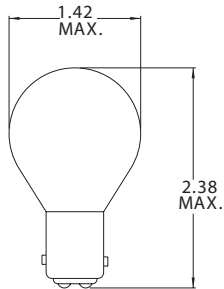

S-11 Double Contact Bayonet Base



Part Number	Design Voltage	Amps	MSCP	Life Hours	Filament Type
CM1724	6.2	4.50	32.0	400	C-6
CM310	28.0	.90	32.0	300	C-2V
CM312	28.0	1.29	50.0	300	C-2V

T-3/4 Wire Terminal

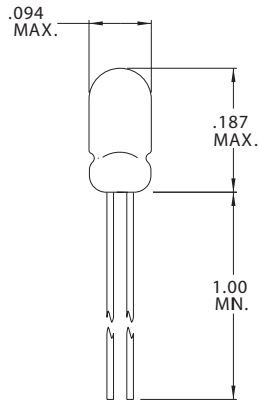

Part Number	Design Voltage	Amps	MSCP	Life Hours	Filament Type
CM7101	1.5	.015	.010	5,000	C-2R
CM28	4.5	.021	.020	5,000	C-2R
CM30	4.5	.021	.020	5,000	C-2R
CM3102	4.5	.022	.020	5,000	C-2R
CM2	5.0	.021	.030	10,000	C-2R
CM6153	5.0	.060	.150	3,000	C-2R
CM6803	5.0	.060	.030	60,000	C-2R
CM6833	5.0	.060	.050	25,000	C-2R
CM7102	5.0	.115	.200	5,000	C-2R
CM7133	5.0	.075	.090	25,000	C-2R
CM7153	5.0	.115	.150	40,000	C-2R
CM8537	5.0	.015	.020	1,000	C-2R
CM8666	5.0	.080	.150	15,000	C-2R

T-3/4 Micro-Midget Flange Base

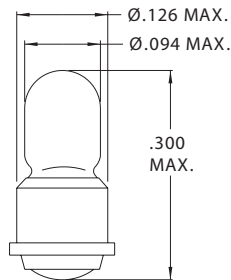

Part Number	Design Voltage	Amps	MSCP	Life Hours	Filament Type
CM3810	1.5	.015	.003	10,000	C-6
CM3811	1.5	.015	.010	5,000	C-6
CM7121	2.5	.110	.001	10,000	C-2R
CM6183	5.0	.060	.150	3,000	C-2
CM7122	5.0	.021	.030	10,000	C-2R
CM7123	5.0	.115	.200	5,000	C-2R
CM8270	5.0	.115	.150	40,000	C-2R

147 Central Avenue
Hackensack, NJ 07601
Phone: (201) 489-8989
Fax: (201) 489-6911

18703 Dix Toledo Road
Brownstown, MI 48193

Saret Zone Franca, Edificio B
Alajuela Costa Rica

E-mail: sales@chml.com • Web Site: www.chml.com

Chicago Miniature Lighting, LLC reserves the right to make specification revisions that enhance the design and/or performance of the product