

10 9 8 7 6 5 4 3 2 1

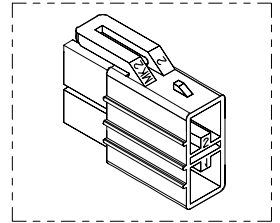

- NOTES
1. MATERIAL & COLOR : SEE TABLE
  2. MATCHED HOUSING : 35180-060\*
  3. APPLICABLE TERMINAL : 35748-0\*10
  4. APPLICABLE T.P.A : 35182-019\*

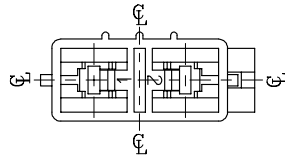
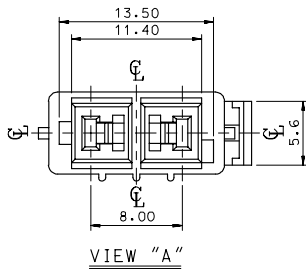
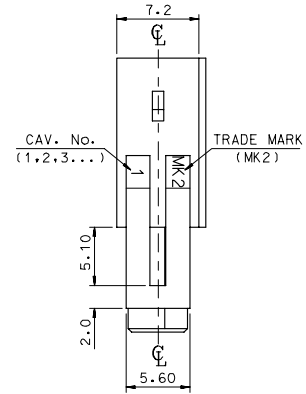
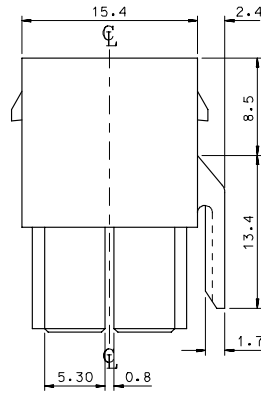
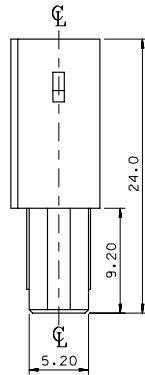

↑ "A"

NO	PRODUCT		MATERIAL	
	PART NO	MATERIAL NO	COLOR	DESCRIPTION
1	35181-0220	351810220	NATURAL	PBT (UL94V-0)
2	35181-0229	351810229	NATURAL	PBT/PC(UL94V-0)

REVISED EC NO: KOR2008-0048 2007/09/10 DRWN: JHPARK01 CHKD: W. YANG 2007/09/10 APPR: TUNSIKIM 2007/09/10	QUALITY SYMBOLS ▽=0 ▽=0	GENERAL TOLERANCES (UNLESS SPECIFIED)	DIMENSION STYLE		SCALE	DESIGN UNITS	THIRD ANGLE PROJECTION
			mm	INCH	3:1	METRIC	
REV B	DESCRIPTION	DRAFT WHERE APPLICABLE MUST REMAIN WITHIN DIMENSIONS	DRAWN BY		TITLE	.070 MULTI W/W CONN FEMALE HSG-2P(C)	MATERIAL NO.
			DATE	DATE			
			CHECKED BY				SD-35181-022*
			DATE				
			APPROVED BY				SHEET NO. 1 OF 01
			DATE				
			SIZE		THIS DRAWING CONTAINS INFORMATION THAT IS PROPRIETARY TO MOLEX INCORPORATED AND SHOULD NOT BE USED WITHOUT WRITTEN PERMISSION		
			A3				

9 8 7 6 5 4 3 2 1