

10 9 8 7 6 5 4 3 2 1

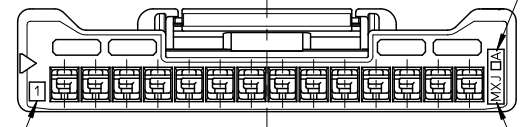
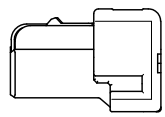
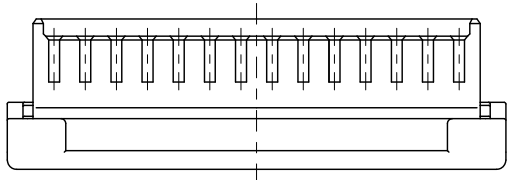
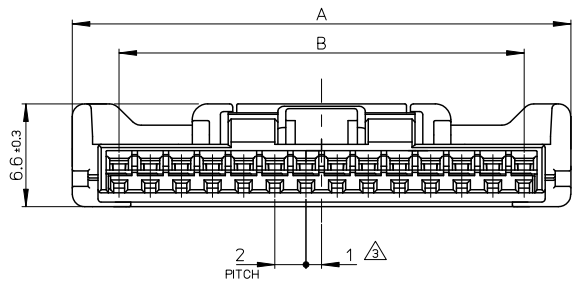
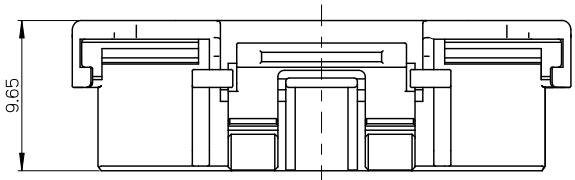

NOTES

- 適合ターミナル: 502438-0\*00  
APPLICABLE TERMINAL: 502438-0\*00
- △ 嵌合相手: 502443-\*\*70  
MATE WITH: 502443-\*\*70
- 極数 / 2 = 偶数に適用。  
APPLY FOR CKT. SIZE / 2 = EVEN.
- 本製品のプラスチック部に黒点等が確認される場合や色合いが異なる場合がありますが、製品性能に影響はありません。  
THERE IS NO INFLUENCE IN THE PRODUCT PERFORMANCE THOUGH THE BLACK SPOT ETC. MIGHT BE CONFIRMED TO THE PLASTIC PART OF THIS PRODUCT AND THE SHADE MIGHT BE DIFFERENT.
- アプリケーション仕様書 (コネクタ取扱説明書): AS-502439-001  
APPLICATION SPECIFICATIONS (CONNECTOR MANUAL): AS-502439-001
- 製品仕様書: PS-502443-001  
Product specification: PS-502443-001

28	34	502439-1500	15
26	32	502439-1400	14
24	30	502439-1300	13
22	28	502439-1200	12
18	24	502439-1000	10
14	20	502439-0800	8
10	16	502439-0600	6
8	14	502439-0500	5
6	12	502439-0400	4
B	A	製品番号	極数
		MATERIAL NO.	CKT. NO.

部品 PART	材質 MATERIAL
ハウジング HOUSING	ポリブチレンテレフタレート UL94V-0 色:白 POLYBUTYLENE TEREPHTHALATE UL94V-0 COLOR:WHITE

REVISED EC NO: J2011-0458 DRW:HKOBAYASHI 2010/09/28 CHKD:SAKIYAMA 2010/09/29 APPR:NIKIITA 2010/10/04	GENERAL TOLERANCES (UNLESS SPECIFIED)		DIMENSION STYLE MM ONLY	SCALE 4:1	DESIGN UNITS METRIC	THIRD ANGLE PROJECTION
	10 UNDER	±0.2	DRAWN BY NITO	DATE 2006/12/12	TITLE 2.0 W/B CONN. SINGLE PLUG HSG	
	10 OVER 30 UNDER	±0.25	CHECKED BY KASAKAWA	DATE 2006/12/12	MOLEX INCORPORATED	
	30 OVER	±0.3	APPROVED BY YOITO	DATE 2006/12/12	DOCUMENT NO. SD-502439-002	SHEET NO. 1 OF 1
	ANGULAR ±3 °	DRAFT WHERE APPLICABLE MUST REMAIN WITHIN DIMENSIONS	MATERIAL NO. SEE TABLE	THIS DRAWING CONTAINS INFORMATION THAT IS PROPRIETARY TO MOLEX INCORPORATED AND SHOULD NOT BE USED WITHOUT WRITTEN PERMISSION		

ib\_frame\_A3\_J\_ME\_S Rev. E 2006/04/15 9 8 7 6 5 4 3 2 1 EN-02JA(021)