

DWG. NO. SD-51103-020

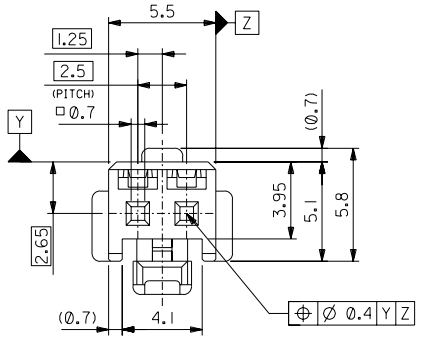
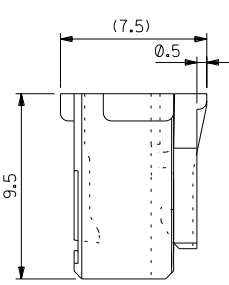
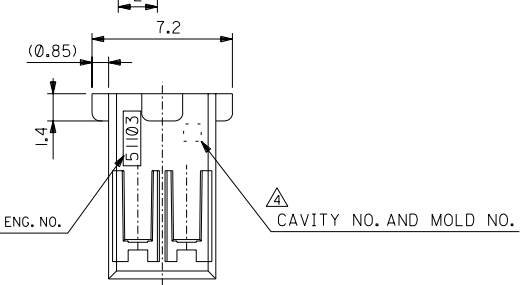
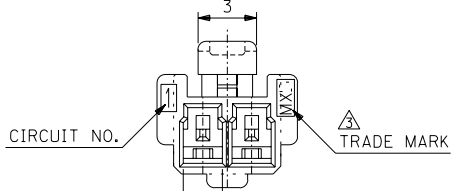

注記 NOTES

- △ 適合ターミナル：50351-8*00
APPLICABLE TERMINAL : 50351-8*00
- 2. 嵌合相手：53464 シリーズ
MATE WITH : 53464 SERIES.
- △ MXJと表示。
INDICATE MXJ.
- △ キャビティ番号：1桁～2桁の数字
金型番号：アルファベット1文字にて構成。(例. 1A, 10B)
FORMED BY 1 DIGIT TO 2 DIGIT NUMBERS (TO CAVITY NO.)
AND BY 1 LETTER OF ALPHABET (TO MOLD NO.).
(e.g. 1A, 10B)
- 5. 製品番号の末尾は製品の色を示す
LAST NUMBER OF DWG.NO. MEANS PART COLLER.

51103-**25
色番号
COLLER CODE
5 蛍光灰色 GRAY

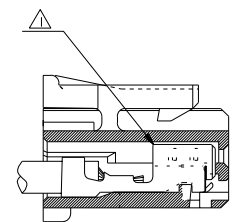

ターミナル装着状態図
TERMINAL ASSEMBLY DRAWING

51103-0225	2
MATERIAL NO.	NO. OF CIRCUIT

DIMENSIONS:	SHT	REV
<input type="checkbox"/> mm <input type="checkbox"/> INCH <input checked="" type="checkbox"/> mm ONLY	<input type="checkbox"/> INCH <input type="checkbox"/> mm	<input type="checkbox"/> CAD ONLY

GENERAL TOLERANCES: (UNLESS SPECIFIED) 一般公差	SCALE 5 : 1	DESIGN UNITS <input checked="" type="checkbox"/> mm <input type="checkbox"/> INCH	TITLE: 2.5 WIRE TO BOARD CONN. HOUSING (POSITIVE LOCK)
	10 UNDER 未満	DRAWN BY & DATE N.ITO '02/11/22	
	10 OVER 以上	CHECKED BY & DATE K.ASAKAWA '02/11/22	
30 UNDER 未満	APPROVED BY & DATE T.YAMAGUCHI '02/11/22	MATERIAL NO. DRAWING NO. SEE CHART SD-51103-020	
30 OVER 以上	ANGLE 角度	MATERIAL NO. DRAWING NO. SEE CHART SD-51103-020	

8	7	6	5	4	3	2	1	
ES4NO. DRWN: CHK: APPR:	ES3NO. DRWN: CHK: APPR:	ES2NO. DRWN: CHK: APPR:	ES1NO. DRWN: CHK: APPR:	RELEASED '02/11/22 DRWN: N.ITO CHK: K.ASAKAWA APPR: T.YAMAGUCHI	MATERIAL 材料 POLYBUTYLENE TEREPHTHALATE UL94V-0	FINISH 仕上げ	WIRE RANGE 適用電線範囲	INS. RANGE 被覆外径

DO NOT SCALE DRAWING

EN-02J(097) MXJ-54

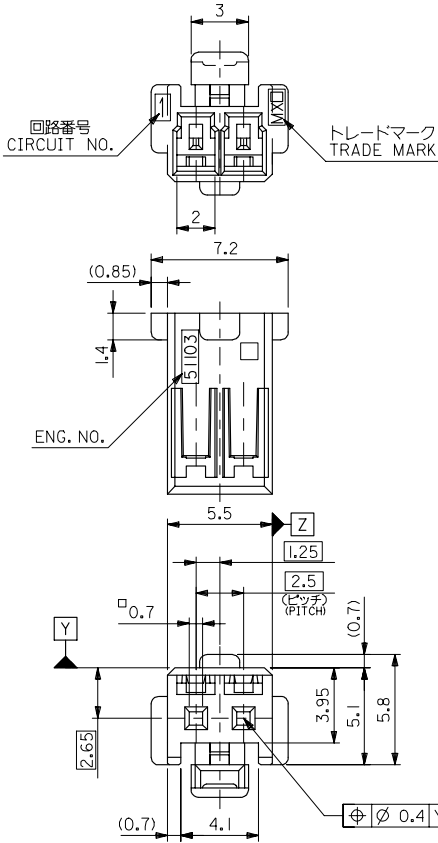

注記 NOTES

- △ 適合ターミナル : 50351-8*00
APPLICABLE TERMINAL : 50351-8*00
2. 嵌合相手 : 53375,53426 シリーズ
MATE WITH : 53375,53426 SERIES
- △ 偶数極の製品に適用。
APPLY EVEN CIRCUIT PRODUCTS.
4. 製品型番の下1桁は色を表す。
LAST DIGIT OF PART NUMBER INDICATES COLOR.
0 : 白 WHITE 1 : 黒 BLACK 2 : 赤 RED
3 : 黄 YELLOW 4 : 青 BLUE

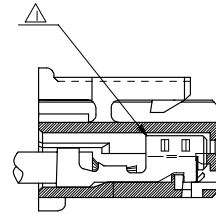

ターミナル装着状態図
TERMINAL ASSEMBLY DRAWING

2極に適用
FOR 2 CKTS.

51103-020*	2
MATERIAL NO.	CIRCUIT

RELEASED IEC NO. J2005-2009 DRAWN MUMEDA 2005/02/02 CHKD KTOYODA 2005/02/04 APPR NIKITA 2005/02/14 REV 0	GENERAL TOLERANCES (UNLESS SPECIFIED)		DIMENSION STYLE MM ONLY		SCALE ---	DESIGN UNITS METRIC	THIRD ANGLE PROJECTION
	10 UNDER	±0.2	DRAWN BY M.UMEDA	DATE 2005/01/14	TITLE 2.5 W/B CONN. HOUSING (POSITIVE LOCK)		
	10 OVER 30 UNDER	±0.25	CHECKED BY K.TOYODA	DATE 2005/01/14	MOLEX INCORPORATED		
	30 OVER	±0.3	APPROVED BY N.UKITA	DATE 2005/01/14	DOCUMENT NO. SD-51103-021		
	ANGULAR	±3 °	MATERIAL NO. SEE CHART		SHEET NO. 1 OF 2		
DRAFT WHERE APPLICABLE MUST REMAIN WITHIN DIMENSIONS			SIZE A3		THIS DRAWING CONTAINS INFORMATION THAT IS PROPRIETARY TO MOLEX INCORPORATED AND SHOULD NOT BE USED WITHOUT WRITTEN PERMISSION		

10 9 8 7 6 5 4 3 2 1

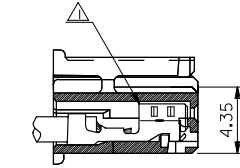
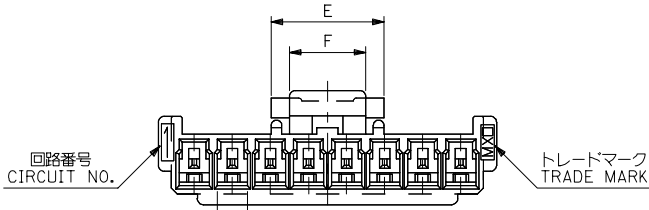

ターミナル装着状態図
TERMINAL ASSEMBLY DRAWING

注記 NOTES

- △ 適合ターミナル : 50351-8*00
APPLICABLE TERMINAL : 50351-8*00
- 2. 嵌合相手 : 53375,53426 シリーズ
MATE WITH : 53375,53426 SERIES
- △ 偶数極の製品に適用。
APPLY EVEN CIRCUIT PRODUCTS.
- 4. 製品型番の下1桁は色を表す。
LAST DIGIT OF PART NUMBER INDICATES COLOR.
0 : 白 WHITE 1 : 黒 BLACK 2 : 赤 RED
3 : 黄 YELLOW 4 : 青 BLUE

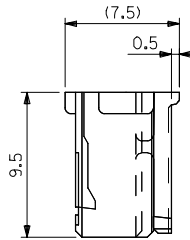
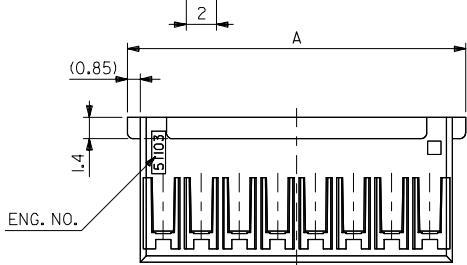

3-15 極に適用
FOR 3-15 CKTS.

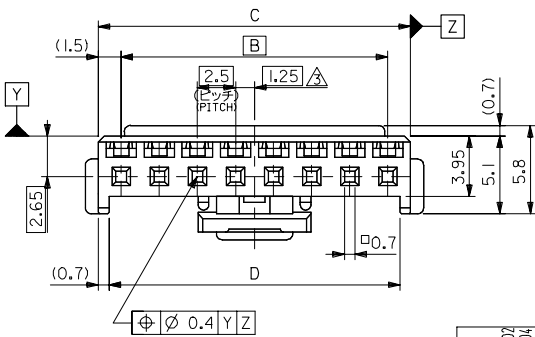

5	7.4	36.6	38	35	39.7	51103-150*	15
↑	↑	34.1	35.5	32.5	37.2	↑ -140*	14
		31.6	33	30	34.7	-130*	13
		29.1	30.5	27.5	32.2	-120*	12
		26.6	28	25	29.7	-110*	11
		24.1	25.5	22.5	27.2	-100*	10
		21.6	23	20	24.7	-090*	9
		19.1	20.5	17.5	22.2	-080*	8
		16.6	18	15	19.7	-070*	7
		14.1	15.5	12.5	17.2	-060*	6
↓	↓	11.6	13	10	14.7	-050*	5
5	7.4	9.1	10.5	7.5	12.2	↓ -040*	4
3	5	6.6	8	5	9.7	51103-030*	3
F	E	D	C	B	A	MATERIAL NO.	CIRCUIT

RELEASED IEC NO. J2005-2009 2005/02/02 DRAWN/MIMEDA 2005/02/04 CHKD/KTOYODA 2005/02/14 APPR/NUKITA	GENERAL TOLERANCES (UNLESS SPECIFIED)		DIMENSION STYLE MM ONLY		SCALE ---	DESIGN UNITS METRIC	THIRD ANGLE PROJECTION
	10 UNDER	±0.2	DRAWN BY M.UMEDA	DATE 2005/01/14	TITLE 2.5 W/B CONN. HOUSING (POSITIVE LOCK)		
	10 OVER 30 UNDER	±0.25	CHECKED BY KTOYODA	DATE 2005/01/14	MATERIAL NO.		
	30 OVER	±0.3	APPROVED BY N.UKITA	DATE 2005/01/14	DOCUMENT NO. SD-51103-021		
	ANGULAR	±3 °	DRAFT WHERE APPLICABLE MUST REMAIN WITHIN DIMENSIONS		SEE CHART	SHEET NO. 2 OF 2	

10 9 8 7 6 5 4 3 2 1

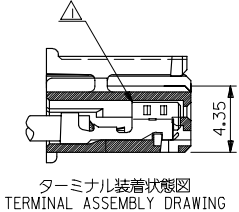
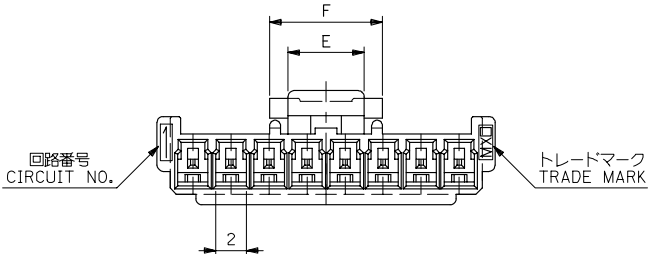

注記 NOTES
 △ 適合ターミナル：50351-8*00
 APPLICABLE TERMINAL：50351-8*00
 2. 嵌合相手：53375,53376,53388,53389
 53426 シリーズ
 MATE WITH：53375,53376,53388,53389
 53426 SERIES
 △ 偶数極の製品に適用。
 APPLY EVEN CIRCUIT PRODUCTS.

3-15 極に適用
 FOR 3-15 CKTS.

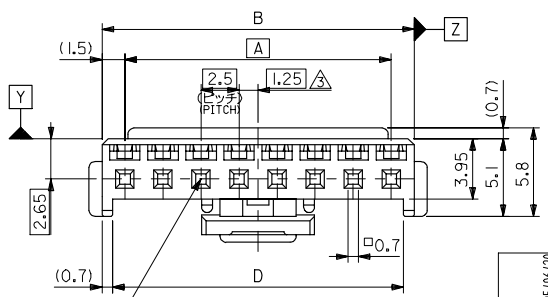
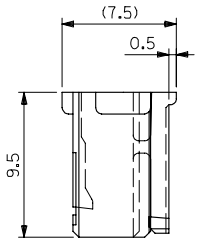
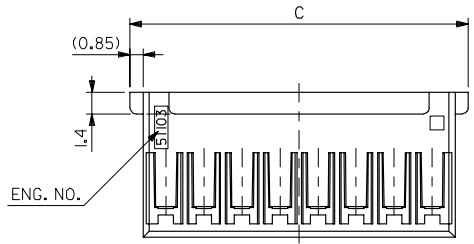

7.4	5	36.6	39.7	38	35	51103-1500	15
↑	↑	34.1	37.2	35.5	32.5	-1400	14
		31.6	34.7	33	30	-1300	13
		29.1	32.2	30.5	27.5	-1200	12
		26.6	29.7	28	25	-1100	11
		24.1	27.2	25.5	22.5	-1000	10
		21.6	24.7	23	20	-0900	9
		19.1	22.2	20.5	17.5	-0800	8
		16.6	19.7	18	15	-0700	7
		14.1	17.2	15.5	12.5	-0600	6
		11.6	14.7	13	10	-0500	5
7.4	5	9.1	12.2	10.5	7.5	-0400	4
5	3	6.6	9.7	8	5	51103-0300	3
F	E	D	C	B	A	MATERIAL NO.	極数 No. of C&T

材料 MATERIAL
 PBTP, UL94V-0
 (色 WHITE)
 仕上り FINISH
 適用導線範囲 WIRE RANGE
 挿入径 INS. RANGE

REVISED EC NO.: J2005-3799 DRAWN: HIRAMOTO CHKD: KATOYODA APPR: NUKITA	GENERAL TOLERANCES (UNLESS SPECIFIED)		DIMENSION STYLE MM ONLY		SCALE 4:1	DESIGN UNITS METRIC	THIRD ANGLE PROJECTION
	10 UNDER	±0.2	DRAWN BY T. ITO	DATE '92/05/06	TITLE 2.5 WIRE TO BOARD CONN HOUSING (POSITIVE LOCK)		
	10 OVER 30 UNDER	±0.25	CHECKED BY H. HIRAMOTO	DATE '95/10/03			
	30 OVER	±0.3	APPROVED BY M. FUKUSHIMA	DATE '95/10/03			
ANGULAR ±3 °		DRAFT WHERE APPLICABLE MUST REMAIN WITHIN DIMENSIONS		MATERIAL NO. SEE CHART	DOCUMENT NO. SD-51103-023	MOLEX INCORPORATED	
				SIZE A3	THIS DRAWING CONTAINS INFORMATION THAT IS PROPRIETARY TO MOLEX INCORPORATED AND SHOULD NOT BE USED WITHOUT WRITTEN PERMISSION		

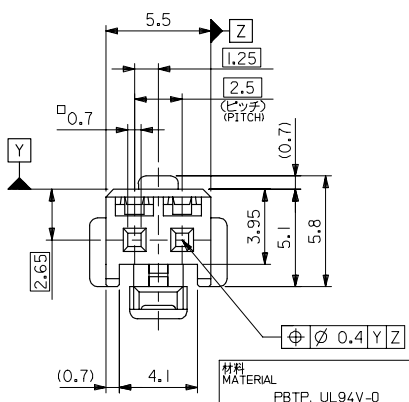
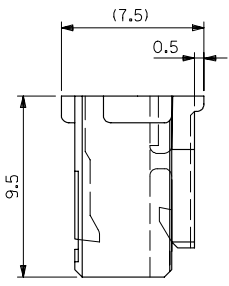
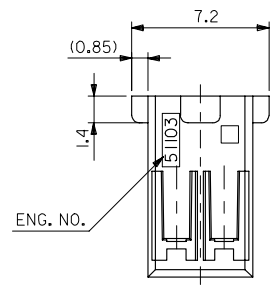
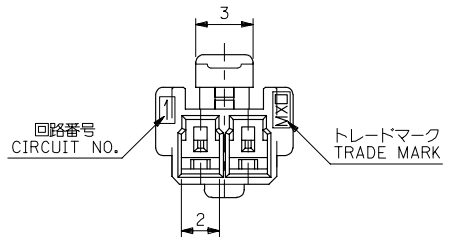

注記 NOTES

- △ 適合ターミナル：5035I-8*00
APPLICABLE TERMINAL : 5035I-8*00
- 2. 嵌合相手：53375,53426 シリーズ
MATE WITH : 53375,53426 SERIES

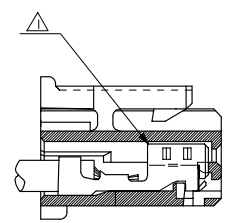

ターミナル装着状態図
TERMINAL ASSEMBLY DRAWING

2極に適用
FOR 2 CKTS.

51103-0200	2
MATERIAL NO.	NO. OF CKTS.
◎ THIRD ANGLE PROJECTION	

材料 MATERIAL	PBTP, UL94V-0 (白色 WHITE)
仕上げ FINISH	—
適用導線範囲 WIRE RANGE	—
挿入外径 INS. RANGE	—

REVISED EC NO. J2005-3799 DRAWN: HABEI 2005/06/20 CHKD: KUYODA 2005/06/21 APPR: NUKITA 2005/06/27	GENERAL TOLERANCES (UNLESS SPECIFIED)		DIMENSION STYLE MM ONLY		SCALE 5:1	DESIGN UNITS METRIC	TITLE 2.5 WIRE TO BOARD CONN HOUSING (POSITIVE LOCK)
	10 UNDER	±0.2	DRAWN BY T. ITO	DATE '92/05/06	MATERIAL NO.		
	10 OVER 30 UNDER	±0.25	CHECKED BY H. HIRAMOTO	DATE '95/10/03	DOCUMENT NO. SD-51103-023		
	30 OVER	±0.3	APPROVED BY M. FUKUSHIMA	DATE '95/10/03	SHEET NO. 2 OF 2		
	ANGULAR ±3 °	DRAFT WHERE APPLICABLE MUST REMAIN WITHIN DIMENSIONS		SEE CHART		MATERIAL NO.	
				SIZE A3		THIS DRAWING CONTAINS INFORMATION THAT IS PROPRIETARY TO MOLEX INCORPORATED AND SHOULD NOT BE USED WITHOUT WRITTEN PERMISSION	