

THIS DRAWING IS UNPUBLISHED  
 ALL RIGHTS RESERVED

REV	DATE	DESCRIPTION	BY	CHK	APP
CM 00					
R1		REVISED PER EDD-11-004917	11MMR11	RK	HMR

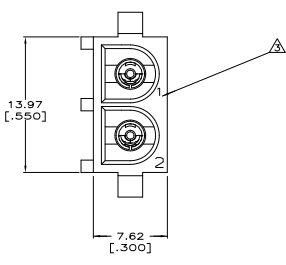

- PARTS COMPLY TO AMP SOLDERABILITY SPECIFICATION 109-11-3.
- CONTACT IS PLATED OVERALL WITH 0.00127 [.000050] NICKEL, THEN 0.00076 [.000030] GOLD OVER CONTACT LENGTH INDICATED AND MATTE TIN LEAD ON SOLDER TAIL END.
- CIRCUIT IDENTIFICATION CHARACTERS ARE ADJACENT TO THE INDICATED CAVITIES, BUT LOCATION AND ORIENTATION MAY DIFFER FROM PRINT.
- DIMENSIONS IN BRACKETS ARE IN INCHES.
- CONTACT IS PLATED OVERALL WITH 0.00127 [.000050] NICKEL, THEN 0.00076 [.000030] GOLD OVER CONTACT LENGTH INDICATED AND MATTE TIN ON SOLDER TAIL END.

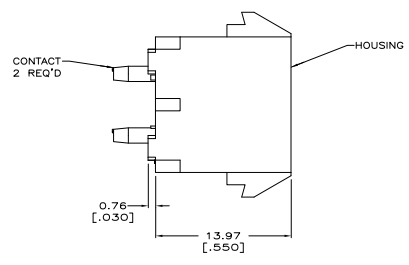
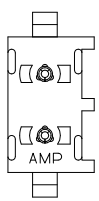
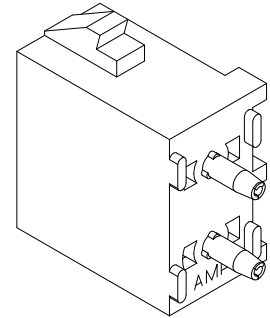

3-DIMENSIONAL MODEL  
 NTS

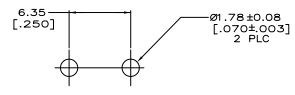
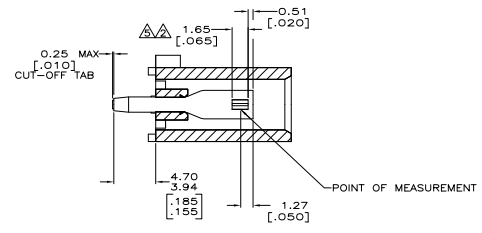

RECOMMENDED MOUNTING HOLE PATTERN  
 FOR 1.57 [.062] THICK P.C. BOARD

PHOSPHOR BRONZE, GOLD	NYLON,UL94V-2,NATURAL	350759-5
PHOSPHOR BRONZE, PRE-TIN	NYLON,UL94V-2,NATURAL	350759-4
PHOSPHOR BRONZE, GOLD	NYLON,UL94V-2,NATURAL	350759-3
CONTACT MATERIAL AND FINISH	HOUSING MATERIAL	PART NUMBER



THIS DRAWING IS A CONTROLLED DOCUMENT:		DATE	BY	CHK	APP
DESIGNED	BY	DATE	BY	CHK	APP
DRAWN	BY	DATE	BY	CHK	APP
CHECKED	BY	DATE	BY	CHK	APP
APPROVED	BY	DATE	BY	CHK	APP

TE Connectivity  
 SOCKET HEADER ASSEMBLY,  
 2 CIRCUIT,  
 UNIVERSAL MATE-IN-LOCK(TM)

SIZE: A1 00779 ©=350759

CUSTOMER DRAWING