

4

3

2

1

THIS DRAWING IS UNPUBLISHED. RELEASED FOR PUBLICATION.  
 © COPYRIGHT BY TYCO ELECTRONICS CORPORATION. ALL RIGHTS RESERVED.

LOC	DIST	REVISIONS					
CM	00	F	LR	DESCRIPTION	DATE	BY	APPD
		Y		ECO-07-012870	14/JUN/07	KW	DB
		Y1		REVISED PER ECO-09-022908	08/OCT/09	KK	AEG

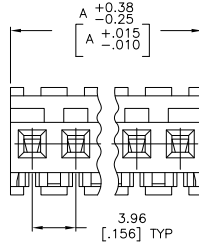
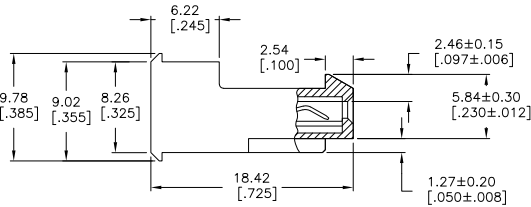
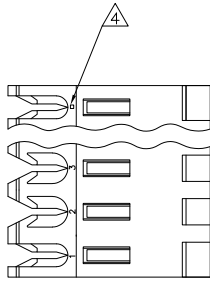

- △ MATERIAL: CONNECTOR - NYLON UL94V-2 (ORANGE).  
CONTACTS - 0.00076 [0.00030] GOLD IN CONTACT AREA WITH BRIGHT TIN-LEAD FOR -2 THRU -28, MATTE WHISKER MITIGATED TIN FOR 3-641227-2 THRU 5-641227-4 OVER NICKEL UNDERPLATE.

- 2. CONTACTS ACCEPT 18 AWG WIRE WITH 2.41[.095] MAX INSULATION DIAMETER.
- 3. CONTACTS MUST ACCEPT 1.14±0.03 [.045±.001] SQUARE POST AND REMAIN LOCKED IN POSITION.
- △ IDENTIFICATION NUMBER FOR LAST CIRCUIT MAY NOT APPEAR ON ALL ASSEMBLIES.
- 5. DIMENSIONS IN BRACKETS ARE IN INCHES.
- 6. HOUSING FEATURES ARE: FEED-THRU WITH LOCKING RAMP.
- △ OBSOLETE PARTS: OBSOLETE CIS STREAMLINING PER D.RENAUD/D.SINISI

95.10	[3.744]	24	5-641227-4
91.14	[3.588]	23	5-641227-3
87.17	[3.432]	22	5-641227-2
83.21	[3.276]	21	5-641227-1
79.25	[3.120]	20	5-641227-0
75.29	[2.964]	19	4-641227-9
71.32	[2.808]	18	4-641227-8
67.36	[2.652]	17	4-641227-7
63.40	[2.496]	16	4-641227-6
59.44	[2.340]	15	4-641227-5
55.47	[2.184]	14	4-641227-4
51.51	[2.028]	13	4-641227-3
47.55	[1.872]	12	4-641227-2
43.59	[1.716]	11	4-641227-1
39.62	[1.560]	10	4-641227-0
35.66	[1.404]	9	3-641227-9
31.70	[1.248]	8	3-641227-8
27.74	[1.092]	7	3-641227-7
23.77	[.936]	6	3-641227-6
19.81	[.780]	5	3-641227-5
15.85	[.624]	4	3-641227-4
11.89	[.468]	3	3-641227-3
7.92	[.312]	2	3-641227-2
95.10	[3.744]	24	2-641227-4
91.14	[3.588]	23	2-641227-3
87.17	[3.432]	22	2-641227-2
83.21	[3.276]	21	2-641227-1
79.25	[3.120]	20	2-641227-0
75.29	[2.964]	19	1-641227-9
71.32	[2.808]	18	1-641227-8
67.36	[2.652]	17	1-641227-7
63.40	[2.496]	16	1-641227-6
59.44	[2.340]	15	1-641227-5
55.47	[2.184]	14	1-641227-4
51.51	[2.028]	13	1-641227-3
47.55	[1.872]	12	1-641227-2
43.59	[1.716]	11	1-641227-1
39.62	[1.560]	10	1-641227-0
35.66	[1.404]	9	641227-9
31.70	[1.248]	8	641227-8
27.74	[1.092]	7	641227-7
23.77	[.936]	6	641227-6
19.81	[.780]	5	641227-5
15.85	[.624]	4	641227-4
11.89	[.468]	3	641227-3
7.92	[.312]	2	641227-2

SUPERCEDED  
 △ SUPERCEDED  
 △ SUPERCEDED  
 △ SUPERCEDED



THIS DRAWING IS A CONTROLLED DOCUMENT.

DIMENSIONS: mm [INCHES]	TOLERANCES UNLESS OTHERWISE SPECIFIED:	0 PLG ± .010	1 PLG ± .010	2 PLG ± .010	3 PLG ± .010	4 PLG ± .010	ANGLES ± .010	FINISH

DATE: 12 FEB 91  
 CHK: S. LEWIS  
 DATE: 20 FEB 91  
 D. CLARK  
 PRODUCT SPEC: 108-1051  
 APPLICATION SPEC: 114-1020  
 WEIGHT: -

TYCO Electronics Corporation  
 Harrisburg, Pa 17105-3608

MTA-156 CONNECTOR ASSEMBLY,  
 18 AWG, STANDARD

SIZE: CASE CODE: DRAWING NO: A2 00779 C-641227  
 RESTRICTED TO: -

CUSTOMER DRAWING SCALE: 4:1 SHEET: 1 OF 1 REV: Y1

AMP 1471-9 REV 31MM2000

641227