

4

3

2

1

THIS DRAWING IS UNPUBLISHED. RELEASED FOR PUBLICATION  
 © COPYRIGHT - By - ALL RIGHTS RESERVED.

LOC	DIST	REVISIONS			
F	LNK	DESCRIPTION	DATE	BY	APPD
CM	00	P2	REVISED PER ECO-11-004917	11MAR11	RK HMR

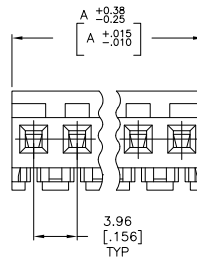
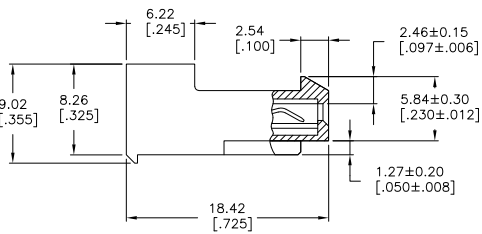
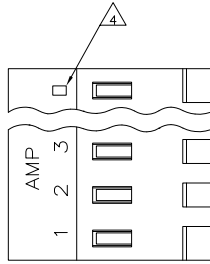

95.10	[3.744]	24	5-641218-4
91.14	[3.588]	23	5-641218-3
87.17	[3.432]	22	5-641218-2
83.21	[3.276]	21	5-641218-1
79.25	[3.120]	20	5-641218-0
75.29	[2.964]	19	4-641218-9
71.32	[2.808]	18	4-641218-8
67.36	[2.652]	17	4-641218-7
63.40	[2.496]	16	4-641218-6
59.44	[2.340]	15	4-641218-5
55.47	[2.184]	14	4-641218-4
51.51	[2.028]	13	4-641218-3
47.55	[1.872]	12	4-641218-2
43.59	[1.716]	11	4-641218-1
39.62	[1.560]	10	4-641218-0
35.66	[1.404]	9	3-641218-9
31.70	[1.248]	8	3-641218-8
27.74	[1.092]	7	3-641218-7
23.77	[.936]	6	3-641218-6
19.81	[.780]	5	3-641218-5
15.85	[.624]	4	3-641218-4
11.89	[.468]	3	3-641218-3
7.92	[.312]	2	3-641218-2
95.10	[3.744]	24	2-641218-4
91.14	[3.588]	23	2-641218-3
87.17	[3.432]	22	2-641218-2
83.21	[3.276]	21	2-641218-1
79.25	[3.120]	20	2-641218-0
75.29	[2.964]	19	1-641218-9
71.32	[2.808]	18	1-641218-8
67.36	[2.652]	17	1-641218-7
63.40	[2.496]	16	1-641218-6
59.44	[2.340]	15	1-641218-5
55.47	[2.184]	14	1-641218-4
51.51	[2.028]	13	1-641218-3
47.55	[1.872]	12	1-641218-2
43.59	[1.716]	11	1-641218-1
39.62	[1.560]	10	1-641218-0
35.66	[1.404]	9	641218-9
31.70	[1.248]	8	641218-8
27.74	[1.092]	7	641218-7
23.77	[.936]	6	641218-6
19.81	[.780]	5	641218-5
15.85	[.624]	4	641218-4
11.89	[.468]	3	641218-3
7.92	[.312]	2	641218-2

△ SUPERCEDED BY 5-641218-4	95.10	[3.744]	24	2-641218-4
△ SUPERCEDED BY 5-641218-3	91.14	[3.588]	23	2-641218-3
△ SUPERCEDED BY 5-641218-2	87.17	[3.432]	22	2-641218-2
△ SUPERCEDED BY 5-641218-1	83.21	[3.276]	21	2-641218-1
△ SUPERCEDED BY 5-641218-0	79.25	[3.120]	20	2-641218-0
△ SUPERCEDED BY 4-641218-9	75.29	[2.964]	19	1-641218-9
△ SUPERCEDED BY 4-641218-8	71.32	[2.808]	18	1-641218-8
△ SUPERCEDED BY 4-641218-7	67.36	[2.652]	17	1-641218-7
△ SUPERCEDED BY 4-641218-6	63.40	[2.496]	16	1-641218-6
△ SUPERCEDED BY 4-641218-5	59.44	[2.340]	15	1-641218-5
△ SUPERCEDED BY 4-641218-4	55.47	[2.184]	14	1-641218-4
△ SUPERCEDED BY 4-641218-3	51.51	[2.028]	13	1-641218-3
△ SUPERCEDED BY 4-641218-2	47.55	[1.872]	12	1-641218-2
△ SUPERCEDED BY 4-641218-1	43.59	[1.716]	11	1-641218-1
△ SUPERCEDED BY 3-641218-9	39.62	[1.560]	10	641218-9
△ SUPERCEDED BY 3-641218-8	35.66	[1.404]	9	641218-8
△ SUPERCEDED BY 3-641218-7	31.70	[1.248]	8	641218-7
△ SUPERCEDED BY 3-641218-6	27.74	[1.092]	7	641218-6
△ SUPERCEDED BY 3-641218-5	23.77	[.936]	6	641218-5
△ SUPERCEDED BY 3-641218-4	19.81	[.780]	5	641218-4
△ SUPERCEDED BY 3-641218-3	15.85	[.624]	4	641218-3
△ SUPERCEDED BY 3-641218-2	11.89	[.468]	3	641218-2
△ SUPERCEDED BY 3-641218-1	7.92	[.312]	2	641218-1

△ MATERIAL: CONNECTOR - NYLON UL94V-2 (YELLOW).  
 CONTACTS - 0.00076 [.000030] GOLD IN CONTACT AREA WITH BRIGHT TIN-LEAD FOR 641218-2 THRU 2-641218-4, MATTIE WHISKER MITIGATED TIN FOR 3-641218-2 THRU 5-641218-4 OVER NICKEL UNDERPLATE.

- CONTACTS ACCEPT 20 AWG WIRE WITH 2.41[.095] MAX INSULATION DIAMETER.
- CONTACTS MUST ACCEPT 1.14±0.03 [.045±.001] SQUARE POST AND REMAIN LOCKED IN POSITION.
- IDENTIFICATION NUMBER FOR LAST CIRCUIT MAY NOT APPEAR ON ALL ASSEMBLIES.
- DIMENSIONS IN BRACKETS ARE IN INCHES.
- HOUSING FEATURES ARE: CLOSED END WITH LOCKING RAMP.
- OBsolete PARTS: OBsolete CIS STREAMLINING PER D.RENAUD/D.SINISI



THIS DRAWING IS A CONTROLLED DOCUMENT.

DIMENSIONS: mm [INCHES]	DESIGNER: S. LEWIS 12 FEB 91	CHK: SWING 12 FEB 91	DATE: 20 FEB 91
0 PLG - - -	APPD: D. CLARK	PRODUCT SPEC: 108-1051	SIZE: A2
1 PLG - - -	APPLICATION SPEC: 114-1020	WEIGHT: -	CASE CODE: 00779
2 PLG - - -	REVISIONS: -	RESTRICTED TO: -	DRAWING NO: 641218
3 PLG - - -	SCALE: 4:1	SHEET: 1 of 1	REV: P2
4 PLG - - -	CUSTOMER DRAWING		

TE Connectivity  
 MTA-156 CONNECTOR ASSEMBLY, 20 AWG, STANDARD