

4

3

2

1

THIS DRAWING IS UNPUBLISHED. RELEASED FOR PUBLICATION. ALL RIGHTS RESERVED.

LOC	DIST	REVISIONS					
CM	0	F	LWR	DESCRIPTION	DATE	MIN	APD
		M2		REVISED PER ECO-11-005027	12MAR11	RK	HMR

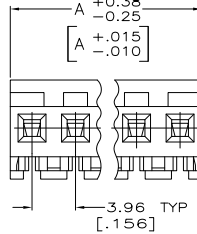
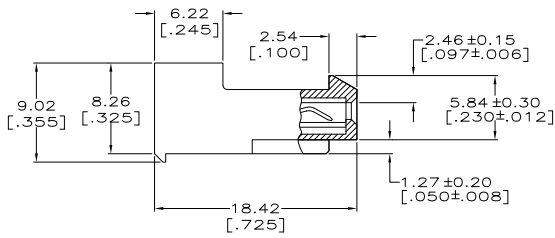
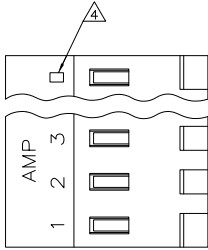

- MATERIAL:**  
CONNECTOR - NYLON UL94V-2 (ORANGE).  
CONTACTS - 0.30[.012] THICK COPPER ALLOY.  
PLATING - 0.00038[.000015] GOLD IN CONTACT AREA.  
0.00203[.000080] MIN THICKNESS BRIGHT TIN LEAD IN SLOT AREA FOR 641148-2 THRU 2-641148-4 OR MATTE WHISKER MITIGATED TIN IN SLOT AREA FOR 3-641148-2 THRU 5-641148-4 OVER NICKEL UNDERPLATE.
- CONTACTS ACCEPT 18 AWG WIRE WITH 2.41[.095] MAX INSULATION DIAMETER.
  - CONTACTS MUST ACCEPT 1.14±0.03[.045±.001] SQUARE POST AND REMAIN LOCKED IN POSITION.
- IDENTIFICATION NUMBER FOR LAST CIRCUIT MAY NOT APPEAR ON ALL ASSEMBLIES.**
- DIMENSIONS IN BRACKETS ARE IN INCHES.
  - HOUSING FEATURES ARE: CLOSED END WITH LOCKING RAMP.
- NOTE DELETED.**
- NOTE DELETED.**
- OBsolete PARTS: OBsolete CIS STREAMLINING PER D.RENAUD/D.SINISI**

**METRIC**

TIN	95.10	[3.744]	24	5-641148-4
	91.14	[3.588]	23	5-641148-3
	87.17	[3.432]	22	5-641148-2
	83.21	[3.276]	21	5-641148-1
	79.25	[3.120]	20	5-641148-0
	75.29	[2.964]	19	4-641148-9
	71.32	[2.808]	18	4-641148-8
	67.36	[2.652]	17	4-641148-7
	63.40	[2.496]	16	4-641148-6
	59.44	[2.340]	15	4-641148-5
	55.47	[2.184]	14	4-641148-4
	51.51	[2.028]	13	4-641148-3
	47.55	[1.872]	12	4-641148-2
	43.59	[1.716]	11	4-641148-1
	39.62	[1.560]	10	4-641148-0
	35.66	[1.404]	9	3-641148-9
	31.70	[1.248]	8	3-641148-8
	27.74	[1.092]	7	3-641148-7
	23.77	[.936]	6	3-641148-6
	19.81	[.780]	5	3-641148-5
	15.85	[.624]	4	3-641148-4
	11.89	[.468]	3	3-641148-3
	7.92	[.312]	2	3-641148-2
TIN-LEAD	95.10	[3.744]	24	2-641148-4
	91.14	[3.588]	23	2-641148-3
	87.17	[3.432]	22	2-641148-2
	83.21	[3.276]	21	2-641148-1
	79.25	[3.120]	20	2-641148-0
	75.29	[2.964]	19	1-641148-9
	71.32	[2.808]	18	1-641148-8
	67.36	[2.652]	17	1-641148-7
	63.40	[2.496]	16	1-641148-6
	59.44	[2.340]	15	1-641148-5
	55.47	[2.184]	14	1-641148-4
	51.51	[2.028]	13	1-641148-3
	47.55	[1.872]	12	1-641148-2
	43.59	[1.716]	11	1-641148-1
	39.62	[1.560]	10	1-641148-0
	35.66	[1.404]	9	641148-9
	31.70	[1.248]	8	641148-8
	27.74	[1.092]	7	641148-7
	23.77	[.936]	6	641148-6
	19.81	[.780]	5	641148-5
	15.85	[.624]	4	641148-4
	11.89	[.468]	3	641148-3
	7.92	[.312]	2	641148-2
CONTACT FINISH	DIM A		NO. OF CIRCUITS	PART NO.

THIS DRAWING IS A CONTROLLED DOCUMENT.

DIMENSIONS: mm [INCHES]	2-12-91	TE Connectivity
TOLERANCES UNLESS OTHERWISE SPECIFIED:	2-12-91	TE Connectivity
0 PLG ± -	108-1051	MTA-156 CONNECTOR ASSEMBLY, 18 AWG, STANDARD
1 PLG ± -	APPLICATION SPEC	114-1020
2 PLG ± -	SIZE CASE CODE DRAWING NO	A2 00779 C-641148
3 PLG ± 0.13 [0.05]	RESTRICTED TO	
4 PLG ± -		
ANGLES ± -		
FINISH		

CUSTOMER DRAWING SCALE 4:1 SHEET 1 of 1 REV M2