

THIS DRAWING IS UNPUBLISHED  
 ALL RIGHTS RESERVED  
 © 2005 TTI ELECTRONICS CORPORATION

REV	DATE	DESCRIPTION	BY	CHK	APP
E	27FEB07	REVISED PER ECO-07-003747	KW	DB	
E1	13OCT09	REVISED PER ECO-09-003515	KK	AEG	

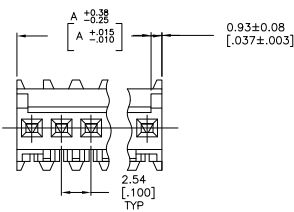
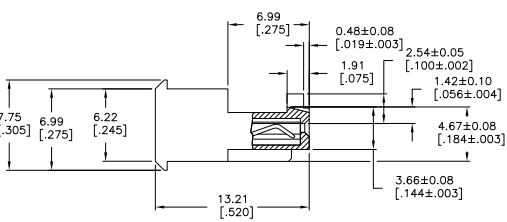
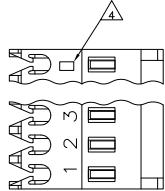

- MATERIAL: CONNECTOR-NYLON UL94V-2 (BLUE).  
 CONTACTS-0.30 [.012] THICK COPPER ALLOY  
 0.00076 [.000030] GOLD IN CONTACT AREA  
 WITH BRIGHT TIN-LEAD FOR 644726-2 THRU  
 1-644726-5, MATTE WHISKER MITIGATED TIN  
 FOR 3-644726-2 THRU 4-644726-5 OVER  
 NICKEL UNDERPLATE.
- CONTACTS ACCEPT 26 AWG WIRE WITH 1.52 [.060] MAX  
 INSULATION DIAMETER.
- CONTACTS MUST ACCEPT 0.64±0.03 [.025±.001] SQUARE  
 POST AND REMAIN LOCKED IN POSITION.
- IDENTIFICATION NUMBER FOR LAST CIRCUIT MAY  
 NOT APPEAR ON ALL ASSEMBLIES.
- DIMENSIONS IN BRACKETS ARE IN INCHES.
- HOUSING FEATURES ARE: FEED THRU WITH LOCKING  
 RAMP AND POLARIZING TAB.
- OBsolete PARTS: OBSOLETE CIS STREAMLINING PER D.RENAUD/D.SINISI

DIM A	NO. OF POSN	ASSEMBLY
38.10	15	4-644726-5
35.56	14	4-644726-4
33.02	13	4-644726-3
30.48	12	4-644726-2
27.94	11	4-644726-1
25.40	10	4-644726-0
22.86	9	3-644726-9
20.32	8	3-644726-8
17.78	7	3-644726-7
15.24	6	3-644726-6
12.70	5	3-644726-5
10.16	4	3-644726-4
7.62	3	3-644726-3
5.08	2	3-644726-2

LEAD FREE

⚠ SUPERSEDED

⚠ SUPERSEDED

DIM A	NO. OF POSN	ASSEMBLY
38.10	15	1-644726-5
35.56	14	1-644726-4
33.02	13	1-644726-3
30.48	12	1-644726-2
27.94	11	1-644726-1
25.40	10	1-644726-0
22.86	9	644726-9
20.32	8	644726-8
17.78	7	644726-7
15.24	6	644726-6
12.70	5	644726-5
10.16	4	644726-4
7.62	3	644726-3
5.08	2	644726-2

CONTAINS LEAD

**METRIC**

THIS DRAWING IS A CONTROLLED DOCUMENT.

UNLESS OTHERWISE SPECIFIED, DIMENSIONS ARE IN INCHES.

DATE: 114-1019

SIZE: 108-1050

REV: 1

REVISED PER ECO-07-003747

REVISED PER ECO-09-003515

DATE: 27FEB07

DATE: 13OCT09

BY: KW

BY: KK

CHK: DB

CHK: AEG

APP: [Signature]

APP: [Signature]

DESCRIPTION: MTA 100 CONNECTOR ASSEMBLY, 26 AWG, STANDARD

DRAWING NO: 644726

CUSTOMER DRAWING: A100779

REV: 1

REV: 1

REV: 1