

THIS DRAWING IS UNPUBLISHED  
 ALL RIGHTS RESERVED

REV	DATE	DESCRIPTION	BY	CHK	APP
00					
01		REVISED PER ECO-11-004917			

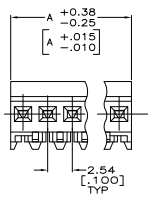
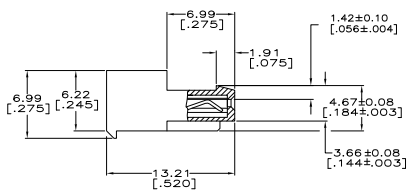
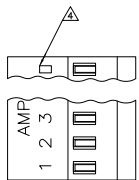

DIM	A	NO. OF POSN	ASSEMBLY
71.12	[2.800]	28	5-641240-8
68.58	[2.700]	27	5-641240-7
66.04	[2.600]	26	5-641240-6
63.50	[2.500]	25	5-641240-5
60.96	[2.400]	24	5-641240-4
58.42	[2.300]	23	5-641240-3
55.88	[2.200]	22	5-641240-2
53.34	[2.100]	21	5-641240-1
50.80	[2.000]	20	5-641240-0
48.26	[1.900]	19	4-641240-9
45.72	[1.800]	18	4-641240-8
43.18	[1.700]	17	4-641240-7
40.64	[1.600]	16	4-641240-6
38.10	[1.500]	15	4-641240-5
35.56	[1.400]	14	4-641240-4
33.02	[1.300]	13	4-641240-3
30.48	[1.200]	12	4-641240-2
27.94	[1.100]	11	4-641240-1
25.40	[1.000]	10	4-641240-0
22.86	[.900]	9	3-641240-9
20.32	[.800]	8	3-641240-8
17.78	[.700]	7	3-641240-7
15.24	[.600]	6	3-641240-6
12.70	[.500]	5	3-641240-5
10.16	[.400]	4	3-641240-4
7.62	[.300]	3	3-641240-3
5.08	[.200]	2	3-641240-2

DIM	A	NO. OF POSN	ASSEMBLY
71.12	[2.800]	28	2-641240-8
68.58	[2.700]	27	2-641240-7
66.04	[2.600]	26	2-641240-6
63.50	[2.500]	25	2-641240-5
60.96	[2.400]	24	2-641240-4
58.42	[2.300]	23	2-641240-3
55.88	[2.200]	22	2-641240-2
53.34	[2.100]	21	2-641240-1
50.80	[2.000]	20	2-641240-0
48.26	[1.900]	19	1-641240-9
45.72	[1.800]	18	1-641240-8
43.18	[1.700]	17	1-641240-7
40.64	[1.600]	16	1-641240-6
38.10	[1.500]	15	1-641240-5
35.56	[1.400]	14	1-641240-4
33.02	[1.300]	13	1-641240-3
30.48	[1.200]	12	1-641240-2
27.94	[1.100]	11	1-641240-1
25.40	[1.000]	10	1-641240-0
22.86	[.900]	9	641240-9
20.32	[.800]	8	641240-8
17.78	[.700]	7	641240-7
15.24	[.600]	6	641240-6
12.70	[.500]	5	641240-5
10.16	[.400]	4	641240-4
7.62	[.300]	3	641240-3
5.08	[.200]	2	641240-2

- 1 MATERIAL: CONNECTOR-NYLON UL94V-2 (GREEN). CONTACTS-0.30 [.012] THICK COPPER ALLOY 0.00076 [.000030] GOLD IN CONTACT AREA WITH BRIGHT TIN-LEAD FOR 641240-2 THRU 2-641240-8, MATTE WHISKER MITIGATED TIN FOR 3-641240-2 THRU 5-641240-8 OVER NICKEL UNDERPLATE.
- 2. CONTACTS ACCEPT 28 AWG WIRE WITH 1.52 [.060] MAX INSULATION DIAMETER.
- 3. CONTACTS MUST ACCEPT 0.64±0.03 [.025±.001] SQUARE POST AND REMAIN LOCKED IN POSITION.
- 4 IDENTIFICATION NUMBER FOR LAST CIRCUIT MAY NOT APPEAR ON ALL ASSEMBLIES.
- 5. DIMENSIONS IN BRACKETS ARE IN INCHES.
- 6. HOUSING FEATURES ARE: CLOSED END WITH LOCKING RAMP.
- 7 OBSOLETE PARTS: OBSOLETE CIS STREAMLINING PER D.RENAUD/D.SINISI

**METRIC**

THIS DRAWING IS A CONTROLLED DOCUMENT.		REV. 1	DATE	11-10-19	BY	108-1050	DATE	11-10-19	BY	108-1050	
DRAWN BY		DESIGNED BY	DATE	11-10-19	BY	108-1050	DATE	11-10-19	BY	108-1050	
CHECKED BY		DATE	11-10-19	BY	108-1050	DATE	11-10-19	BY	108-1050	DATE	11-10-19
APPROVED BY		DATE	11-10-19	BY	108-1050	DATE	11-10-19	BY	108-1050	DATE	11-10-19

TE Connectivity  
 MTA .100 CONNECTOR ASSEMBLY  
 28 AWG, STANDARD

108-1050  
 114-1019  
 A100779 G=641240

CUSTOMER DRAWING