

4

3

2

1

THIS DRAWING IS UNPUBLISHED. RELEASED FOR PUBLICATION.  
 © COPYRIGHT BY TYCO ELECTRONICS CORPORATION. ALL RIGHTS RESERVED.

LOC	DIST	REVISIONS			
F	LNK	DESCRIPTION	DATE	BY	APPD
H		ECO-07-012852	04JUN07	KW	DB
H1		REVISED PER ECO-09-021510	12SEP09	KK	AEG

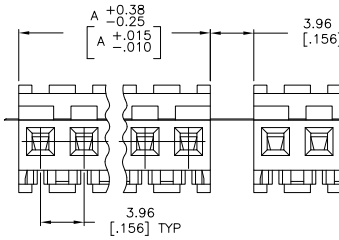
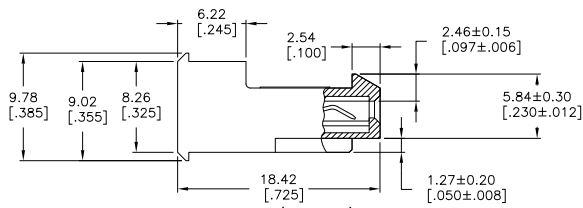
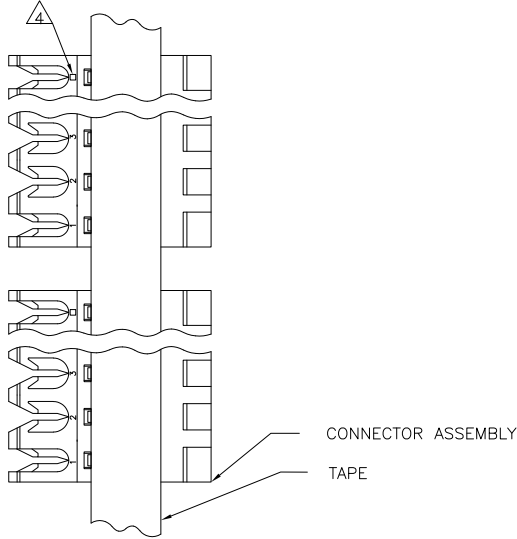

95.10	3.744	24	5-641302-4
91.14	3.588	23	5-641302-3
87.17	3.432	22	5-641302-2
83.21	3.276	21	5-641302-1
79.25	3.120	20	5-641302-0
75.29	2.964	19	4-641302-9
71.32	2.808	18	4-641302-8
67.36	2.652	17	4-641302-7
63.40	2.496	16	4-641302-6
59.44	2.340	15	4-641302-5
55.47	2.184	14	4-641302-4
51.51	2.028	13	4-641302-3
47.55	1.872	12	4-641302-2
43.59	1.716	11	4-641302-1
39.62	1.560	10	4-641302-0
35.66	1.404	9	3-641302-9
31.70	1.248	8	3-641302-8
27.74	1.092	7	3-641302-7
23.77	.936	6	3-641302-6
19.81	.780	5	3-641302-5
15.85	.624	4	3-641302-4
11.89	.468	3	3-641302-3
7.92	.312	2	3-641302-2
95.10	3.744	24	2-641302-4
91.14	3.588	23	2-641302-3
87.17	3.432	22	2-641302-2
83.21	3.276	21	2-641302-1
79.25	3.120	20	2-641302-0
75.29	2.964	19	1-641302-9
71.32	2.808	18	1-641302-8
67.36	2.652	17	1-641302-7
63.40	2.496	16	1-641302-6
59.44	2.340	15	1-641302-5
55.47	2.184	14	1-641302-4
51.51	2.028	13	1-641302-3
47.55	1.872	12	1-641302-2
43.59	1.716	11	1-641302-1
39.62	1.560	10	1-641302-0
35.66	1.404	9	641302-9
31.70	1.248	8	641302-8
27.74	1.092	7	641302-7
23.77	.936	6	641302-6
19.81	.780	5	641302-5
15.85	.624	4	641302-4
11.89	.468	3	641302-3
7.92	.312	2	641302-2

- 1 MATERIAL: CONNECTOR - NYLON UL94V-2 (ORANGE)  
 CONTACTS - 0.30[.012] THICK COPPER ALLOY  
 BRIGHT TIN-LEAD 0.00203[.000080] MIN THICK  
 FOR CONTACTS 641302-2 THRU 2-641302-4  
 MATTE WHISKER MITIGATED TIN 0.00203[.000080] MIN  
 THICKNESS OVER NICKEL UNDERPLATE FOR 3-641302-2  
 THRU 5-641302-4.
- 2. CONTACTS ACCEPT 18 AWG WIRE WITH 2.41[.095] MAX  
 INSULATION DIAMETER.
- 3. CONTACTS MUST ACCEPT 1.14±0.03 [.045±.001] SQUARE  
 POST AND REMAIN LOCKED IN POSITION.
- 4 IDENTIFICATION NUMBER FOR LAST CIRCUIT MAY  
 NOT APPEAR ON ALL ASSEMBLIES.
- 5. DIMENSIONS IN BRACKETS ARE IN INCHES.
- 6. HOUSING FEATURES ARE: FEED-THRU WITH LOCKING RAMP.
- 7 OBSOLETE PARTS: OBSOLETE CIS STREAMLINING PER D.RENAUD/D.SINISI



THIS DRAWING IS A CONTROLLED DOCUMENT.

DIMENSIONS: mm [INCHES]	TOLERANCES UNLESS OTHERWISE SPECIFIED:	DRW S.L. LEWIS 12 FEB 91	CHK S.L. LEWIS 12 FEB 91	APPD D. CLARK 20 FEB 91	NAME D. CLARK
0 PLC ± .005	1 PLC ± .005	2 PLC ± .005	3 PLC ± .010 [0.005]	4 PLC ± .010	ANGLES ± .5°
MATERIAL	FINISH	CUSTOMER DRAWING		SIZE A2	ONE CODE 00779
DIM A NO OF CIRCUITS PART NO 18 18 641302				Tyeo Electronics Corporation Harrisburg, Pa 17105-3608 MTA-156 CONNECTOR ASSEMBLY, 18 AWG, STANDARD TAPE MOUNTED	
SCALE 1:1				SHEET 1 OF 1 REV H1	

SUPERCEDED

641302