

4

3

2

1

THIS DRAWING IS UNPUBLISHED. RELEASED FOR PUBLICATION. ALL RIGHTS RESERVED.

LOC	DIST	REVISIONS			
F	LNK	DESCRIPTION	DATE	BY	APPD
CM	54	S2	REVISED PER ECO-11-005027	11MAR11	RK HMR

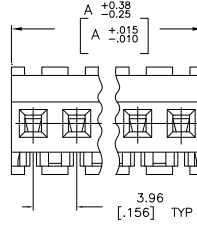
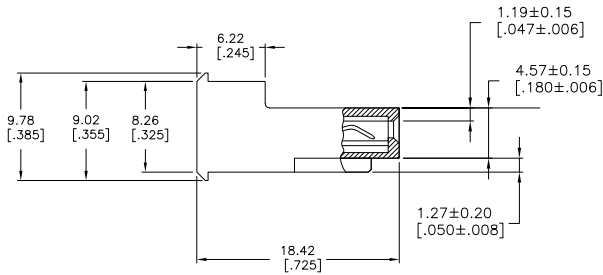
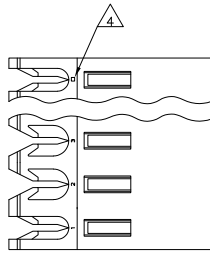

- 1 MATERIAL: CONNECTOR - NYLON UL94V-2 (WHITE)
CONTACTS - 0.30[.012] THICK COPPER ALLOY (BRIGHT TIN-LEAD 0.00203[.000080] MIN. THICK FOR CONTACTS 640607-2 THRU 2-640607-4) (MATTE WHISKER MITIGATED TIN 0.00203[.000080] MIN THICKNESS OVER NICKEL UNDERPLATE FOR 3-640607-2 THRU 5-640607-4).
- 2 CONTACTS ACCEPT 24 AWG WIRE WITH 2.41[.095] MAX INSULATION DIAMETER.
- 3 CONTACTS MUST ACCEPT 1.14±0.03[.045±.001] SQUARE POST AND REMAIN LOCKED IN POSITION.
- 4 IDENTIFICATION NUMBER FOR LAST CIRCUIT MAY NOT APPEAR ON ALL ASSEMBLIES.
- 5 DIMENSIONS IN BRACKETS ARE IN INCHES.
- 6 HOUSING FEATURES ARE: FEED-THRU WITHOUT LOCKING RAMP.
- 7 OBSOLETE PARTS: OBSOLETE CIS STREAMLINING PER D.RENAUD/D.SINISI



95.10	3.744	24	5-640607-4
91.14	3.588	23	5-640607-3
87.17	3.432	22	5-640607-2
83.21	3.276	21	5-640607-1
79.25	3.120	20	5-640607-0
75.29	2.964	19	4-640607-9
71.32	2.808	18	4-640607-8
67.36	2.652	17	4-640607-7
63.40	2.496	16	4-640607-6
59.44	2.340	15	4-640607-5
55.47	2.184	14	4-640607-4
51.51	2.028	13	4-640607-3
47.55	1.872	12	4-640607-2
43.59	1.716	11	4-640607-1
39.62	1.560	10	4-640607-0
35.66	1.404	9	3-640607-9
31.70	1.248	8	3-640607-8
27.74	1.092	7	3-640607-7
23.77	.936	6	3-640607-6
19.81	.780	5	3-640607-5
15.85	.624	4	3-640607-4
11.89	.468	3	3-640607-3
7.92	.312	2	3-640607-2
95.10	3.744	24	2-640607-4
91.14	3.588	23	2-640607-3
87.17	3.432	22	2-640607-2
83.21	3.276	21	2-640607-1
79.25	3.120	20	2-640607-0
75.29	2.964	19	1-640607-9
71.32	2.808	18	1-640607-8
67.36	2.652	17	1-640607-7
63.40	2.496	16	1-640607-6
59.44	2.340	15	1-640607-5
55.47	2.184	14	1-640607-4
51.51	2.028	13	1-640607-3
47.55	1.872	12	1-640607-2
43.59	1.716	11	1-640607-1
39.62	1.560	10	1-640607-0
35.66	1.404	9	640607-9
31.70	1.248	8	640607-8
27.74	1.092	7	640607-7
23.77	.936	6	640607-6
19.81	.780	5	640607-5
15.85	.624	4	640607-4
11.89	.468	3	640607-3
7.92	.312	2	640607-2

SUPERSEDED

SUPERSEDED

SUPERSEDED

THIS DRAWING IS A CONTROLLED DOCUMENT.

DIMENSIONS: mm [INCHES]	TOLERANCES UNLESS OTHERWISE SPECIFIED:	DRN: S. LEWIS 12FEB91	CHK: R. SWING 12FEB91	DATE: 12FEB91	NAME: D. CLARK
0 PLC ± .010	1 PLC ± .005	2 PLC ± .003	3 PLC ± .015 [0.005]	4 PLC ± .010	ANGLES ± .010
MATERIAL:	FINISH:	APPLICATION SPEC: 108-1051	APPLICATION SPEC: 114-1020	WEIGHT: -	SIZE: A2
CUSTOMER DRAWING		TE Connectivity		MTA-156 CONNECTOR ASSEMBLY, 24 AWG, STANDARD	
SCALE: 4:1		SHEET: 1 of 1		RESTRICTED TO: -	