

4

3

2

1

THIS DRAWING IS UNPUBLISHED. RELEASED FOR PUBLICATION. ALL RIGHTS RESERVED.

LOC	DIST	REVISIONS			
F	LNK	DESCRIPTION	DATE	BY	APPD
CM	54				
	C2	REVISED PER ECO-11-004917	11MAR11	RK	HMR

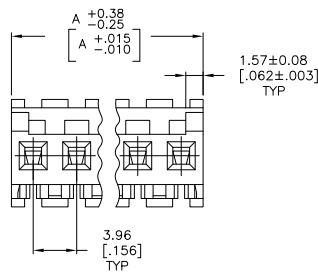
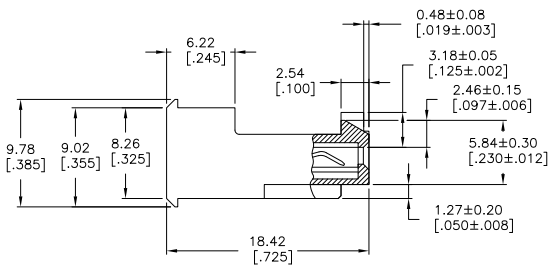
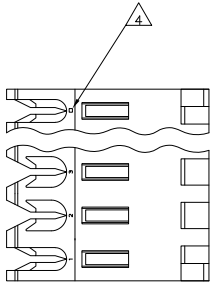

- △ MATERIAL: CONNECTOR - NYLON UL94V-2 (RED).
 CONTACTS - 0.30[.012] THICK COPPER ALLOY
 BRIGHT TIN-LEAD 0.00203[.000080] MIN THICK
 FOR CONTACTS 644467-2 THRU 1-644467-4
 MATTE WHISKER MITIGATED TIN 0.00203[.000080] MIN
 THICKNESS OVER NICKEL UNDERPLATE FOR
 3-644467-2 THRU 4-644467-4
- CONTACTS ACCEPT 22 AWG WIRE WITH 2.41[.095] MAX INSULATION DIAMETER.
 - CONTACTS MUST ACCEPT 1.14±0.03[.045±.001] SQUARE POST AND REMAIN LOCKED IN POSITION.
 - IDENTIFICATION NUMBER FOR LAST CIRCUIT MAY NOT APPEAR ON ALL ASSEMBLIES.
 - DIMENSIONS IN BRACKETS ARE IN INCHES.
 - HOUSING FEATURES ARE: FEED-THRU WITH LOCKING RAMP AND POLARIZING TAB.
 - OBsolete PARTS: OBsolete CIS STREAMLINING PER D.RENAUD/D.SINISI

55.47 [2.184]	14	4-644467-4	
51.51 [2.028]	13	4-644467-3	
47.55 [1.872]	12	4-644467-2	
43.59 [1.716]	11	4-644467-1	
39.62 [1.560]	10	4-644467-0	
35.66 [1.404]	9	3-644467-9	
31.70 [1.248]	8	3-644467-8	
27.74 [1.092]	7	3-644467-7	
23.77 [.936]	6	3-644467-6	
19.81 [.780]	5	3-644467-5	
15.85 [.624]	4	3-644467-4	
11.89 [.468]	3	3-644467-3	
7.92 [.312]	2	3-644467-2	
△ SUPERSEDED	55.47 [2.184]	14	1-644467-4
△ SUPERSEDED	51.51 [2.028]	13	1-644467-3
	47.55 [1.872]	12	1-644467-2
	43.59 [1.716]	11	1-644467-1
	39.62 [1.560]	10	1-644467-0
	35.66 [1.404]	9	644467-9
△ SUPERSEDED	31.70 [1.248]	8	644467-8
△ SUPERSEDED	27.74 [1.092]	7	644467-7
	23.77 [.936]	6	644467-6
	19.81 [.780]	5	644467-5
	15.85 [.624]	4	644467-4
	11.89 [.468]	3	644467-3
	7.92 [.312]	2	644467-2
	DIM A	NO. OF CIRCUITS	PART NO



THIS DRAWING IS A CONTROLLED DOCUMENT.

DIMENSIONS: mm [INCHES]	DESIGNED BY: S. LEWIS 12 FEB 91	DRW: S. LEWIS 12 FEB 91	DATE: 12 FEB 91
TOLERANCES UNLESS OTHERWISE SPECIFIED:	CHK: D. CLARK 20 FEB 91	APPD: D. CLARK 20 FEB 91	NAME: MTA 156 CONNECTOR ASSEMBLY, 22 AWG, STANDARD
0 PLC ± .010	1 PLC ± .015	2 PLC ± .020	3 PLC ± .030
4 PLC ± .040	5 PLC ± .050	6 PLC ± .060	7 PLC ± .070
8 PLC ± .080	9 PLC ± .090	10 PLC ± .100	11 PLC ± .120
12 PLC ± .150	13 PLC ± .200	14 PLC ± .250	15 PLC ± .300
ANGLES ± .5°	FINISH: RA .125	SIZE: A2	CAGE CODE: 00779
MATERIAL: NYLON UL94V-2 (RED)	FINISH: BRIGHT TIN-LEAD	DRAWING NO: 644467	RESTRICTED TO: -
		CUSTOMER DRAWING	SCALE: 4:1 SHEET: 1 of 1 REV: C2