

4

3

2

1

THIS DRAWING IS UNPUBLISHED. RELEASED FOR PUBLICATION. ALL RIGHTS RESERVED.

LOC	DIST	REVISIONS			
F	LNK	DESCRIPTION	DATE	BY	APPD
CM	54	T2	REVISED PER ECO-11-004820	11MAR11	RIK HMR

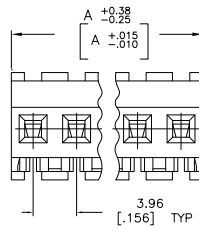
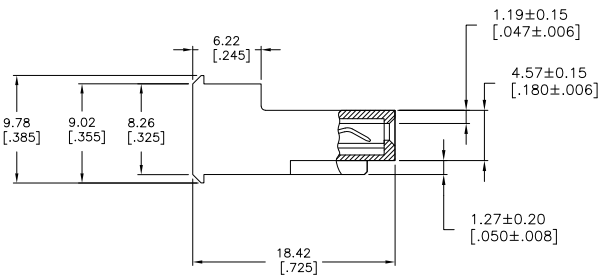
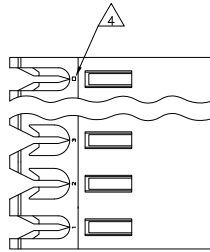

NOTES:

- 1. MATERIAL: CONNECTOR - NYLON UL94V-2 (ORANGE)
CONTACTS - 0.30[.012] THICK COPPER ALLOY (BRIGHT TIN-LEAD 0.00203[.000080] MIN. THICK FOR CONTACTS 640604-2 THRU 2-640604-4) (MATTE WHISKER MITIGATED TIN 0.00203[.000080] MIN THICKNESS OVER NICKEL UNDERPLATE FOR CONTACTS 3-640604-2 THRU 5-640604-4).
- 2. CONTACTS ACCEPT 18 AWG WIRE WITH 2.41[.095] MAX INSULATION DIAMETER.
- 3. CONTACTS MUST ACCEPT 1.14±0.03[.045±.001] SQUARE POST AND REMAIN LOCKED IN POSITION.
- 4. IDENTIFICATION NUMBER FOR LAST CIRCUIT MAY NOT APPEAR ON ALL ASSEMBLIES.
- 5. DIMENSIONS IN BRACKETS ARE IN INCHES.
- 6. HOUSING FEATURES ARE: FEED-THRU WITHOUT LOCKING RAMP.
- 7. OBSOLETE PARTS: OBSOLETE CIS STREAMLINING PER D.RENAUD/D.SINISI



95.10	3.744	24	5-640604-4
91.14	3.588	23	5-640604-3
87.17	3.432	22	5-640604-2
83.21	3.276	21	5-640604-1
79.25	3.120	20	5-640604-0
75.29	2.964	19	4-640604-9
71.32	2.808	18	4-640604-8
67.36	2.652	17	4-640604-7
63.40	2.496	16	4-640604-6
59.44	2.340	15	4-640604-5
55.47	2.184	14	4-640604-4
51.51	2.028	13	4-640604-3
47.55	1.872	12	4-640604-2
43.59	1.716	11	4-640604-1
39.62	1.560	10	4-640604-0
35.66	1.404	9	3-640604-9
31.70	1.248	8	3-640604-8
27.74	1.092	7	3-640604-7
23.77	.936	6	3-640604-6
19.81	.780	5	3-640604-5
15.85	.624	4	3-640604-4
11.89	.468	3	3-640604-3
7.92	.312	2	3-640604-2
95.10	3.744	24	2-640604-4
91.14	3.588	23	2-640604-3
87.17	3.432	22	2-640604-2
83.21	3.276	21	2-640604-1
79.25	3.120	20	2-640604-0
75.29	2.964	19	1-640604-9
71.32	2.808	18	1-640604-8
67.36	2.652	17	1-640604-7
63.40	2.496	16	1-640604-6
59.44	2.340	15	1-640604-5
55.47	2.184	14	1-640604-4
51.51	2.028	13	1-640604-3
47.55	1.872	12	1-640604-2
43.59	1.716	11	1-640604-1
39.62	1.560	10	1-640604-0
35.66	1.404	9	640604-9
31.70	1.248	8	640604-8
27.74	1.092	7	640604-7
23.77	.936	6	640604-6
19.81	.780	5	640604-5
15.85	.624	4	640604-4
11.89	.468	3	640604-3
7.92	.312	2	640604-2

SUPERSEDED
7

SUPERSEDED
A

SUPERSEDED
A

THIS DRAWING IS A CONTROLLED DOCUMENT.

DRM: S. LEWIS 12FEB91
CHK: S. LEWIS 12FEB91
R: SWING
D: D. CLARK 19FEB91
ZPFC: NAME
108-1051
APPLICATION SPEC: 114-1020
WEIGHT: -

TE Connectivity
MTA-156 CONNECTOR ASSEMBLY,
18 AWG, STANDARD

SIZE: A2 CASE CODE: C-640604
CUSTOMER DRAWING SCALE: 4:1 SHEET: 1 of 1 REV: T2