

4

3

2

1

THIS DRAWING IS UNPUBLISHED. RELEASED FOR PUBLICATION  
 © COPYRIGHT BY TYCO ELECTRONICS CORPORATION. ALL RIGHTS RESERVED.

LOC	DIST	REVISIONS					
CM	00	F	LNK	DESCRIPTION	DATE	BY	APPD
		B		REVISION PER ECO-07-003728	23FEB07	KW	DB
		B1		REVISED PER ECO-09-023313	12OCT09	KK	AEG

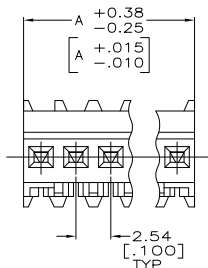
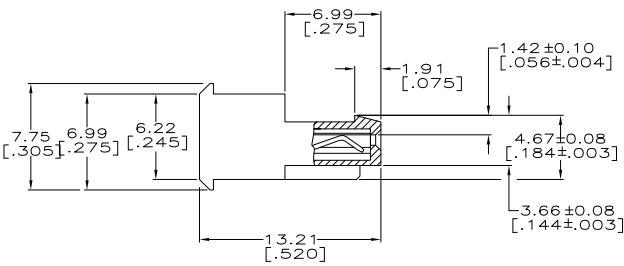
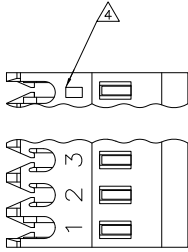

△ MATERIAL: CONNECTOR-NYLON UL94V-0 (BLACK).  
 CONTACTS-0.30 [.012] THICK COPPER ALLOY  
 BRIGHT TIN-LEAD 0.00203 [.000080] MIN THICK FOR CONTACTS  
 644577-2 THRU 1-644577-5  
 MATTE WHISKER MITIGATED TIN PLATE 0.00203 [.000080] MIN THICK  
 OVER 0.00076 [.000030] MIN THICK NICKEL FOR CONTACTS  
 3-644577-2 THRU 4-644577-5.

2. CONTACTS ACCEPT 26 AWG WIRE WITH 1.52 [.060] MAX INSULATION DIAMETER.

3. CONTACTS MUST ACCEPT 0.64±0.03 [.025±.001] SQUARE POST AND REMAIN LOCKED IN POSITION.

△ IDENTIFICATION NUMBER FOR LAST CIRCUIT MAY NOT APPEAR ON ALL ASSEMBLIES.

5. DIMENSIONS IN BRACKETS ARE IN INCHES.

6. HOUSING FEATURES ARE: FEED THRU WITH LOCKING RAMP.

△ OBSOLETE PARTS: OBSOLETE CIS STREAMLINING PER D.RENAUD/D.SINISI

LEAD FREE	LEAD	DIM A	NO.OF POSN	ASSEMBLY
38.10 [1.500]	15	4-644577-5		
35.56 [1.400]	14	4-644577-4		
33.02 [1.300]	13	4-644577-3		
30.48 [1.200]	12	4-644577-2		
27.94 [1.100]	11	4-644577-1		
25.40 [1.000]	10	4-644577-0		
22.86 [.900]	9	3-644577-9		
20.32 [.800]	8	3-644577-8		
17.78 [.700]	7	3-644577-7		
15.24 [.600]	6	3-644577-6		
12.70 [.500]	5	3-644577-5		
10.16 [.400]	4	3-644577-4		
7.62 [.300]	3	3-644577-3		
5.08 [.200]	2	3-644577-2		
CONTAINS LEAD				
38.10 [1.500]	15	<del>4-644577-5</del>		
35.56 [1.400]	14	<del>4-644577-4</del>		
33.02 [1.300]	13	<del>4-644577-3</del>		
30.48 [1.200]	12	<del>4-644577-2</del>		
27.94 [1.100]	11	<del>4-644577-1</del>		
25.40 [1.000]	10	<del>4-644577-0</del>		
22.86 [.900]	9	<del>3-644577-9</del>		
20.32 [.800]	8	<del>3-644577-8</del>		
17.78 [.700]	7	<del>3-644577-7</del>		
15.24 [.600]	6	<del>3-644577-6</del>		
12.70 [.500]	5	<del>3-644577-5</del>		
10.16 [.400]	4	<del>3-644577-4</del>		
7.62 [.300]	3	<del>3-644577-3</del>		
5.08 [.200]	2	<del>3-644577-2</del>		

△ SUPERSEDED

△ SUPERSEDED  
 △ SUPERSEDED

**METRIC**

THIS DRAWING IS A CONTROLLED DOCUMENT.

DIM S. HOOVER 03-DEC-2004	Tyco Electronics Corporation Harrisburg, Pa 17105-3608
CHK D. BOSSI 03-DEC-2004	
APP D. BOSSI	MTA .100 CONNECTOR ASSEMBLY 26 AWG, BLACK UL94V-0, SPECIAL
PRODUCT SPEC 108-1019	
APPLICATION SPEC 114-1050	SIZE CASE CODE DRAWING NO
WEIGHT	A2 00779 C-644577
MATERIAL △	RESTRICTED TO
FINISH △	CUSTOMER DRAWING

SCALE: 5:1 SHEET 1 OF 1 REV B1

AMP 1471-9 REV 31MM2000