

4

3

2

1

THIS DRAWING IS UNPUBLISHED. RELEASED FOR PUBLICATION. ALL RIGHTS RESERVED.

LOC	DIST	REVISIONS					
CM	00	F	LNK	DESCRIPTION	DATE	BY	APPD
		F2		REVISED PER ECO-11-005027	11MAR11	RK	HMR

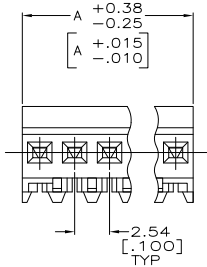
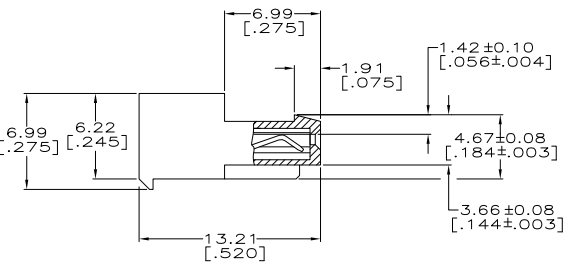
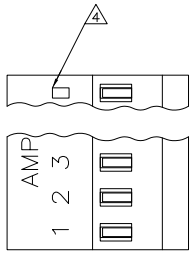

MATERIAL: CONNECTOR-NYLON UL94V-0 (BLACK)
 CONTACTS-0.30 [.012] THICK COPPER ALLOY
 BRIGHT TIN-LEAD 0.00203 [.000080] MIN THICK FOR CONTACTS
 643498-2 THRU 1-643498-5
 MATTE WHISKER MITIGATED TIN PLATE 0.00203 [.000080] MIN THICK
 OVER 0.00076 [.000030] MIN THICK NICKEL FOR CONTACTS
 3-643498-2 THRU 4-643498-5

- CONTACTS ACCEPT 22 AWG WIRE WITH 1.52 [.060] MAX INSULATION DIAMETER.
- CONTACTS MUST ACCEPT 0.64 ± 0.03 [.025 ± .001] SQUARE POST AND REMAIN LOCKED IN POSITION.
- IDENTIFICATION NUMBER FOR LAST CIRCUIT MAY NOT APPEAR ON ALL ASSEMBLIES.
- DIMENSIONS IN BRACKETS ARE IN INCHES.
- HOUSING FEATURES ARE: CLOSED END WITH LOCKING RAMP.
- OBsolete PARTS: OBsolete CIS STREAMLINING PER D.RENAUD/D.SINISI

METRIC

LEAD	DIM A	NO. OF POSN	ASSEMBLY
FREE	38.10 [1.500]	15	4-643498-5
FREE	35.56 [1.400]	14	4-643498-4
FREE	33.02 [1.300]	13	4-643498-3
FREE	30.48 [1.200]	12	4-643498-2
FREE	27.94 [1.100]	11	4-643498-1
FREE	25.40 [1.000]	10	4-643498-0
FREE	22.86 [.900]	9	3-643498-9
FREE	20.32 [.800]	8	3-643498-8
FREE	17.78 [.700]	7	3-643498-7
FREE	15.24 [.600]	6	3-643498-6
FREE	12.70 [.500]	5	3-643498-5
FREE	10.16 [.400]	4	3-643498-4
FREE	7.62 [.300]	3	3-643498-3
FREE	5.08 [.200]	2	3-643498-2
LEAD	38.10 [1.500]	15	4-643498-5
LEAD	35.56 [1.400]	14	1-643498-4
LEAD	33.02 [1.300]	13	4-643498-3
LEAD	30.48 [1.200]	12	4-643498-2
LEAD	27.94 [1.100]	11	4-643498-1
LEAD	25.40 [1.000]	10	1-643498-0
LEAD	22.86 [.900]	9	643498-9
LEAD	20.32 [.800]	8	643498-8
LEAD	17.78 [.700]	7	643498-7
LEAD	15.24 [.600]	6	643498-6
LEAD	12.70 [.500]	5	643498-5
LEAD	10.16 [.400]	4	643498-4
LEAD	7.62 [.300]	3	643498-3
LEAD	5.08 [.200]	2	643498-2

- SUPERCEDED BY 4-643498-5
- SUPERCEDED BY 4-643498-3
- SUPERCEDED BY 4-643498-2
- SUPERCEDED BY 4-643498-1
- SUPERCEDED BY 3-643498-9
- SUPERCEDED BY 3-643498-8
- SUPERCEDED BY 3-643498-5

THIS DRAWING IS A CONTROLLED DOCUMENT.

DRW: S. HOOVER 03-DEC-2004	TE Connectivity
CHK: D. BOSSI 03-DEC-2004	TE Connectivity
APP: D. BOSSI	TE Connectivity
NAME: MTA .100 CONNECTOR ASSEMBLY	TE Connectivity
PRODUCT SPEC: 108-1050	TE Connectivity
APPLICATION SPEC: 114-1019	TE Connectivity
WEIGHT:	TE Connectivity
FINISH:	TE Connectivity

Customer Drawing, Scale 5:1, Sheet 1 of 1, Rev F2