

THIS DRAWING IS UNPUBLISHED  
 ALL RIGHTS RESERVED

REV	DATE	DESCRIPTION	BY	CHK	APP
CM 00					
K2		REVISED PER EDD-11-004587		11MMR11	RK HMR

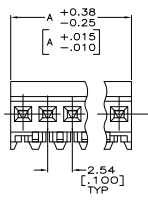
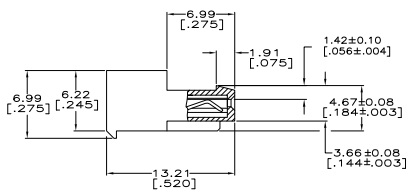
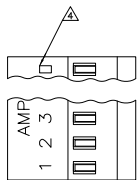

- △ MATERIAL: CONNECTOR-NYLON UL94V-2 (RED).  
 CONTACTS-0.30 [.012] THICK COPPER ALLOY  
 0.00038 [.000015] GOLD IN CONTACT AREA  
 WITH BRIGHT TIN-LEAD FOR 641190-2 THRU  
 2-641190-8, MATTE WHISKER MITIGATED TIN  
 FOR 3-641190-2 THRU 5-641190-8 OVER  
 NICKEL UNDERPLATE.
2. CONTACTS ACCEPT 22 AWG WIRE WITH 1.52 [.060] MAX  
 INSULATION DIAMETER.
3. CONTACTS MUST ACCEPT 0.64±0.03 [.025±.001] SQUARE  
 POST AND REMAIN LOCKED IN POSITION.
- △ IDENTIFICATION NUMBER FOR LAST CIRCUIT MAY  
 NOT APPEAR ON ALL ASSEMBLIES.
5. DIMENSIONS IN BRACKETS ARE IN INCHES.
6. HOUSING FEATURES ARE: CLOSED END WITH LOCKING  
 RAMP.
- △ OBSOLETE PARTS: OBSOLETE CIS STREAMLINING PER D.RENAUD/D.SINISI

DIM A	NO. OF POSN	ASSEMBLY
71.12 [2.800]	28	5-641190-8
66.04 [2.600]	27	5-641190-7
63.50 [2.500]	26	5-641190-6
63.50 [2.500]	25	5-641190-5
60.96 [2.400]	24	5-641190-4
58.42 [2.300]	23	5-641190-3
55.88 [2.200]	22	5-641190-2
53.34 [2.100]	21	5-641190-1
50.80 [2.000]	20	5-641190-0
48.26 [1.900]	19	4-641190-9
45.72 [1.800]	18	4-641190-8
43.18 [1.700]	17	4-641190-7
40.64 [1.600]	16	4-641190-6
38.10 [1.500]	15	4-641190-5
35.56 [1.400]	14	4-641190-4
33.02 [1.300]	13	4-641190-3
30.48 [1.200]	12	4-641190-2
27.94 [1.100]	11	4-641190-1
25.40 [1.000]	10	4-641190-0
22.86 [.900]	9	3-641190-9
20.32 [.800]	8	3-641190-8
17.78 [.700]	7	3-641190-7
15.24 [600]	6	3-641190-6
12.70 [500]	5	3-641190-5
10.16 [400]	4	3-641190-4
7.62 [300]	3	3-641190-3
5.08 [200]	2	3-641190-2
DIM A	NO. OF POSN	ASSEMBLY

DIM A	NO. OF POSN	ASSEMBLY
71.12 [2.800]	28	2-641190-8
66.04 [2.600]	27	2-641190-7
63.50 [2.500]	26	2-641190-6
63.50 [2.500]	25	2-641190-5
60.96 [2.400]	24	2-641190-4
58.42 [2.300]	23	2-641190-3
55.88 [2.200]	22	2-641190-2
53.34 [2.100]	21	2-641190-1
50.80 [2.000]	20	2-641190-0
48.26 [1.900]	19	1-641190-9
45.72 [1.800]	18	1-641190-8
43.18 [1.700]	17	1-641190-7
40.64 [1.600]	16	1-641190-6
38.10 [1.500]	15	1-641190-5
35.56 [1.400]	14	1-641190-4
33.02 [1.300]	13	1-641190-3
30.48 [1.200]	12	1-641190-2
27.94 [1.100]	11	1-641190-1
25.40 [1.000]	10	1-641190-0
22.86 [900]	9	641190-9
20.32 [800]	8	641190-8
17.78 [700]	7	641190-7
15.24 [600]	6	641190-6
12.70 [500]	5	641190-5
10.16 [400]	4	641190-4
7.62 [300]	3	641190-3
5.08 [200]	2	641190-2
DIM A	NO. OF POSN	ASSEMBLY

METRIC

THIS DRAWING IS A CONTROLLED DOCUMENT.

DESIGNER: JH-001-0001  
 CHECKED: JH-001-0001  
 DRAWN: JH-001-0001  
 DATE: 108-1050  
 114-1019

TE Connectivity  
 MTA .100 CONNECTOR ASSEMBLY  
 22 AWG, STANDARD

DATE: 11-01-19  
 SIZE: 5.1  
 SHEET: 1 OF 1  
 REV: K2