

4

3

2

1

THIS DRAWING IS UNPUBLISHED. RELEASED FOR PUBLICATION
 © COPYRIGHT - By - ALL RIGHTS RESERVED.

LOC	DIST	REVISIONS				
		F	LNK	DATE	BY	APP'D
CM	0	F1		REVISED PER ECO-11-004820	11MAR11	RK HMR

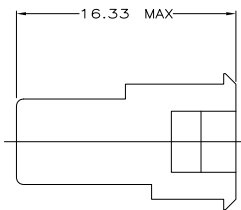
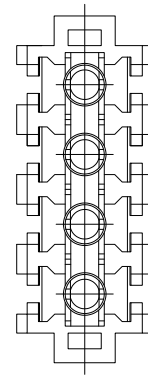
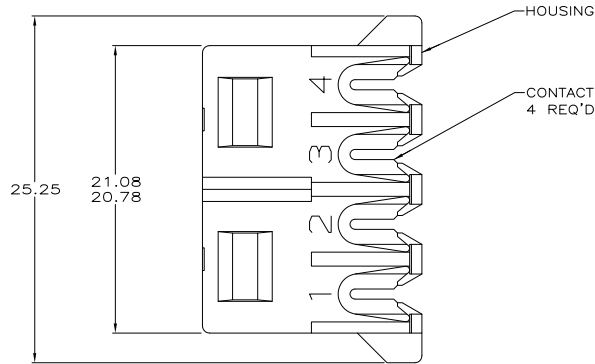
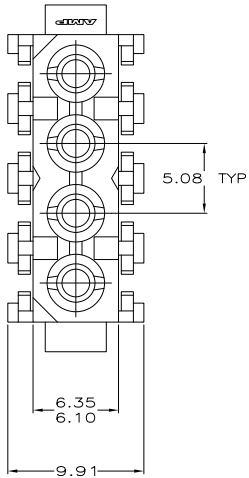

- △ NOTE DELETED.
 2. INSULATION DIAMETER 2.41[.095] MAX.

COLOR	WIRE SIZE	CONTACT MATERIAL AND FINISH	HOUSING MATERIAL	PART NO
BLUE	1.25 mm ² (16 AWG)	PHOS BRONZE, TIN	NYLON,UL 94V-2	770156-5
YELLOW	0.5 mm ² (20 AWG)	PHOS BRONZE, TIN	NYLON,UL 94V-2	770156-4
ORANGE	0.8 mm ² (18 AWG)	PHOS BRONZE, TIN	NYLON,UL 94V-2	770156-3
RED	0.3 mm ² (22 AWG)	PHOS BRONZE, TIN	NYLON,UL 94V-2	770156-2

9.91	.390	-	-
6.35	.250	25.25	.994
6.10	.240	21.08	.830
5.08	.200	20.78	.818
0.13	.005	16.33	.643
MM	IN	MM	IN

CONVERSION TABLE

METRIC

THIS DRAWING IS A CONTROLLED DOCUMENT.

DIMENSIONS: mm 	TOLERANCES UNLESS OTHERWISE SPECIFIED: 0 PLG ± - 1 PLG ± - 2 PLG ± 0.15 3 PLG ± - 4 PLG ± - ANGLES ± -	DWG: K. WHITAKER 2-10-94 CHK: R. SWING 2-10-94 P: - PRODUCT SPEC: - APPLICATION SPEC: - WEIGHT: - CUSTOMER DRAWING	TE Connectivity PLUG ASSEMBLY, INSULATION DISPLACEMENT, COMMERCIAL MATE-N-LOK(TM) SIZE: A2 ONE CODE (DRAWING NO): 00779 PART NO: 770156 RESTRICTED TO: - SCALE: 5:1 SHEET: 1 of 1 REV: F1
-----------------------	--------------------------------------------------------------------------------------------------------------------------	--------------------------------------------------------------------------------------------------------------------------------------	-------------------------------------------------------------------------------------------------------------------------------------------------------------------------------------------------------------------