

4

3

2

1

THIS DRAWING IS UNPUBLISHED. RELEASED FOR PUBLICATION. ALL RIGHTS RESERVED.

LOC	DIST	REVISIONS			
F	LNK	DESCRIPTION	DATE	BY	APPD
U2		REVISED PER ECO-11-004917	11MAR11	RK	HMR

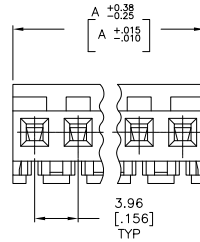
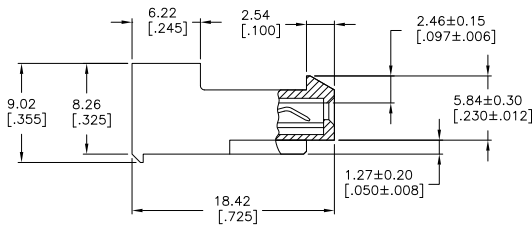
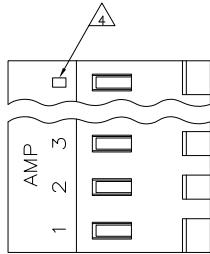

△ MATERIAL: CONNECTOR - NYLON UL94-V2 (ORANGE)
 CONTACTS - 0.30[.012] THICK COPPER ALLOY
 (BRIGHT TIN-LEAD 0.00203[.000080] MIN. THICK
 FOR CONTACTS 640430-2 THRU 2-640430-4).
 (MATTE WHISKER MITIGATED TIN 0.00203[.000080]
 MIN. THICKNESS OVER NICKEL UNDERPLATE FOR
 3-640430-2 THRU 5-640430-4).

- CONTACTS ACCEPT 26 AWG WIRE WITH 2.41[.095] MAX INSULATION DIAMETER.
- CONTACTS MUST ACCEPT 1.14±0.03[.045] POST AND REMAIN LOCKED IN POSITION.
- IDENTIFICATION NUMBER FOR LAST CIRCUIT MAY NOT APPEAR ON ALL ASSEMBLIES.
- DIMENSIONS IN BRACKETS ARE IN INCHES.
- HOUSING FEATURES ARE: CLOSED END WITH LOCKING RAMP.
- OBsolete PARTS: OBSOLETE CIS STREAMLINING PER D.RENAUD/D.SINISI

95.10[3.744]	24	5-640430-4	
91.13[3.588]	23	5-640430-3	
87.17[3.432]	22	5-640430-2	
83.21[3.276]	21	5-640430-1	
79.25[3.120]	20	5-640430-0	
75.29[2.964]	19	4-640430-9	
71.32[2.808]	18	4-640430-8	
67.36[2.652]	17	4-640430-7	
63.40[2.496]	16	4-640430-6	
59.44[2.340]	15	4-640430-5	
55.47[2.184]	14	4-640430-4	
51.51[2.028]	13	4-640430-3	
47.55[1.872]	12	4-640430-2	
43.59[1.716]	11	4-640430-1	
39.62[1.560]	10	4-640430-0	
35.66[1.404]	9	3-640430-9	
31.70[1.248]	8	3-640430-8	
27.74[1.092]	7	3-640430-7	
23.77[.936]	6	3-640430-6	
19.81[.780]	5	3-640430-5	
15.85[.624]	4	3-640430-4	
11.89[.468]	3	3-640430-3	
7.92[.312]	2	3-640430-2	
△ SUPERCEDED	95.10[3.744]	24	2-640430-4
△ SUPERCEDED	91.13[3.588]	23	2-640430-3
△ SUPERCEDED	87.17[3.432]	22	2-640430-2
△ SUPERCEDED	83.21[3.276]	21	2-640430-1
△ SUPERCEDED	79.25[3.120]	20	1-640430-0
△ SUPERCEDED	75.29[2.964]	19	1-640430-9
△ SUPERCEDED	71.32[2.808]	18	1-640430-8
△ SUPERCEDED	67.36[2.652]	17	1-640430-7
△ SUPERCEDED	63.40[2.496]	16	1-640430-6
△ SUPERCEDED	59.44[2.340]	15	1-640430-5
△ SUPERCEDED	55.47[2.184]	14	1-640430-4
△ SUPERCEDED	51.51[2.028]	13	1-640430-3
△ SUPERCEDED	47.55[1.872]	12	1-640430-2
△ SUPERCEDED	43.59[1.716]	11	1-640430-1
△ SUPERCEDED	39.62[1.560]	10	1-640430-0
△ SUPERCEDED	35.66[1.404]	9	640430-9
△ SUPERCEDED	31.70[1.248]	8	640430-8
△ SUPERCEDED	27.74[1.092]	7	640430-7
△ SUPERCEDED	23.77[.936]	6	640430-6
△ SUPERCEDED	19.81[.780]	5	640430-5
△ SUPERCEDED	15.85[.624]	4	640430-4
△ SUPERCEDED	11.89[.468]	3	640430-3
△ SUPERCEDED	7.92[.312]	2	640430-2



THIS DRAWING IS A CONTROLLED DOCUMENT.

DIMENSIONS: mm [INCHES]	TOLERANCES UNLESS OTHERWISE SPECIFIED:	DRN S. CARPENTER 08A02003	DATE 08A02003
0 PLC ± .005	1 PLC ± .005	2 PLC ± .005	3 PLC ± .005
4 PLC ± .010	5 PLC ± .010	6 PLC ± .010	7 PLC ± .010
8 PLC ± .015	9 PLC ± .015	10 PLC ± .015	11 PLC ± .015
12 PLC ± .020	13 PLC ± .020	14 PLC ± .020	15 PLC ± .020
16 PLC ± .025	17 PLC ± .025	18 PLC ± .025	19 PLC ± .025
20 PLC ± .030	21 PLC ± .030	22 PLC ± .030	23 PLC ± .030
24 PLC ± .035	25 PLC ± .035	26 PLC ± .035	27 PLC ± .035
28 PLC ± .040	29 PLC ± .040	30 PLC ± .040	31 PLC ± .040
32 PLC ± .045	33 PLC ± .045	34 PLC ± .045	35 PLC ± .045
36 PLC ± .050	37 PLC ± .050	38 PLC ± .050	39 PLC ± .050
40 PLC ± .055	41 PLC ± .055	42 PLC ± .055	43 PLC ± .055
44 PLC ± .060	45 PLC ± .060	46 PLC ± .060	47 PLC ± .060
48 PLC ± .065	49 PLC ± .065	50 PLC ± .065	51 PLC ± .065
52 PLC ± .070	53 PLC ± .070	54 PLC ± .070	55 PLC ± .070
56 PLC ± .075	57 PLC ± .075	58 PLC ± .075	59 PLC ± .075
60 PLC ± .080	61 PLC ± .080	62 PLC ± .080	63 PLC ± .080
64 PLC ± .085	65 PLC ± .085	66 PLC ± .085	67 PLC ± .085
68 PLC ± .090	69 PLC ± .090	70 PLC ± .090	71 PLC ± .090
72 PLC ± .095	73 PLC ± .095	74 PLC ± .095	75 PLC ± .095
76 PLC ± .100	77 PLC ± .100	78 PLC ± .100	79 PLC ± .100
80 PLC ± .105	81 PLC ± .105	82 PLC ± .105	83 PLC ± .105
84 PLC ± .110	85 PLC ± .110	86 PLC ± .110	87 PLC ± .110
88 PLC ± .115	89 PLC ± .115	90 PLC ± .115	91 PLC ± .115
92 PLC ± .120	93 PLC ± .120	94 PLC ± .120	95 PLC ± .120
96 PLC ± .125	97 PLC ± .125	98 PLC ± .125	99 PLC ± .125
100 PLC ± .130	101 PLC ± .130	102 PLC ± .130	103 PLC ± .130
104 PLC ± .135	105 PLC ± .135	106 PLC ± .135	107 PLC ± .135
108 PLC ± .140	109 PLC ± .140	110 PLC ± .140	111 PLC ± .140
112 PLC ± .145	113 PLC ± .145	114 PLC ± .145	115 PLC ± .145
116 PLC ± .150	117 PLC ± .150	118 PLC ± .150	119 PLC ± .150
120 PLC ± .155	121 PLC ± .155	122 PLC ± .155	123 PLC ± .155
124 PLC ± .160	125 PLC ± .160	126 PLC ± .160	127 PLC ± .160
128 PLC ± .165	129 PLC ± .165	130 PLC ± .165	131 PLC ± .165
132 PLC ± .170	133 PLC ± .170	134 PLC ± .170	135 PLC ± .170
136 PLC ± .175	137 PLC ± .175	138 PLC ± .175	139 PLC ± .175
140 PLC ± .180	141 PLC ± .180	142 PLC ± .180	143 PLC ± .180
144 PLC ± .185	145 PLC ± .185	146 PLC ± .185	147 PLC ± .185
148 PLC ± .190	149 PLC ± .190	150 PLC ± .190	151 PLC ± .190
152 PLC ± .195	153 PLC ± .195	154 PLC ± .195	155 PLC ± .195
156 PLC ± .200	157 PLC ± .200	158 PLC ± .200	159 PLC ± .200
160 PLC ± .205	161 PLC ± .205	162 PLC ± .205	163 PLC ± .205
164 PLC ± .210	165 PLC ± .210	166 PLC ± .210	167 PLC ± .210
168 PLC ± .215	169 PLC ± .215	170 PLC ± .215	171 PLC ± .215
172 PLC ± .220	173 PLC ± .220	174 PLC ± .220	175 PLC ± .220
176 PLC ± .225	177 PLC ± .225	178 PLC ± .225	179 PLC ± .225
180 PLC ± .230	181 PLC ± .230	182 PLC ± .230	183 PLC ± .230
184 PLC ± .235	185 PLC ± .235	186 PLC ± .235	187 PLC ± .235
188 PLC ± .240	189 PLC ± .240	190 PLC ± .240	191 PLC ± .240
192 PLC ± .245	193 PLC ± .245	194 PLC ± .245	195 PLC ± .245
196 PLC ± .250	197 PLC ± .250	198 PLC ± .250	199 PLC ± .250
200 PLC ± .255	201 PLC ± .255	202 PLC ± .255	203 PLC ± .255
204 PLC ± .260	205 PLC ± .260	206 PLC ± .260	207 PLC ± .260
208 PLC ± .265	209 PLC ± .265	210 PLC ± .265	211 PLC ± .265
212 PLC ± .270	213 PLC ± .270	214 PLC ± .270	215 PLC ± .270
216 PLC ± .275	217 PLC ± .275	218 PLC ± .275	219 PLC ± .275
220 PLC ± .280	221 PLC ± .280	222 PLC ± .280	223 PLC ± .280
224 PLC ± .285	225 PLC ± .285	226 PLC ± .285	227 PLC ± .285
228 PLC ± .290	229 PLC ± .290	230 PLC ± .290	231 PLC ± .290
232 PLC ± .295	233 PLC ± .295	234 PLC ± .295	235 PLC ± .295
236 PLC ± .300	237 PLC ± .300	238 PLC ± .300	239 PLC ± .300
240 PLC ± .305	241 PLC ± .305	242 PLC ± .305	243 PLC ± .305
244 PLC ± .310	245 PLC ± .310	246 PLC ± .310	247 PLC ± .310
248 PLC ± .315	249 PLC ± .315	250 PLC ± .315	251 PLC ± .315
252 PLC ± .320	253 PLC ± .320	254 PLC ± .320	255 PLC ± .320
256 PLC ± .325	257 PLC ± .325	258 PLC ± .325	259 PLC ± .325
260 PLC ± .330	261 PLC ± .330	262 PLC ± .330	263 PLC ± .330
264 PLC ± .335	265 PLC ± .335	266 PLC ± .335	267 PLC ± .335
268 PLC ± .340	269 PLC ± .340	270 PLC ± .340	271 PLC ± .340
272 PLC ± .345	273 PLC ± .345	274 PLC ± .345	275 PLC ± .345
276 PLC ± .350	277 PLC ± .350	278 PLC ± .350	279 PLC ± .350
280 PLC ± .355	281 PLC ± .355	282 PLC ± .355	283 PLC ± .355
284 PLC ± .360	285 PLC ± .360	286 PLC ± .360	287 PLC ± .360
288 PLC ± .365	289 PLC ± .365	290 PLC ± .365	291 PLC ± .365
292 PLC ± .370	293 PLC ± .370	294 PLC ± .370	295 PLC ± .370
296 PLC ± .375	297 PLC ± .375	298 PLC ± .375	299 PLC ± .375
300 PLC ± .380	301 PLC ± .380	302 PLC ± .380	303 PLC ± .380
304 PLC ± .385	305 PLC ± .385	306 PLC ± .385	307 PLC ± .385
308 PLC ± .390	309 PLC ± .390	310 PLC ± .390	311 PLC ± .390
312 PLC ± .395	313 PLC ± .395	314 PLC ± .395	315 PLC ± .395
316 PLC ± .400	317 PLC ± .400	318 PLC ± .400	319 PLC ± .400
320 PLC ± .405	321 PLC ± .405	322 PLC ± .405	323 PLC ± .405
324 PLC ± .410	325 PLC ± .410	326 PLC ± .410	327 PLC ± .410
328 PLC ± .415	329 PLC ± .415	330 PLC ± .415	331 PLC ± .415
332 PLC ± .420	333 PLC ± .420	334 PLC ± .420	335 PLC ± .420
336 PLC ± .425	337 PLC ± .425	338 PLC ± .425	339 PLC ± .425
340 PLC ± .430	341 PLC ± .430	342 PLC ± .430	343 PLC ± .430
344 PLC ± .435	345 PLC ± .435	346 PLC ± .435	347 PLC ± .435
348 PLC ± .440	349 PLC ± .440	350 PLC ± .440	351 PLC ± .440
352 PLC ± .445	353 PLC ± .445	354 PLC ± .445	355 PLC ± .445
356 PLC ± .450	357 PLC ± .450	358 PLC ± .450	359 PLC ± .450
360 PLC ± .455	361 PLC ± .455	362 PLC ± .455	363 PLC ± .455
364 PLC ± .460	365 PLC ± .460	366 PLC ± .460	367 PLC ± .460
368 PLC ± .465	369 PLC ± .465	370 PLC ± .465	371 PLC ± .465
372 PLC ± .470	373 PLC ± .470	374 PLC ± .470	375 PLC ± .470
376 PLC ± .475	377 PLC ± .475	378 PLC ± .475	379 PLC ± .475
380 PLC ± .480	381 PLC ± .480	382 PLC ± .480	383 PLC ± .480
384 PLC ± .485	385 PLC ± .485	386 PLC ± .485	387 PLC ± .485
388 PLC ± .490	389 PLC ± .490	390 PLC ± .490	391 PLC ± .490
392 PLC ± .495	393 PLC ± .495	394 PLC ± .495	395 PLC ± .495
396 PLC ± .500	397 PLC ± .500	398 PLC ± .500	399 PLC ± .500
400 PLC ± .505	401 PLC ± .505	402 PLC ± .505	403 PLC ± .505
404 PLC ± .510	405 PLC ± .510	406 PLC ± .510	407 PLC ± .510
408 PLC ± .515	409 PLC ± .515	410 PLC ± .515	411 PLC ± .515
412 PLC ± .520	413 PLC ± .520	414 PLC ± .520	415 PLC ± .520
416 PLC ± .525	417 PLC ± .525	418 PLC ± .525	419 PLC ± .525
420 PLC ± .530	421 PLC ± .530	422 PLC ± .530	423 PLC ± .530
424 PLC ± .535	425 PLC ± .535	426 PLC ± .535	427 PLC ± .535
428 PLC ± .540	429 PLC ± .540	430 PLC ± .540	431 PLC ± .540
432 PLC ± .545	433 PLC ± .545	434 PLC ± .545	435 PLC ± .545
436 PLC ± .550	437 PLC ± .550	438 PLC ± .550	439 PLC ± .550
440 PLC ± .555	441 PLC ± .555	442 PLC ± .555	443 PLC ± .555
444 PLC ± .560	445 PLC ± .560	446 PLC ± .560	447 PLC ± .560
448 PLC ± .565	449 PLC ± .565	450 PLC ± .565	451 PLC ± .565
452 PLC ± .570	453 PLC ± .570	454 PLC ± .570	455 PLC ± .570
456 PLC ± .575	457 PLC ± .575	458 PLC ± .575	459 PLC ± .575
460 PLC ± .580	461 PLC ± .580	462 PLC ± .580	463 PLC ± .580
464 PLC ± .585	465 PLC ± .585	466 PLC ± .585	467 PLC ± .585
468 PLC ± .590	469 PLC ± .590	470 PLC ± .590	471 PLC ± .590
472 PLC ± .595	473 PLC ± .595	474 PLC ± .595	475 PLC ± .595
476 PLC ± .600	477 PLC ± .600	478 PLC ± .600	479 PLC ± .600
480 PLC ± .605	481 PLC ± .605	482 PLC ± .605	483 PLC ± .605
484 PLC ± .610	485 PLC ± .610	486 PLC ± .610	487 PLC ± .610
488 PLC ± .615	489 PLC ± .615	490 PLC ± .615	491 PLC ± .615
492 PLC ± .620	493 PLC ± .620	494 PLC ± .620	495 PLC ± .620
496 PLC ± .625	497 PLC ± .625	498 PLC ± .625	499 PLC ± .625
500 PLC ± .630	501 PLC ± .630	502 PLC ± .630	503 PLC ± .630
504 PLC ± .635	505 PLC ± .635	506 PLC ± .635	507 PLC ± .635
508 PLC ± .640	509 PLC ± .640	510 PLC ± .640	511 PLC ± .640
512 PLC ± .645	513 PLC ± .645	514 PLC ± .645	515 PLC ± .645
516 PLC ± .650	517 PLC ± .650	518 PLC ± .650	519 PLC ± .650
520 PLC ± .655	521 PLC ± .655	522 PLC ± .655	523 PLC ± .655
524 PLC ± .660	525 PLC ± .660	526 PLC ± .660	527 PLC ± .660
528 PLC ± .665	529 PLC ± .665	530 PLC ± .665	531 PLC ± .665
532 PLC ± .670	533 PLC ± .670	534 PLC ± .670	535 PLC ± .670
536 PLC ± .675			