

4

3

2

1

THIS DRAWING IS UNPUBLISHED. RELEASED FOR PUBLICATION. ALL RIGHTS RESERVED.

LOC	DIST	REVISIONS			
F	LNK	DESCRIPTION	DATE	BY	APPD
CM	54	T2	REVISED PER ECO-11-004917	11MAR11	RK HMR

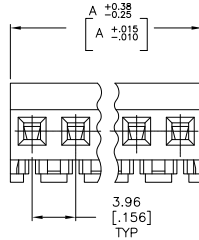
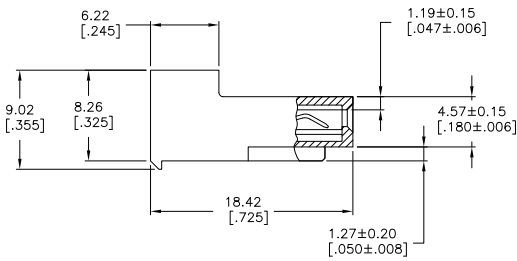
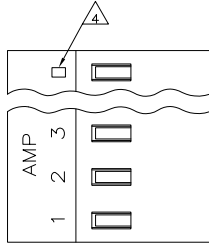

1 MATERIAL: CONNECTOR - NYLON UL94V-2 (BLUE).
 CONTACTS - 0.30[.012] THICK COPPER ALLOY
 BRIGHT TIN-LEAD 0.00203[.000080] MIN THICK
 FOR CONTACT 640435-2 THRU 2-640435-4
 MATTIE WHISKER MITIGATED TIN 0.00203[.000080]
 MIN THICKNESS OVER NICKEL UNDERPLATE FOR
 3-640435-2 THRU 5-640435-4

2. CONTACTS ACCEPT 26 AWG WIRE WITH 2.41[.095] MAX INSULATION DIAMETER.

3. CONTACTS MUST ACCEPT 1.14±0.03[.045±.001] SQUARE POST AND REMAIN LOCKED IN POSITION.

4 IDENTIFICATION NUMBER FOR LAST CIRCUIT MAY NOT APPEAR ON ALL ASSEMBLIES.

5. DIMENSIONS IN BRACKETS ARE IN INCHES.

6. HOUSING FEATURES ARE: CLOSED END WITHOUT LOCKING RAMP.

7 OBSOLETE PARTS: OBSOLETE CIS STREAMLINING PER D.RENAUD/D.SINISI

95.10	[3.744]	24	5-640435-4
91.14	[3.588]	23	5-640435-3
87.17	[3.432]	22	5-640435-2
83.21	[3.276]	21	5-640435-1
79.25	[3.120]	20	5-640435-0
75.29	[2.964]	19	4-640435-9
71.32	[2.808]	18	4-640435-8
67.36	[2.652]	17	4-640435-7
63.40	[2.496]	16	4-640435-6
59.44	[2.340]	15	4-640435-5
55.47	[2.184]	14	4-640435-4
51.51	[2.028]	13	4-640435-3
47.55	[1.872]	12	4-640435-2
43.59	[1.716]	11	4-640435-1
39.62	[1.560]	10	4-640435-0
35.66	[1.404]	9	3-640435-9
31.70	[1.248]	8	3-640435-8
27.74	[1.092]	7	3-640435-7
23.77	[.936]	6	3-640435-6
19.81	[.780]	5	3-640435-5
15.85	[.624]	4	3-640435-4
11.89	[.468]	3	3-640435-3
7.92	[.312]	2	3-640435-2
95.10	[3.744]	24	2-640435-4
91.14	[3.588]	23	2-640435-3
87.17	[3.432]	22	2-640435-2
83.21	[3.276]	21	2-640435-1
79.25	[3.120]	20	2-640435-0
75.29	[2.964]	19	1-640435-9
71.32	[2.808]	18	1-640435-8
67.36	[2.652]	17	1-640435-7
63.40	[2.496]	16	1-640435-6
59.44	[2.340]	15	1-640435-5
55.47	[2.184]	14	1-640435-4
51.51	[2.028]	13	1-640435-3
47.55	[1.872]	12	1-640435-2
43.59	[1.716]	11	1-640435-1
39.62	[1.560]	10	1-640435-0
35.66	[1.404]	9	640435-9
31.70	[1.248]	8	640435-8
27.74	[1.092]	7	640435-7
23.77	[.936]	6	640435-6
19.81	[.780]	5	640435-5
15.85	[.624]	4	640435-4
11.89	[.468]	3	640435-3
7.92	[.312]	2	640435-2

ASUPERSEDED BY 5-640435-4
 ASUPERSEDED BY 5-640435-3
 ASUPERSEDED BY 5-640435-2
 ASUPERSEDED BY 5-640435-1
 ASUPERSEDED BY 5-640435-0
 ASUPERSEDED BY 4-640435-9
 ASUPERSEDED BY 4-640435-8
 ASUPERSEDED BY 4-640435-7
 ASUPERSEDED BY 4-640435-6
 ASUPERSEDED BY 4-640435-5
 ASUPERSEDED BY 4-640435-4
 ASUPERSEDED BY 4-640435-3
 ASUPERSEDED BY 4-640435-2
 ASUPERSEDED BY 4-640435-1
 ASUPERSEDED BY 4-640435-0
 ASUPERSEDED BY 3-640435-9
 ASUPERSEDED BY 3-640435-8
 ASUPERSEDED BY 3-640435-7
 ASUPERSEDED BY 3-640435-6
 ASUPERSEDED BY 3-640435-5
 ASUPERSEDED BY 3-640435-4
 ASUPERSEDED BY 3-640435-3
 ASUPERSEDED BY 3-640435-2

DIM A NO OF CIRCUITS PART NO

THIS DRAWING IS A CONTROLLED DOCUMENT.

DIMENSIONS: mm [INCHES]	TOLERANCES UNLESS OTHERWISE SPECIFIED:	DRW: SLEWIS 12-2-91	CHK: SLEWIS 12-2-91	APPD: R. SWING 12-2-91	DATE: 12-2-91	NAME: D. CLARK	TE Connectivity
0 P.L.C. ± .01	1 P.L.C. ± .02	2 P.L.C. ± .03	3 P.L.C. ± .04	4 P.L.C. ± .05	5 P.L.C. ± .06	6 P.L.C. ± .07	TE Connectivity
MATERIAL: NYLON						MTA-156 CONNECTOR ASSEMBLY, 26 AWG, STANDARD	
FINISH: POLISHED						SIZE: CASE CODE: DRAWING NO: A2 00779 ©=640435	
CUSTOMER DRAWING						RESTRICTED TO: T2	

METRIC