

4

3

2

1

THIS DRAWING IS UNPUBLISHED. RELEASED FOR PUBLICATION
 © copyright - By - ALL RIGHTS RESERVED.

LOC	DIST	REVISIONS			
F	LTR	DESCRIPTION	DATE	OWN	APP
CM	54				
	P2	REVISED PER ECO-11-005027	11MAR11	RK	HMR

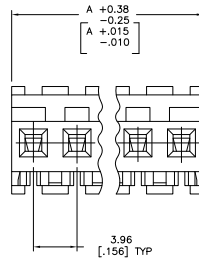
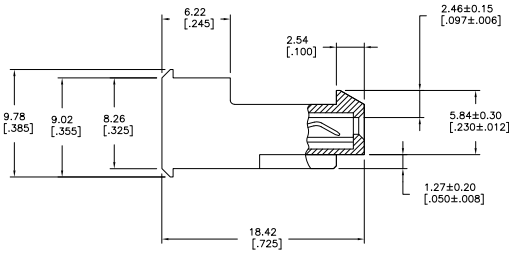
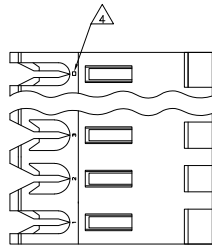

95.10 [3.744]	24	5-640595-4
91.14 [3.588]	23	5-640595-3
87.17 [3.432]	22	5-640595-2
83.21 [3.276]	21	5-640595-1
79.25 [3.120]	20	5-640595-0
75.29 [2.964]	19	4-640595-9
71.32 [2.808]	18	4-640595-8
67.36 [2.652]	17	4-640595-7
63.40 [2.496]	16	4-640595-6
59.44 [2.340]	15	4-640595-5
55.47 [2.184]	14	4-640595-4
51.51 [2.028]	13	4-640595-3
47.55 [1.872]	12	4-640595-2
43.59 [1.716]	11	4-640595-1
39.62 [1.560]	10	4-640595-0
35.66 [1.404]	9	3-640595-9
31.70 [1.248]	8	3-640595-8
27.74 [1.092]	7	3-640595-7
23.77 [.936]	6	3-640595-6
19.81 [.780]	5	3-640595-5
15.85 [.624]	4	3-640595-4
11.89 [.468]	3	3-640595-3
7.92 [.312]	2	3-640595-2
95.10 [3.744]	24	2-640595-4
91.14 [3.588]	23	2-640595-3
87.17 [3.432]	22	2-640595-2
83.21 [3.276]	21	2-640595-1
79.25 [3.120]	20	2-640595-0
75.29 [2.964]	19	1-640595-9
71.32 [2.808]	18	1-640595-8
67.36 [2.652]	17	1-640595-7
63.40 [2.496]	16	1-640595-6
59.44 [2.340]	15	1-640595-5
55.47 [2.184]	14	1-640595-4
51.51 [2.028]	13	1-640595-3
47.55 [1.872]	12	1-640595-2
43.59 [1.716]	11	1-640595-1
39.62 [1.560]	10	1-640595-0
35.66 [1.404]	9	640595-9
31.70 [1.248]	8	640595-8
27.74 [1.092]	7	640595-7
23.77 [.936]	6	640595-6
19.81 [.780]	5	640595-5
15.85 [.624]	4	640595-4
11.89 [.468]	3	640595-3
7.92 [.312]	2	640595-2

- △ SUPERSEDED BY 5-640595-4
- △ SUPERSEDED BY 5-640595-3
- △ SUPERSEDED BY 5-640595-2
- △ SUPERSEDED BY 5-640595-1
- △ SUPERSEDED BY 5-640595-0
- △ SUPERSEDED BY 4-640595-9
- △ SUPERSEDED BY 4-640595-8
- △ SUPERSEDED BY 4-640595-7
- △ SUPERSEDED BY 4-640595-6
- △ SUPERSEDED BY 4-640595-5
- △ SUPERSEDED BY 4-640595-4
- △ SUPERSEDED BY 4-640595-3
- △ SUPERSEDED BY 4-640595-2
- △ SUPERSEDED BY 4-640595-1
- △ SUPERSEDED BY 4-640595-0
- △ SUPERSEDED BY 3-640595-9
- △ SUPERSEDED BY 3-640595-8
- △ SUPERSEDED BY 3-640595-7
- △ SUPERSEDED BY 3-640595-6
- △ SUPERSEDED BY 3-640595-5
- △ SUPERSEDED BY 3-640595-4
- △ SUPERSEDED BY 3-640595-3

- △ MATERIAL: CONNECTOR - NYLON UL94V-2 (BLUE)
 CONTACTS - 0.30[.012] THICK COPPER ALLOY
 (BRIGHT TIN-LEAD 0.00203[.000080] MIN. THICK
 FOR CONTACTS 640595-2 THRU 2-640595-4]
 (MATTE WHISKER MITIGATED TIN 0.00203[.000080] MIN
 THICKNESS OVER NICKEL UNDERPLATE FOR
 3-640595-2 THRU 5-640595-4).
- 2. CONTACTS ACCEPT 26 AWG WIRE WITH 2.41[.095] MAX INSULATION DIAMETER.
- 3. CONTACTS MUST ACCEPT 1.14±0.03[.045±.001] SQUARE POST AND REMAIN LOCKED IN POSITION.
- △ IDENTIFICATION NUMBER FOR LAST CIRCUIT MAY NOT APPEAR ON ALL ASSEMBLIES.
- 5. DIMENSIONS IN BRACKETS ARE IN INCHES.
- 6. HOUSING FEATURES ARE: FEED-THRU WITH LOCKING RAMP.
- △ OBSOLETE PARTS: OBSOLETE CIS STREAMLINING PER D.RENAUD/D.SINISI

THIS DRAWING IS A CONTROLLED DOCUMENT. **TE** TE Connectivity

DRN: S. LEWIS 12FEB11
 CHK: R. SWING 12FEB11
 D: D. CLARK
 PROD: 108-1051
 APPLICATION SPEC: 114-1020
 WEIGHT: -

DIMENSIONS: mm [INCHES]
 TOLERANCES UNLESS OTHERWISE SPECIFIED:
 0 PLG ± .010
 1 PLG ± .010
 2 PLG ± .010
 3 PLG ± .010
 4 PLG ± .010
 ANGLES ± .010

MATERIAL: △ FINISH: △

CUSTOMER DRAWING SCALE: 4:1 SHEET: 1 of 1 REV: P2

RESTRICTED TO: -



640595

A

D

C

B

A

A

P2