

4

3

2

1

THIS DRAWING IS UNPUBLISHED. RELEASED FOR PUBLICATION. ALL RIGHTS RESERVED.

LOC	DIST	REVISIONS			
F	LNK	DESCRIPTION	DATE	BY	APPD
CM	OO	T3	REVISED PER ECO-11-004917	11MAR11	RK HMR

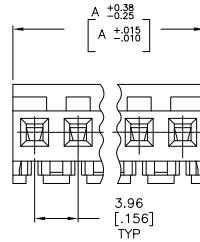
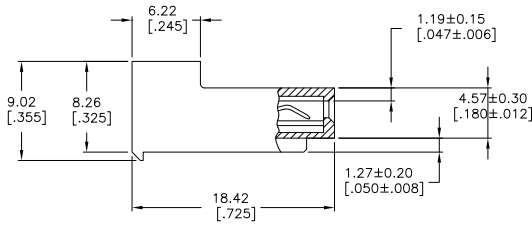
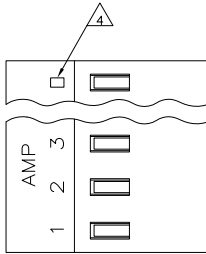

95.10 [3.744]	24	5-640432-4
91.13 [3.588]	23	5-640432-3
87.17 [3.432]	22	5-640432-2
83.21 [3.276]	21	5-640432-1
79.25 [3.120]	20	5-640432-0
75.29 [2.964]	19	4-640432-9
71.32 [2.808]	18	4-640432-8
67.36 [2.652]	17	4-640432-7
63.40 [2.496]	16	4-640432-6
59.44 [2.340]	15	4-640432-5
55.47 [2.184]	14	4-640432-4
51.51 [2.028]	13	4-640432-3
47.55 [1.872]	12	4-640432-2
43.59 [1.716]	11	4-640432-1
39.62 [1.560]	10	4-640432-0
35.66 [1.404]	9	3-640432-9
31.70 [1.248]	8	3-640432-8
27.74 [1.092]	7	3-640432-7
23.77 [936]	6	3-640432-6
19.81 [780]	5	3-640432-5
15.85 [624]	4	3-640432-4
11.89 [468]	3	3-640432-3
7.92 [312]	2	3-640432-2
95.10 [3.744]	24	2-640432-4
91.13 [3.588]	23	2-640432-3
87.17 [3.432]	22	2-640432-2
83.21 [3.276]	21	2-640432-1
79.25 [3.120]	20	1-640432-0
75.29 [2.964]	19	1-640432-9
71.32 [2.808]	18	1-640432-8
67.36 [2.652]	17	1-640432-7
63.40 [2.496]	16	1-640432-6
59.44 [2.340]	15	1-640432-5
55.47 [2.184]	14	1-640432-4
51.51 [2.028]	13	1-640432-3
47.55 [1.872]	12	1-640432-2
43.59 [1.716]	11	1-640432-1
39.62 [1.560]	10	1-640432-0
35.66 [1.404]	9	640432-9
31.70 [1.248]	8	640432-8
27.74 [1.092]	7	640432-7
23.77 [936]	6	640432-6
19.81 [780]	5	640432-5
15.85 [624]	4	640432-4
11.89 [468]	3	640432-3
7.92 [312]	2	640432-2
DIM A	NO. OF CIRCUITS	PART NO.

△ MATERIAL: CONNECTOR - NYLON UL94-V2 (YELLOW)  
 CONTACTS - 0.30[.012] THICK COPPER ALLOY  
 (BRIGHT TIN-LEAD 0.00203[.000080] MIN. THICK  
 FOR CONTACTS 640432-2 THRU 2-640432-4).  
 (MATTE WHISKER MITIGATED TIN 0.00203[.000080] MIN.  
 THICKNESS OVER NICKEL UNDERPLATE FOR 3-640432-2  
 THRU 5-640432-4).

- CONTACTS ACCEPT 20 AWG WIRE WITH 2.41[.095] MAX INSULATION DIAMETER.
- CONTACTS MUST ACCEPT 1.14±0.03[.045] POST AND REMAIN LOCKED IN POSITION.
- IDENTIFICATION NUMBER FOR LAST CIRCUIT MAY NOT APPEAR ON ALL ASSEMBLIES.
- DIMENSIONS IN BRACKETS ARE IN INCHES.
- HOUSING FEATURES ARE: CLOSED END WITH LOCKING RAMP.
- OBsolete PARTS: OBSOLETE CIS STREAMLINING PER D.RENAUD/D.SINISI

THIS DRAWING IS A CONTROLLED DOCUMENT.

DRW S. CARPENTER 13AUG2003	CHK D. BOSSI 13AUG2003	DATE	NO. OF CIRCUITS	PART NO.
DIMENSIONS: mm [INCHES]		PRODUCT SPEC: 108-1051	SIZE: A2	CAGE CODE: 00779
TOLERANCES UNLESS OTHERWISE SPECIFIED:		APPLICATION SPEC: 114-1020	SCALE: 4:1	SHEET: 1 of 1
MATERIAL: △		WEIGHT: -	CUSTOMER DRAWING	RESTRICTED TO: -
FINISH: △		TE Connectivity MTA 156 CONNECTOR ASSEMBLY, 20 AWG, STANDARD		



640432

A

D

C

B

A

T3