

1. MATERIAL: CONNECTOR-NYLON UL94V-2 (WHITE).
 CONTACTS-0.30 [.012] THICK COPPER ALLOY
 BRIGHT TIN-LEAD 0.00203 [.000080] MINIMUM THICK FOR CONTACTS
 641535-2 THRU 641535-6,
 MATTE WHISKER MITIGATED TIN PLATE 0.00203 [.000080] MINIMUM THICK OVER
 NICKEL UNDERPLATE FOR CONTACTS 3-641535-2 THRU 3-641535-6.
2. CONTACTS ACCEPT 24 AWG WIRE WITH 1.52 [.060] MAXIMUM INSULATION DIAMETER.
3. CONTACTS MUST ACCEPT 0.36-0.51 [.014-.020] SQUARE OR ROUND POST AND REMAINED LOCKED IN POSITION.
4. IDENTIFICATION NUMBER FOR LAST CIRCUIT MAY NOT APPEAR ON ALL ASSEMBLIES.
5. DIMENSIONS IN BRACKETS ARE IN INCHES.
6. HOUSING FEATURES ARE: CLOSED END WITH LOCKING RAMP & LED CONTACT.
- OBsolete PARTS: OBSOLETE CIS STREAMLINING PER D.RENAUD/D.SINISI

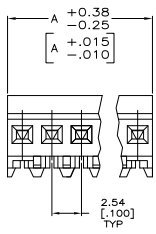
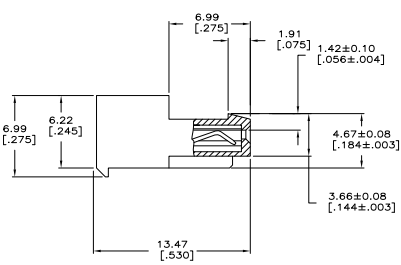
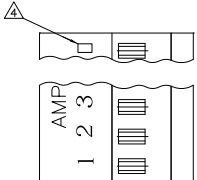

LEAD FREE	15.24	[.600]	6	3-641535-6
	12.70	[.500]	5	3-641535-5
	7.62	[.300]	3	3-641535-3
	5.08	[.200]	2	3-641535-2
	DIM A		NO.OF POSN	ASSEMBLY

CONTAINS LEAD	15.24	[.600]	6	641535-6
	12.70	[.500]	5	641535-5
	7.62	[.300]	3	641535-3
	5.08	[.200]	2	641535-2
	DIM A		NO.OF POSN	ASSEMBLY

~~△ SUPERSEDED~~
~~△ SUPERSEDED~~



THIS DRAWING IS A CONTROLLED DOCUMENT. DATE: 10-02-2004
 BY: HOOVER
 CHECKED BY: BOSSI
 APPROVED BY: BOSSI
 DRAWING NO: 108-1050
 OPERATOR SPEC: 114-1019
 DATE: 10-02-2004
 DRAWING NO: A100779
 CUSTOMER DRAWING: G=641535

TE Connectivity
 MTA-100 CONNECTOR ASSEMBLY,
 24 AWG, FOR .014 TO .020 POST, SPECIAL

REWORKED TO: 114-1019

SCALE: 5:1 SHEET: 1 OF 1 REV: N2