

4

3

2

1

THIS DRAWING IS UNPUBLISHED. RELEASED FOR PUBLICATION. ALL RIGHTS RESERVED.

LOC	DIST	REVISIONS					
CM	00	F	LR	DESCRIPTION	DATE	BY	APPD
		L2		REVISED PER ECO-11-004587	11MAR11	RK	HMR

YES	71.12	[2.800]	28	5-643816-8
YES	68.58	[2.700]	27	5-643816-7
YES	66.04	[2.600]	26	5-643816-6
YES	63.50	[2.500]	25	5-643816-5
YES	60.96	[2.400]	24	5-643816-4
YES	58.42	[2.300]	23	5-643816-3
YES	55.88	[2.200]	22	5-643816-2
YES	53.34	[2.100]	21	5-643816-1
YES	50.80	[2.000]	20	5-643816-0
YES	48.26	[1.900]	19	4-643816-9
YES	45.72	[1.800]	18	4-643816-8
YES	43.18	[1.700]	17	4-643816-7
YES	40.64	[1.600]	16	4-643816-6
YES	38.10	[1.500]	15	4-643816-5
YES	35.56	[1.400]	14	4-643816-4
YES	33.02	[1.300]	13	4-643816-3
YES	30.48	[1.200]	12	4-643816-2
YES	27.94	[1.100]	11	4-643816-1
YES	25.40	[1.000]	10	4-643816-0
YES	22.86	[.900]	9	3-643816-9
YES	20.32	[.800]	8	3-643816-8
YES	17.78	[.700]	7	3-643816-7
YES	15.24	[.600]	6	3-643816-6
YES	12.70	[.500]	5	3-643816-5
YES	10.16	[.400]	4	3-643816-4
YES	7.62	[.300]	3	3-643816-3
YES	5.08	[.200]	2	3-643816-2

NO	71.12	[2.800]	28	2-643816-8	SUPERCEDED
NO	68.58	[2.700]	27	2-643816-7	SUPERCEDED
NO	66.04	[2.600]	26	2-643816-6	SUPERCEDED
NO	63.50	[2.500]	25	2-643816-5	SUPERCEDED
NO	60.96	[2.400]	24	2-643816-4	SUPERCEDED
NO	58.42	[2.300]	23	2-643816-3	SUPERCEDED
NO	55.88	[2.200]	22	2-643816-2	SUPERCEDED
NO	53.34	[2.100]	21	2-643816-1	SUPERCEDED
NO	50.80	[2.000]	20	2-643816-0	SUPERCEDED
NO	48.26	[1.900]	19	1-643816-9	SUPERCEDED
NO	45.72	[1.800]	18	1-643816-8	SUPERCEDED
NO	43.18	[1.700]	17	1-643816-7	SUPERCEDED
NO	40.64	[1.600]	16	1-643816-6	SUPERCEDED
NO	38.10	[1.500]	15	1-643816-5	
NO	35.56	[1.400]	14	1-643816-4	
NO	33.02	[1.300]	13	1-643816-3	SUPERCEDED
NO	30.48	[1.200]	12	1-643816-2	
NO	27.94	[1.100]	11	1-643816-1	
NO	25.40	[1.000]	10	1-643816-0	
NO	22.86	[.900]	9	643816-9	SUPERCEDED
NO	20.32	[.800]	8	643816-8	
NO	17.78	[.700]	7	643816-7	
NO	15.24	[.600]	6	643816-6	
NO	12.70	[.500]	5	643816-5	
NO	10.16	[.400]	4	643816-4	
NO	7.62	[.300]	3	643816-3	
NO	5.08	[.200]	2	643816-2	
LEADFREE	DIM A		NO. OF CIRCUITS	PART NO.	

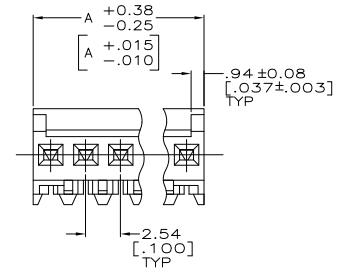
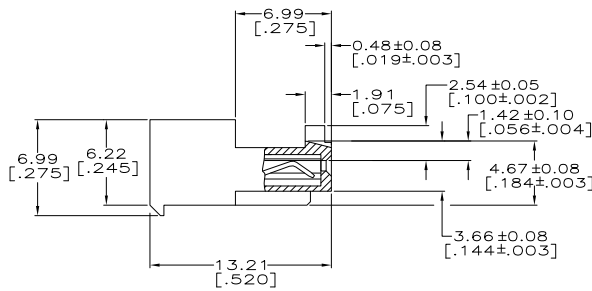
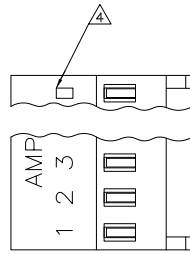

- 1. MATERIAL: CONNECTOR - NYLON UL94V-2 (GREEN). CONTACTS - 0.30[.012] THICK COPPER ALLOY BRIGHT TIN-LEAD .00203[.000080] MIN THICKNESS FOR 643816-2 THRU 2-643816-8. MATTE WHISKER MITIGATED TIN .00203[.000080] MIN THICKNESS OVER NICKEL UNDERPLATE FOR 3-643816-2 THRU 5-643816-8.
- 2. CONTACTS ACCEPT 28 AWG WIRE WITH 1.52[.060] MAX INSULATION DIAMETER.
- 3. CONTACTS MUST ACCEPT 0.64±0.03[.025] POST AND REMAIN LOCKED IN POSITION.
- 4. IDENTIFICATION NUMBER FOR LAST CIRCUIT MAY NOT APPEAR ON ALL ASSEMBLIES.
- 5. DIMENSIONS IN BRACKETS ARE IN INCHES.
- 6. HOUSING FEATURES ARE: CLOSED END WITH LOCKING RAMP AND WITH POLARIZING TAB.

OBsolete PARTS: OBSOLETE CIS STREAMLINING PER D.RENAUD/D.SINISI

METRIC

THIS DRAWING IS A CONTROLLED DOCUMENT.		DWG. S. CARPENTER 11JAN2003		TE Connectivity	
DIMENSIONS: mm [INCHES]		CHK. D. BOSSI 11JAN2003		TE	
TOLERANCES UNLESS OTHERWISE SPECIFIED:		APP. D. BOSSI 11JAN2003		MTA 100 CONNECTOR ASSEMBLY, 28 AWG, STANDARD	
0 PLC ± .010 [0.005]	1 PLC ± .015 [0.006]	PRODUCT SPEC: 108-1050		APPLICATION SPEC: 114-1019	
2 PLC ± .015 [0.006]	3 PLC ± .015 [0.006]	WEIGHT: A2		SIZE: 00779	
4 PLC ± .015 [0.006]	ANGLES: °	CUSTOMER DRAWING		SCALE: 5:1 SHEET: 1 of 1 REV: L2	
MATERIAL: △	FINISH: △				