

4

3

2

1

THIS DRAWING IS UNPUBLISHED. RELEASED FOR PUBLICATION. ALL RIGHTS RESERVED.

LOC	DIST	REVISIONS			
F	LR	DESCRIPTION	DATE	BY	APPD
CM	00	REVISED PER ECO-11-004587	11MAR11	RK	HMR

YES	71.12	[2.800]	28	5-643814-8
YES	68.58	[2.700]	27	5-643814-7
YES	66.04	[2.600]	26	5-643814-6
YES	63.50	[2.500]	25	5-643814-5
YES	60.96	[2.400]	24	5-643814-4
YES	58.42	[2.300]	23	5-643814-3
YES	55.88	[2.200]	22	5-643814-2
YES	53.34	[2.100]	21	5-643814-1
YES	50.80	[2.000]	20	5-643814-0
YES	48.26	[1.900]	19	4-643814-9
YES	45.72	[1.800]	18	4-643814-8
YES	43.18	[1.700]	17	4-643814-7
YES	40.64	[1.600]	16	4-643814-6
YES	38.10	[1.500]	15	4-643814-5
YES	35.56	[1.400]	14	4-643814-4
YES	33.02	[1.300]	13	4-643814-3
YES	30.48	[1.200]	12	4-643814-2
YES	27.94	[1.100]	11	4-643814-1
YES	25.40	[1.000]	10	4-643814-0
YES	22.86	[.900]	9	3-643814-9
YES	20.32	[.800]	8	3-643814-8
YES	17.78	[.700]	7	3-643814-7
YES	15.24	[.600]	6	3-643814-6
YES	12.70	[.500]	5	3-643814-5
YES	10.16	[.400]	4	3-643814-4
YES	7.62	[.300]	3	3-643814-3
YES	5.08	[.200]	2	3-643814-2

NO	71.12	[2.800]	28	2-643814-8	SUPERSEDED BY 5-643814-8
NO	68.58	[2.700]	27	2-643814-7	SUPERSEDED BY 5-643814-7
NO	66.04	[2.600]	26	2-643814-6	SUPERSEDED BY 5-643814-6
NO	63.50	[2.500]	25	2-643814-5	
NO	60.96	[2.400]	24	2-643814-4	SUPERSEDED BY 5-643814-4
NO	58.42	[2.300]	23	2-643814-3	SUPERSEDED BY 5-643814-3
NO	55.88	[2.200]	22	2-643814-2	SUPERSEDED BY 5-643814-2
NO	53.34	[2.100]	21	2-643814-1	SUPERSEDED BY 5-643814-1
NO	50.80	[2.000]	20	2-643814-0	
NO	48.26	[1.900]	19	1-643814-9	SUPERSEDED BY 4-643814-9
NO	45.72	[1.800]	18	1-643814-8	
NO	43.18	[1.700]	17	1-643814-7	SUPERSEDED BY 4-643814-7
NO	40.64	[1.600]	16	1-643814-6	
NO	38.10	[1.500]	15	1-643814-5	
NO	35.56	[1.400]	14	1-643814-4	
NO	33.02	[1.300]	13	1-643814-3	
NO	30.48	[1.200]	12	1-643814-2	
NO	27.94	[1.100]	11	1-643814-1	
NO	25.40	[1.000]	10	1-643814-0	
NO	22.86	[.900]	9	643814-9	
NO	20.32	[.800]	8	643814-8	
NO	17.78	[.700]	7	643814-7	
NO	15.24	[.600]	6	643814-6	
NO	12.70	[.500]	5	643814-5	
NO	10.16	[.400]	4	643814-4	
NO	7.62	[.300]	3	643814-3	
NO	5.08	[.200]	2	643814-2	
LEADFREE	DIM A		NO. OF CIRCUITS	PART NO.	

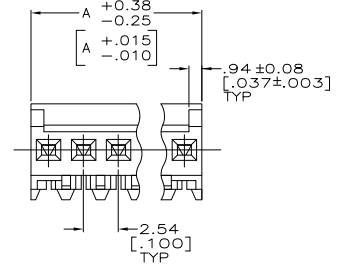
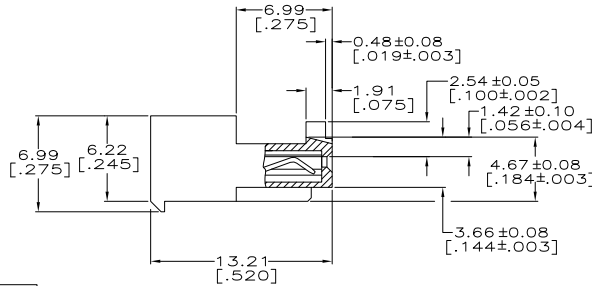
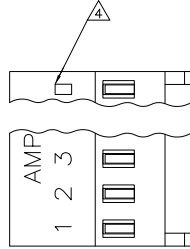

⚠ MATERIAL: CONNECTOR - NYLON UL94V-2 (WHITE).  
 CONTACTS - 0.30[.012] THICK COPPER ALLOY BRIGHT TIN-LEAD .00203[.000080] MIN THICKNESS FOR 643814-2 THRU 2-643814-8.  
 MATTE WHISKER MITIGATED TIN .00203[.000080] MIN THICKNESS OVER NICKEL UNDERPLATE FOR 3-643814-2 THRU 5-643814-8.

- CONTACTS ACCEPT 24 AWG WIRE WITH 1.52[.060] MAX INSULATION DIAMETER.
- CONTACTS MUST ACCEPT 0.64±0.03[.025] POST AND REMAIN LOCKED IN POSITION.

⚠ IDENTIFICATION NUMBER FOR LAST CIRCUIT MAY NOT APPEAR ON ALL ASSEMBLIES.

5. DIMENSIONS IN BRACKETS ARE IN INCHES.

6. HOUSING FEATURES ARE: CLOSED END WITH LOCKING RAMP AND WITH POLARIZING TAB.

⚠ OBSOLETE PARTS: OBSOLETE CIS STREAMLINING PER D.RENAUD/D.SINISI

**METRIC**

THIS DRAWING IS A CONTROLLED DOCUMENT.		DRN S. CARPENTER 11JAN2003	<b>TE</b> TE Connectivity
DIMENSIONS: mm [INCHES]		CHK D. BOSSI 11JAN2003	
TOLERANCES UNLESS OTHERWISE SPECIFIED:		APPD D. BOSSI 11JAN2003	NAME
0 P.L.C.	± .010 [0.001]	PRODUCT SPEC	108-1050
1 P.L.C.	± .015 [0.001]	APPLICATION SPEC	114-1019
2 P.L.C.	± .020 [0.002]	WEIGHT	A2 00779 C=643814
3 P.L.C.	± .030 [0.003]	SIZE	00779 C=643814
4 P.L.C.	± .040 [0.004]	SCALE	5:1
ANGLES	± .010 [0.001]	SHEET	1 of 1
FINISH		REV	J2
MATERIAL		CUSTOMER DRAWING	

643814

A

J2