

4

3

2

1

THIS DRAWING IS UNPUBLISHED. RELEASED FOR PUBLICATION
 © COPYRIGHT - By - ALL RIGHTS RESERVED.

LOC	DIST	REVISIONS					
BD	48	P	LTR	DESCRIPTION	DATE	BY	APPD
		C1		REVISED PER ECO-11-004835	11MAR11	RK	HMR

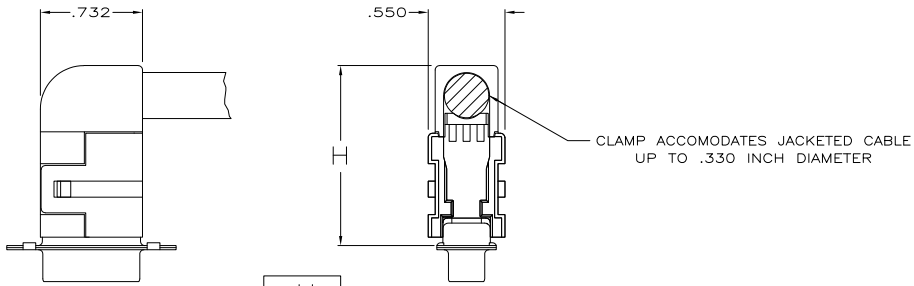
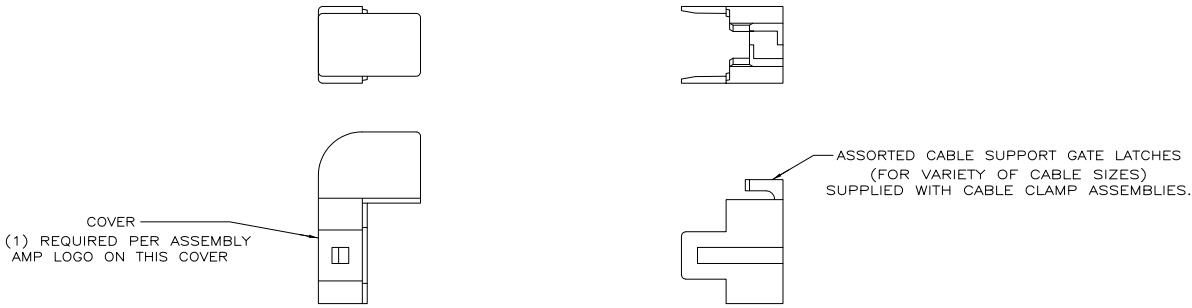

	H
PLUG	1.290
RECEPTACLE	1.241

- 1 ALL PARTS ARE PACKAGED UNASSEMBLED.
- 2 COVERS FIT HDE -20 TYPE CONNECTORS, BOTH PLASTIC & METAL SHELL ASSEMBLIES.
- 3 SIZE NUMBER MOLDED ON ALL PARTS.
- 4 PARTS ASSEMBLE WITHOUT HARDWARE.
- 5 KIT CONSISTS OF 1 COVER & 1 GATE LATCH ASSORTMENT.
- 6 SAME AS -1 EXCEPT, EACH PART IS INDIVIDUALLY BULK PACKED FOR MULTIPLE KIT ORDERS.

OBSOLETE	745550-2
	745550-1
PACKAGING	PART NUMBER

THIS DRAWING IS A CONTROLLED DOCUMENT.

DESIGNED BY: A. STAUB, BG 5/7/90	DATE: 5/7/90
CHECKED BY: S. LENSER 6-15-90	DATE: 6-15-90
APPROVED BY: J.L. WESTMAN 7-9-90	DATE: 7-9-90
PRODUCT SPEC: -	NAME: J.L. WESTMAN
APPLICATION SPEC: -	SIZE: A2
WEIGHT: -	CAGE CODE: 00779
MATERIAL: BLACK THERMOPLASTIC	FINISH: -
CUSTOMER DRAWING	

TE Connectivity
 KIT, LOW PROFILE, 90DEG CABLE CLAMP, SIZE 1, 9 POSITION, AMPLIMITE HDE-20

RESTRICTED TO: -
 SCALE: 2:1 SHEET: 1 of 1 REV: C1