

4

3

2

1

THIS DRAWING IS UNPUBLISHED. RELEASED FOR PUBLICATION. ALL RIGHTS RESERVED. © COPYRIGHT 2008 By -

LOC	DIST	REVISIONS		
P	LTR	DESCRIPTION	DATE	BY
GP	00			
P		REVISED PER ECO-11-004835	11MAR11	RK HMR

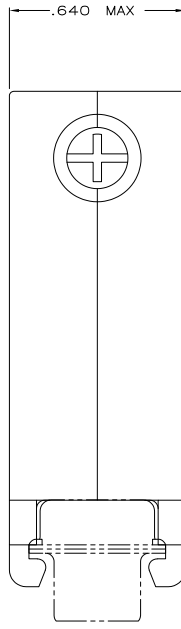
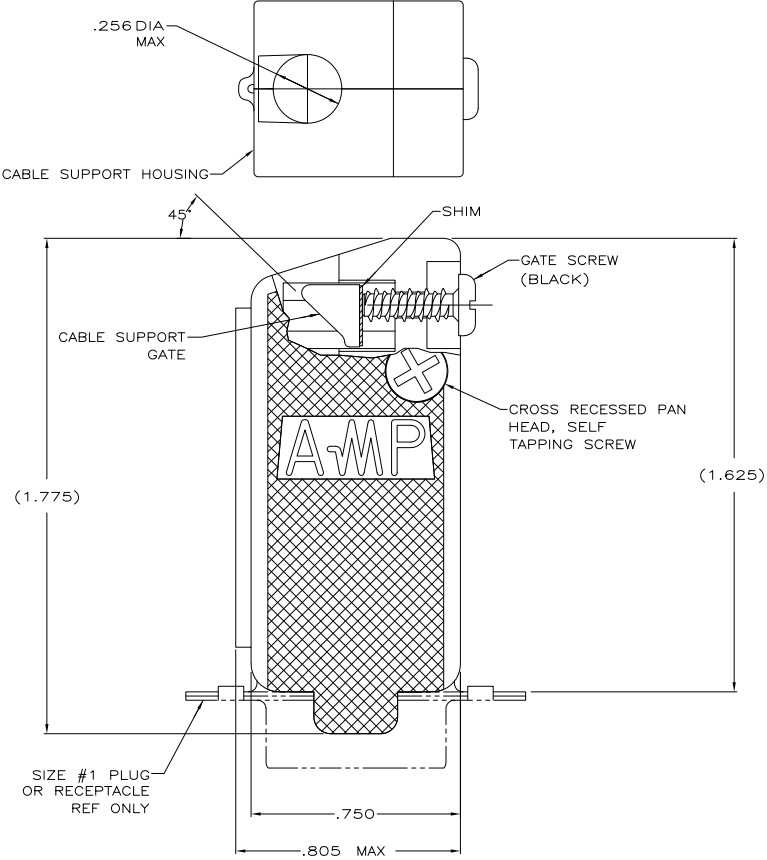

- 1. PARTS PACKAGED UNASSEMBLED.
- △ COMPONENTS INDIVIDUALLY BULK PACKED & SHIPPED AS A UNIT PACKAGE KIT.
- △ MOLDED PARTS: POLYPROPYLENE, BLACK  
SHIM: BRASS  
SCREWS: COLD ROLLED STEEL
- △ GATE SCREWS: BLACK ZINC PHOSPHATE,  
SELF-TAPPING SCREWS: ZINC PLATED CLEAR CHROMATE COATING.

COMBINATION DRIVE	△ 2	5205729-3
COMBINATION DRIVE	AS SHOWN	5205729-1
SCREW VERSION	PACKAGING	PART NUMBER

THIS DRAWING IS A CONTROLLED DOCUMENT.

DESIGNED BY: R. RICHARDSON 22AU005	DATE: 22AU05	TE Connectivity
CHECKED BY: R. ROHDE 22AU05	DATE: 22AU05	
APPROVED BY: M. WALMSLEY 22AU005	DATE: 22AU05	
PRODUCT SPEC: ---	APPLICATION SPEC: ---	SIZE: A2
MATERIAL: △	FINISH: △	SCALE: 4:1
CUSTOMER DRAWING		SHEET: 1 of 1

TE Connectivity  
 SELF TAPPED 45/180 DEG  
 CABLE SUPPORT CLAMHELL, SIZE 1  
 ASSEMBLY, AMPLIMITE HD-20