

Directive 2002/95/EC  
RoHS  
Compliant

used for:  
UNC #4-40 HEX Screw

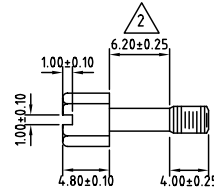

HD 15 M/M GENDER CHANGER PIN OUT

15P Male	15P Male
1	1
2	2
8	8
10	10
15	15
G	G

**SPECIFICATIONS:**

**Material and Finish:**

Insulator: PBT, UL94 V-0 Rated  
Contacts: Brass, Gold over Nickel Plated  
Shell: Steel, Tin Plated  
UNC #4-40 HEX Screw: Brass, Nickel Plated

**Electrical:**

Current Rating: 3 A Max.  
Insulation Resistance: 1000 Mohms Min. @ 500 VDC  
Dielectric Withstanding Voltage: 1000 VAC / 1 Minute  
Operating Temperature: -55°C To +105°C

THESE DRAWINGS MAY NOT BE COPIED OR REPRODUCED IN ANY WAY, AND MAY NOT BE PASSED ON TO A THIRD PARTY WITHOUT WRITTEN PERMISSION FROM CONEC CORPORATION. DO NOT ALTER CAD DRAWING BY HAND	tolerance	finish	scale:
	Decimals: $\pm 0.25$ $\pm 0.15$	Dim. in mm	material: SPECIFICATIONS
	Angles:	2007 date	title: HD 15p Male/Male Gender Changer
		draw. June 28 Vincent Ke	RoHS Compliant
	appd. June 28 J. Chaudry	drawing no.: AutoCAD 2005	DIN A3
	norm.	16K1A1656	sheet 1/1
	d-ols	part no.: DAH1PPAAR04A	
a	origin	<b>CONEC</b>	
rev.	description	date	name