

4

3

2

1

THIS DRAWING IS UNPUBLISHED. RELEASED FOR PUBLICATION
 © COPYRIGHT BY TYCO ELECTRONICS CORPORATION. ALL RIGHTS RESERVED.

LOC	DIST	REVISIONS					
CM	00	P	LTR	DESCRIPTION	DATE	OWN	APPD
		G		REVISED PER EC 0639-0910-04	15-MAR-09	SH	DC

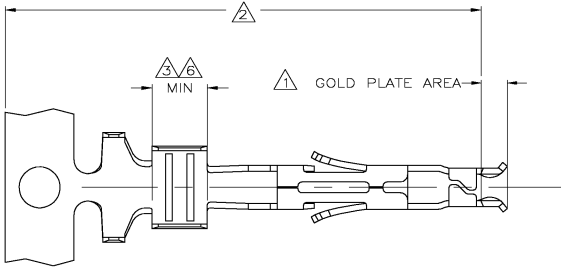

- △ FINISH: 0.76µm MIN GOLD OVER 1.27µm MIN NICKEL REQUIRED ON INNER SURFACE, PERMITTED ON OUTER SURFACE.
- △ FINISH: NICKEL BASE PLATE ON ALL SURFACES IN THIS AREA.
- △ FINISH: 2.54µm MIN TIN-LEAD ON ALL SURFACES IN THIS AREA.
- 4. WIRE RANGE: (2) 0.8-0.9mm² (2 X 18 AWG)
(1) 1.2mm² (1 X 16 AWG)
- 5. INSULATION RANGE: 3.3 [.13] DIAMETER MAXIMUM FOR 2 X 18 AWG AND 3.0 [.12] DIAMETER FOR 1 X 16 AWG.
- △ FINISH: 2.54µm MINIMUM TIN ON ALL SURFACES IN THIS AREA.

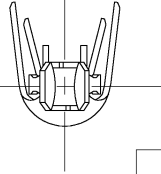
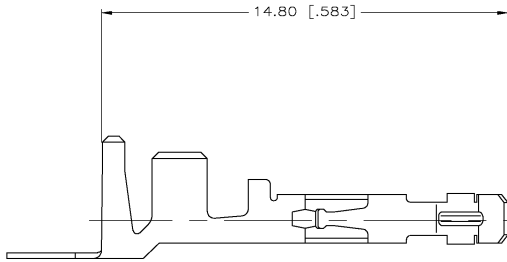

1-794143-3	△1△2△6	0.22 [.009] PHOS BRONZE	1-794140-3
794143-3	△1△2△3	0.22 [.009] PHOS BRONZE	794140-3
LOOSE PIECE (REF)	FINISH	MATERIAL	PART NUMBER



THIS DRAWING IS A CONTROLLED DOCUMENT.		DW: S. HOOVER 08-OCT-2004 DDK: D. COLEY 08-OCT-2004 D: D. COLEY 08-OCT-2004 APPD: D. COLEY 08-OCT-2004 NAME:	Tyco Electronics Tyco Electronics Corporation Harrisburg, Pa 17105-3508
DIMENSIONS: mm [INCHES] 0 P.L.C. # 1 P.L.C. # 2 P.L.C. # Q.10 3 P.L.C. # 4 P.L.C. # ANGLES # FINISH #	TO RANGE (INLET) 0 P.L.C. # 1 P.L.C. # 2 P.L.C. # Q.10 3 P.L.C. # 4 P.L.C. # ANGLES # FINISH #	APPLICATION SPEC: WEIGHT: CUSTOMER DRAWING	CONTACT, SOCKET, AMP-DUAC™ POWER CONNECTOR SEE CASE CODE DRAWING NO: A2 00779 © 794140 RESTRICTED TO:
MATERIAL: SEE TABLE	FINISH: SEE TABLE	CUSTOMER DRAWING	SCALE: 10:1 SHEET 1 OF 1 REV G

AMP 1431-9 REV 31 MAR 2000

794140

B

A