

DUAL CRIMP TABLE

PART NO.	WIRE SIZE
1326030-9	0.35±0.05
AND	0.35±0.35
1-1326030-1	0.35±0.75
AND	0.5±0.5
	0.5±1.75
1-1326030-0	0.35±1.0
AND	0.5±1.0
1-1326030-2	0.35±0.75
AND	0.75±1.0
	0.35±1.5
	1.0±1.0
	1.0±1.5

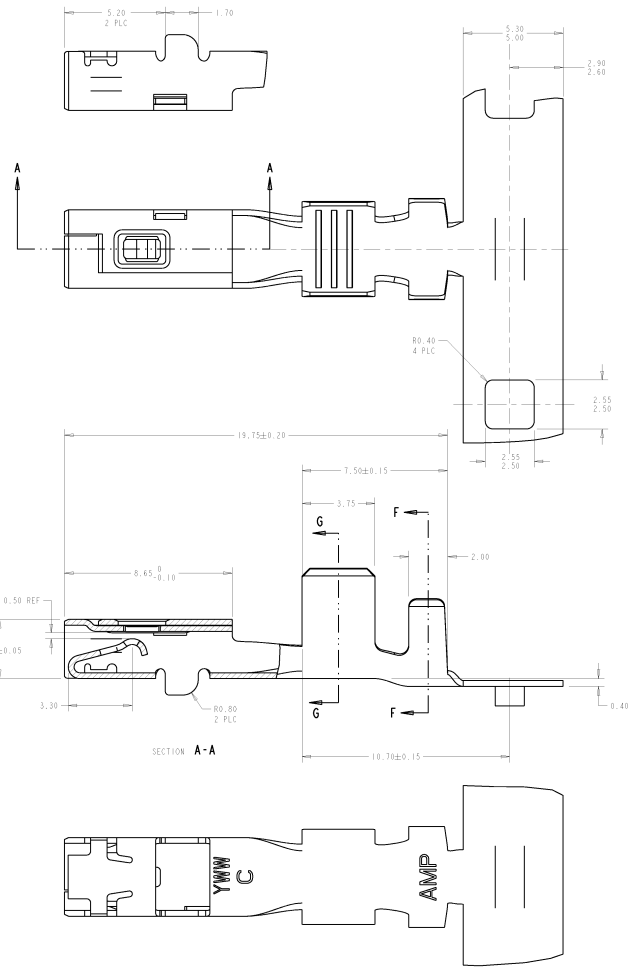

REVISIONS

REV	DATE	DESCRIPTION	BY	CHK	APPV
00					
1		REVISED PER ECR 05-064076			
2		REVISED PER ECR 05-063800			
3		REVISED PER ECR 05-017194			

△ MATERIAL: 0.30 THICK COPPER ALLOY, PREPLATED WITH 0.0005 MINIMUM THICK REFLOW TIN OR BRIGHT TIN (EELY COMPLIANT).
 △ ALTERNATE MATERIAL: 0.30 THICK COPPER ALLOY, PREPLATED WITH 0.0005 MINIMUM THICK BRIGHT TIN (EELY COMPLIANT).

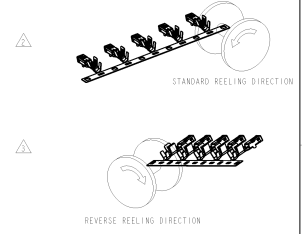

5. QUALIFICATION OF THE CRIMP APPLICATION TOOLING SHALL BE CONTROLLED BY THE REQUIREMENTS ESTABLISHED UNDER USCAR 21.
 6. LOOSE END SPlicing TO BE USED.

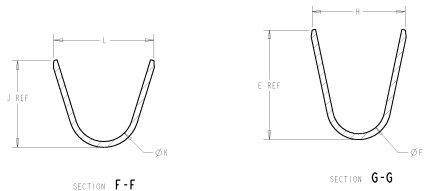

REELING	WIRE SIZE	PART NO.	
1-1326030-0 REELED FOR AMP APPLICATOR	REFERENCE DUAL CRIMP TABLE	1-1326030-2	
1326030-9 REELED FOR AMP APPLICATOR	REFERENCE DUAL CRIMP TABLE	1-1326030-1	
4.6	1.80 5.35 9.9 1.70 3.88	REFERENCE DUAL CRIMP TABLE	1-1326030-0
3.6	1.40 4.32 3.3 1.30 2.76	REFERENCE DUAL CRIMP TABLE	1326030-9
1326030-4 REELED FOR AMP APPLICATORS	12 AWG	1326030-8	
1326030-3 REELED FOR AMP APPLICATORS	14-16 AWG	1326030-7	
1326030-2 REELED FOR AMP APPLICATORS	18-20 AWG	1326030-6	
1326030-1 REELED FOR AMP APPLICATORS	22 AWG	1326030-5	
5.2	3.20 4.22 4.1 2.70 5.25	12 AWG	1326030-4
3.8	1.80 3.16 3.9 1.70 3.88	14-16 AWG	1326030-3
3.1	1.40 2.55 3.3 1.30 2.76	18-20 AWG	1326030-2
2.4	1.00 2.04 2.5 0.90 2.11	22 AWG	1326030-1

AMP
 2.8mm RECEPTACLE, UNSEALED

1326030-0

1326030

1326030