

4

3

2

1

THIS DRAWING IS UNPUBLISHED. RELEASED FOR PUBLICATION. ALL RIGHTS RESERVED.

LOC	DIST	REVISIONS		DATE	BY	APP'D
FX	00	F	LNK			
		C1		REVISED PER ECO-11-005030	11MAR11	RK HMR

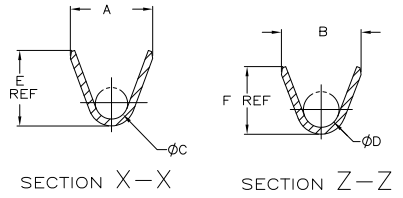
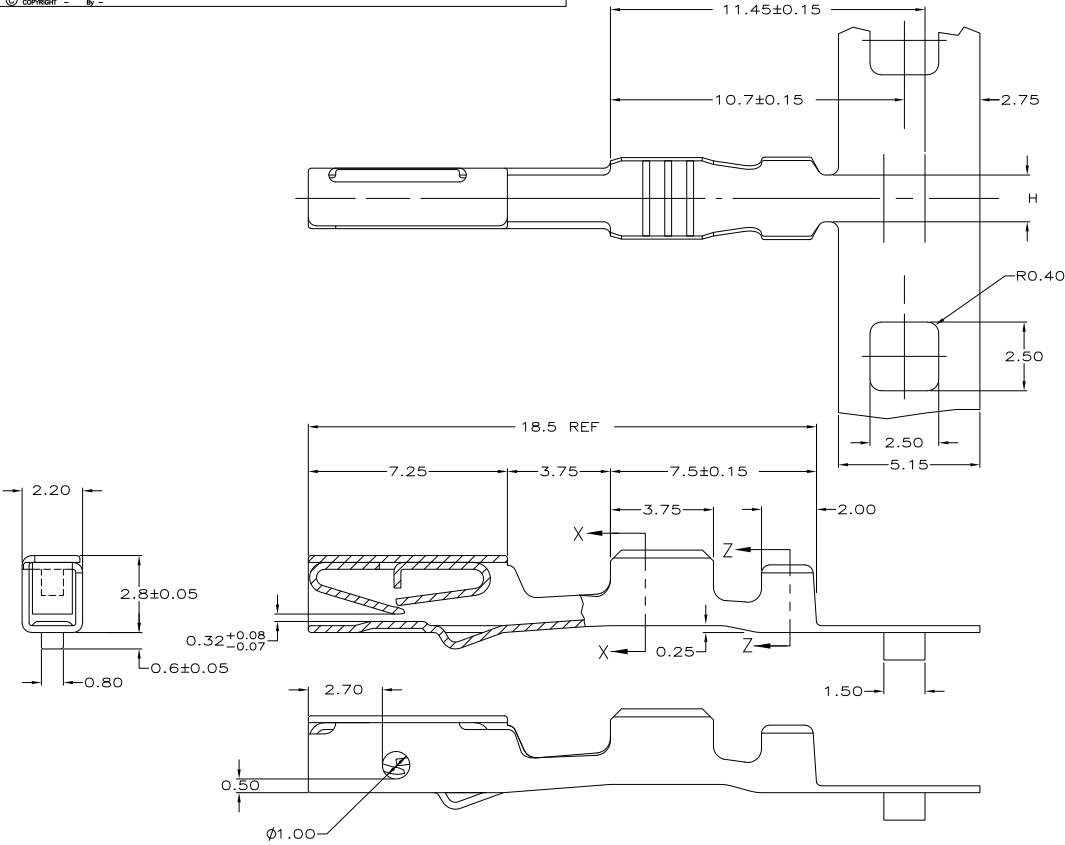

638187-2 REELED LEFT TO RIGHT, OFF TOP, CARRIER INSIDE								638187-4	
638187-1 REELED LEFT TO RIGHT, OFF TOP, CARRIER INSIDE								638187-3	
1.6	1.80	2.04	1.45	0.90	2.40	2.30	0.35	22	638187-2
1.6	1.80	2.04	1.45	0.90	2.40	2.30	0.34-0.36		
1.7	2.46	2.75	1.30	1.20	2.90	3.00	0.50	18-20	638187-1
1.7	2.46	2.75	1.30	1.20	2.90	3.00	1.00		
1.7	2.46	2.75	1.30	1.20	2.90	3.00	--		
H	F	E	D	C	B	A	METRIC WIRE SIZE	#WG	PART NUMBER

MATERIAL: 0.25 THK COPPER ALLOY, PRE-PLATED WITH 0.0008 MIN THK BRIGHT TIN.

THIS DRAWING IS A CONTROLLED DOCUMENT.		DN	J. MCNEAL	04-09-98	 TE Connectivity			
DIMENSIONS: mm		CHK	C. PAUL	04-09-98				
TOLERANCES UNLESS OTHERWISE SPECIFIED:		APPC	C. PAUL	04-09-98				
0 PLG	±	NAME			RECEPTACLE CONTACT, DUAL BEAM			
1 PLG	± 0.2	APPLICATION SPEC:						
2 PLG	± 0.1	114-6063			SIZE	CAGE CODE	DRAWING NO	RESTRICTED TO
3 PLG	±	MATERIAL			A2	00779	C-638187	
4 PLG	±	FINISH			CUSTOMER DRAWING		SCALE	4:1
ANGLES	±				SHEET	1 of 1	REV	C1

1471-9 (3/11)

638187

A

1