

4

3

2

1

THIS DRAWING IS UNPUBLISHED. RELEASED FOR PUBLICATION
 © COPYRIGHT - By - ALL RIGHTS RESERVED.

LOC		DIBT		REVISIONS			
P	LR	DESCRIPTION	DATE	BY	APD		
GE	33						
	C2	REVISED PER ECO-11-005030	11MAR11	RK	HMR		

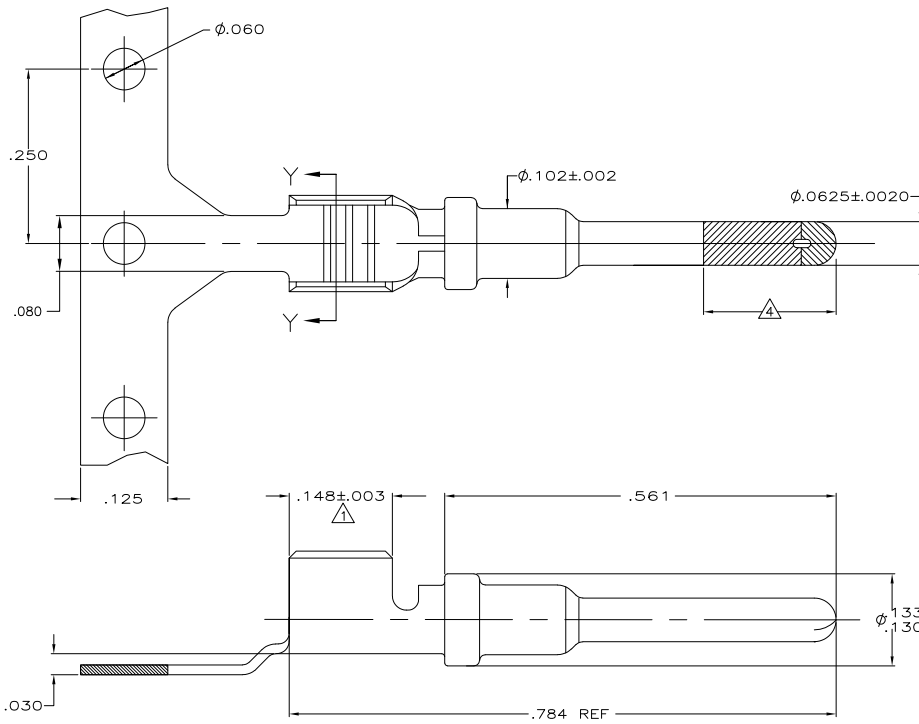

- △ FINISH : PLATE 0.000100-0.000200 THK TIN IN LOCALIZED TIN PLATE AREA, ALL OVER 0.000030-0.000070 THK NICKEL.
- 2. CONTACT WILL BE LUBED WITH LUBRICANT PER P/N 22014-4.
- 3. WIRE RANGE: 18-14 AWG SXL, GXL, AND TXL WIRE WITH INSL DIAMETERS OF 0.077-0.155 INCHES.
- △ PLATE 0.000030 MIN THK SELECT GOLD IN LOCALIZED PLATE AREA.
- △ PLATE .000100-.000200 THK TIN PER 112-65-1 IN LOCALIZED TIN PLATE AREA, ALL OVER .000040-.000080 THK NICKEL PER 112-25-2

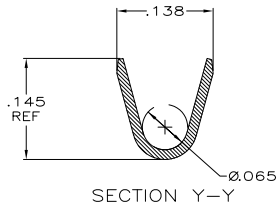

△	638112-3
△	638112-1

THIS DRAWING IS A CONTROLLED DOCUMENT.		DRN	JL MCNEAL	9-30-97
DIMENSIONS: INCHES		CHK		
OTHER DIMENSIONS: MILLIMETERS		APD	W. LONG	10-1-97
MATERIAL: BODY: 0.014 THK COPPER ALLOY		FINISH		
FINISH		APPLICATION SPEC	SIZE	CAGE CODE
		WEIGHT	A2	00779
		CUSTOMER DRAWING	C	638112
		SCALE	10:1	SHEET 1 of 1
		REV	C2	

TE TE Connectivity

PIN CONTACT
WIRE-TO-WIRE