

DRAWING MADE IN THIRD ANGLE PROJECTION

© COPYRIGHT 1973 BY AMP INCORPORATED, HARRISBURG, PA. ALL INTERNATIONAL RIGHTS RESERVED. AMP INCORPORATED PRODUCTS COVERED BY U. S. AND FOREIGN PATENTS AND/OR PATENTS PENDING.

1 Loc CM DIST 53

		REVISIONS				
P	F	ZONE	LTR	DESCRIPTION	DATE	APPROVED
✓	✓		E	REDWN W/O CHANGE M-5090	5-7-78	JW/DH
✓			E	RESTORED	4/1/85	BKD/RS
✓			F	OBSOLETE -7 CM-473	4-15-86	KW/RS
✓			G	OBSOLETE -2 PER ECN CM-761	4/28/87	PCC/TB
			H	REV PER EC 0730-3607-91	1-6-94	RV/RS

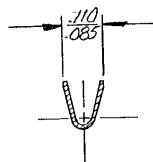
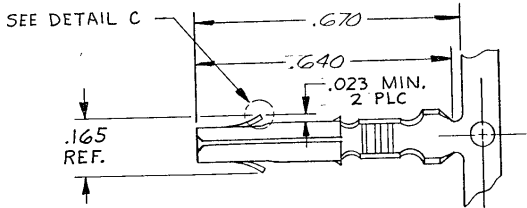

SECTION A-A

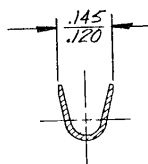
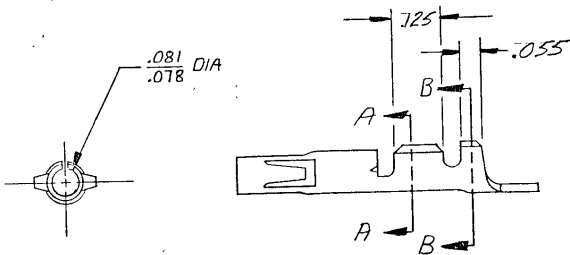

SECTION B-B

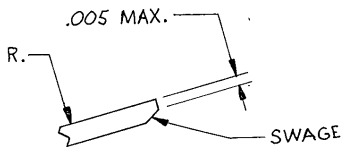

DETAIL C

.100 MAX	24-18 AWG			
		BRASS	PRE-TIN	350560-1
		MATL	FINISH	PART NO

UNLESS OTHERWISE SPECIFIED DIMENSIONS ARE IN INCHES. TOLERANCES ON: DECIMALS ± .015 ANGLES ± 1°	CONTRACT NO	AMP INCORPORATED Harrisburg, Pa		
	DR	NAME SOCKET, MATE-N-LOK™ DUAL LANCE		
	CHK	SIZE B	CODE IDENT NO 00779	DRAWING NO 350560
	MATERIAL	APPD	SCALE 7	SHEET 1 OF 1
SEE TABLE	APPD			
FINISH	OTHER APPD			
SEE TABLE				

CUSTOMER DRAWING