

DRAWING MADE IN THIRD ANGLE PROJECTION

© COPYRIGHT 1974 BY AMP INCORPORATED, HARRISBURG, PA.  
 ALL INTERNATIONAL RIGHTS RESERVED. AMP INCORPORATED PRODUCTS  
 COVERED BY U. S. AND FOREIGN PATENTS AND/OR PATENTS PENDING.

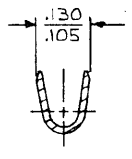
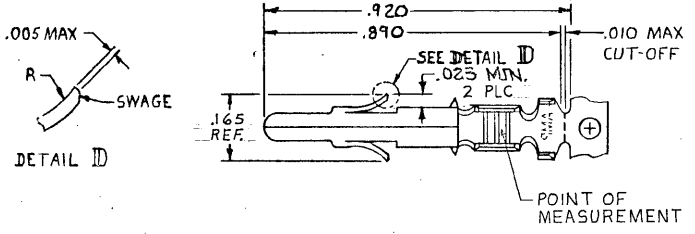

P	F	ZONE	LTR	DESCRIPTION	DATE	APPROVED
✓	✓		F	REDRAWN W/O CHANGE M-6457	6-5-81	MSE/DH
✓	✓		G	ADDED -3 PER TTI 82-61	9-30-82	MSE/DH
✓	✓		H	REVISED AG 57	10/2/82	MS/DH
✓	✓		H <sub>1</sub>	RESTORED	4/4/83	MS/DH
✓	✓		J	OBsolete -3 CM 473	4-15-86	KW/RS
✓	✓		K	RLSD -7 PER PR CM 90-7	1-17-90	TB/RS
✓	✓		L	REVISED PER CM-3286	2-7-91	PCD/RS
✓	✓		M	REV PER EC 0730-3607-91	1-7-94	RV/RS
✓	✓		N	REV PER EC 0730-0141-94	7-26-94	RV/RS

△ .000030 MIN GOLD AT POINT OF MEASUREMENT IN GOLD PLATE AREA; .000030 MIN TIN IN TIN PLATE AREA; .000050 NICKEL UNDERPLATE ON ENTIRE CONTACT.

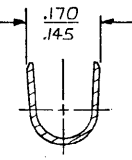
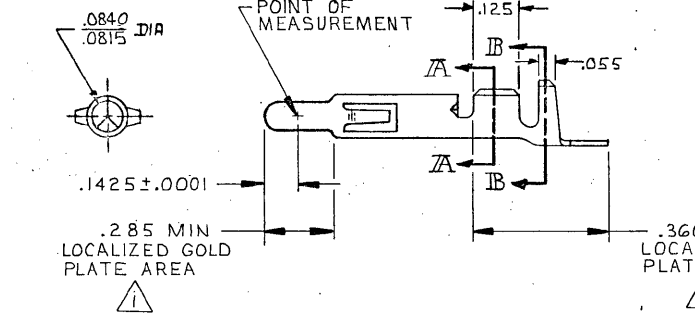

	△	.012 BRASS	350654-7
350669-1	PRE-TIN	.012 BRASS	350654-1
LOOSE PIECE (REF)	FINISH	MATERIAL	PART NO

UNLESS OTHERWISE SPECIFIED DIMENSIONS ARE IN INCHES. TOLERANCES ON: DECIMALS ± .015 ANGLES ±	CONTRACT NO	AMP   AMP INCORPORATED Harrisburg, Pa.	
	DR m. Foker 5-6-81	NAME PIN, GROUNDING UNIVERSAL MATE-N-LOK	
WIRE RANGE	CHK D. S. Cole 6/9/81	SIZE B	CODE IDENT NO 00779
20-14 AWG	APPD P. L. L. 6-10-81	DRAWING NO	350654
INSULATION RANGE	DSGN APPD	SCALE NTS	SHEET #
.130 DIA MAX	OTHER APPD		

AMP 1470-15 REV 8-79

CUSTOMER DRAWING