

MAKING MADE IN NORTH AMERICA PROJECTION
 THIS DRAWING IS UNPUBLISHED
 RELEASED FOR PUBLICATION
 BY AMP INCORPORATED. ALL INTERNATIONAL RIGHTS RESERVED.

REVOLUTIONS		DESCRIPTION		DATE	APPD
CM	52	REV	BY	PER	EC
		C	REV & REDWN	PER EC	0730-005B-05
					3-21-06
					ES-05

- 1 WIRE RANGE; 0.13-0.8mm² (26-18 AWG).
 - 2 INSULATION RANGE; 1.27-2.92 (.050-.115) MAX. DIA.
 - 3 DIMENSIONS IN BRACKETS ARE IN INCHES.
- ⚠ TIP PLATE WITH 0.00075-0.00091 (.000030-.000036) MIN GOLD IN THE LOCALIZED GOLD PLATE AREA OVER 0.00127 (.000050) MIN NICKEL UNDERPLATE.

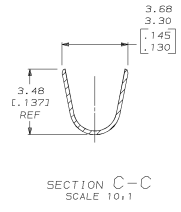
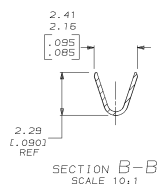
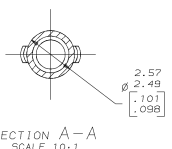
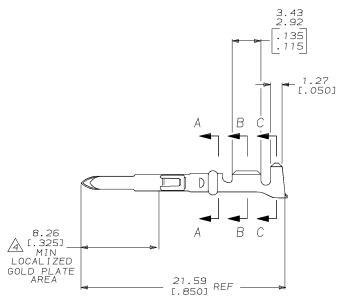
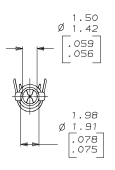
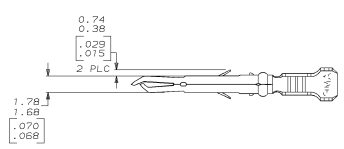

⚠ GOLD PLATE	0.20 (.008) PHOS BRZ	640580-2
PRE-TIN	0.20 (.008) PHOS BRZ	640580-1

FINISH	MATERIAL	PART NO
DR 3-21-05 C-34RON	AMP Incorporated Harrisburg, PA 17105-3608	
CKR 3-21-05 C-34RON		
APPD 3-21-05 M-LONG	NAME	
APPD 3-21-05 M-LONG	PRODUCT SPEC	
FINISH	APPLICATION SPEC	SIZE CASE CODE DRAWING NO
SEE TABLE		D 00773 C-640580
WEIGHT		SCALE 5:1 SHEET 1 OF 1

METRIC

THIS DRAWING IS A CONTROLLED DOCUMENT FOR AMP INCORPORATED. IT IS SUBJECT TO CHANGE AND THE CONTROLLING ORGANIZATION SHOULD BE CONTACTED FOR THE LATEST REVISION.