

# Customer Information Sheet

DRAWING No.: M80-315 TO M80-317 SHEET 2 OF 2 IF IN DOUBT - ASK (C) NOT TO SCALE THIRD ANGLE PROJECTION ALL DIMENSIONS IN mm

**SPECIFICATIONS:**

**MATERIALS:**  
 BODY, SLEEVE, INNER CONTACT = COPPER ALLOY  
 LATCHING COLLAR = BERYLLIUM COPPER  
 INSULATOR = PTFE

**FINISH:**  
 BODY, SLEEVE, INNER CONTACT = GOLD  
 LATCHING COLLAR = NICKEL

**ELECTRICAL:**  
 FREQUENCY RANGE = 6GHz  
 IMPEDANCE =  $50\Omega$   
 V.S.W.R. =  $1.05 + (0.04 \times \text{FREQUENCY}) \text{ GHz MAX}$   
 CONTACT RESISTANCE =  $6m\Omega \text{ MAX}$   
 INSULATION RESISTANCE =  $10^6 m\Omega @ 250V \text{ AC}$   
 OPERATING VOLTAGE = 180V AC @ 500mA  
 MAXIMUM VOLTAGE = 1,000V AC

**MECHANICAL:**  
 DURABILITY = 500 OPERATIONS  
 INSERTION FORCE = 5N MAX, 0.6N MIN  
 WITHDRAWAL FORCE = 2N MAX, 0.5N MIN  
 CONTACT REPLACEMENT IN INSULATOR = 5 TIMES

**ENVIRONMENTAL:**  
 TEMPERATURE RANGE = -55°C TO +125°C

3.00<sup>0</sup><sub>-0.10</sub>  
 SQUARE

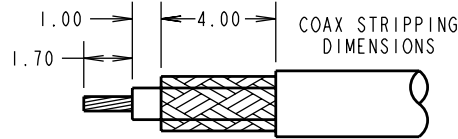
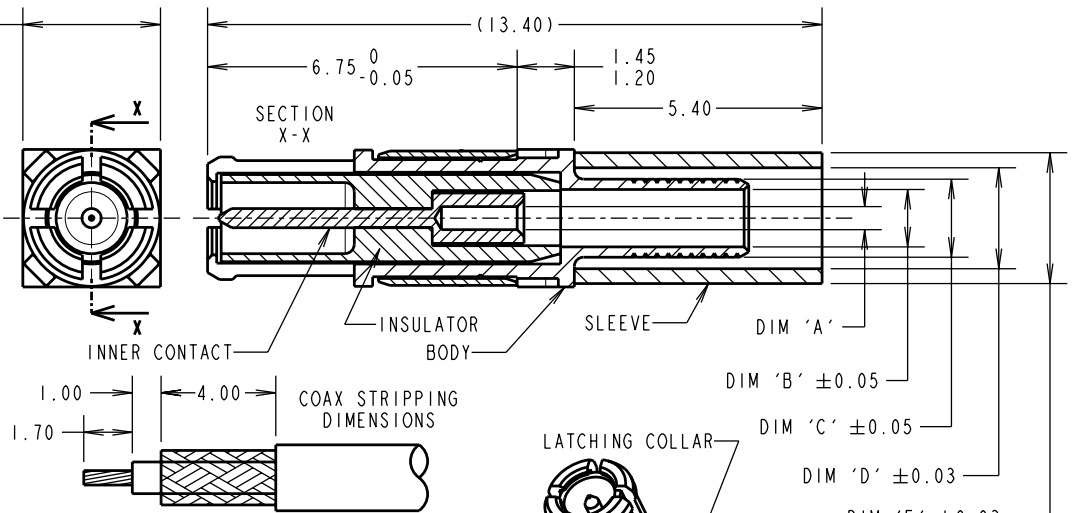

- NOTES:**
- CONNECTOR COMES SUPPLIED AS A KIT OF PARTS: BODY, INSULATOR, AND LATCHING COLLAR ARE PRE-ASSEMBLED, SLEEVE AND INNER CONTACT ARE SEPARATE.
  - RECOMMENDED HAND CRIMP TOOL FOR INNER CONTACT = Z80-292 WITH POSITIONER Z80-291. RECOMMENDED HAND CRIMP TOOL AND DIE SET FOR SLEEVE = Z80-293.
  - CONTACT EXTRACTION TOOL = Z80-290
  - FOR ALL OTHER ELECTRICAL/MECHANICAL REQUIREMENTS, SEE COMPONENT SPECIFICATION C005XX (LATEST ISSUE).

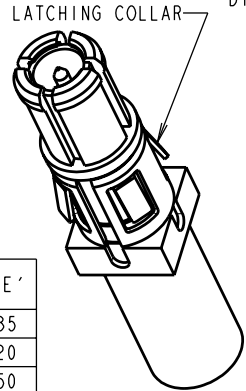

MGP	3	27.01.09	10272
NAME	ISS.	DATE	C/NOTE
APPROVED: MGP			
CHECKED: RA			
DRAWN: W. J. BOURNE			
CUSTOMER REF.:			
ASSEMBLY DRG:			

PART No.	CABLE DIAMETER (TYPE)	DIM 'A'	DIM 'B'	DIM 'C'	DIM 'D'	DIM 'E'
M80-315	∅2.0mm (RG178)	∅0.50 ±0.05	∅1.25	∅1.70	∅2.20	∅2.85
M80-316	∅2.4mm (PTFE CELLULAR)	∅0.35 +0.05/-0	∅1.25	∅1.70	∅2.70	∅3.20
M80-317	∅2.7mm (RG174, 179, 316)	∅0.70 ±0.05	∅1.75	∅2.35	∅2.85	∅3.50



**HARWIN USA**  
 TEL: 603 893 5376  
 FAX: 603 893 5396  
 mis@harwin.com

**HARWIN Europe (UK)**  
 TEL: 023 9231 4545  
 FAX: 023 9231 4590  
 mis@harwin.co.uk

**HARWIN Asia**  
 TEL: +65 6 779 4909  
 FAX: +65 6 779 3868  
 mis@harwin.com.sg

THIS DRAWING AND ANY INFORMATION OR DESCRIPTIVE MATTER SET OUT HEREON ARE CONFIDENTIAL AND COPYRIGHT PROPERTY OF THE HARWIN GROUP AND MUST NOT BE DISCLOSED, LOANED, COPIED OR USED FOR MANUFACTURING, TENDERING OR FOR ANY OTHER PURPOSE WITHOUT THEIR WRITTEN PERMISSION.

**TOLERANCES**  
 X. = ±1mm  
 X.X = ±0.25mm  
 X.XX = ±0.10mm  
 X.XXX = ±0.01mm  
 ANGLES = ±5°  
 UNLESS STATED

**MATERIAL:**  
 SEE ABOVE

**FINISH:**  
 SEE ABOVE

**S/AREA:**  
 mm²

**TITLE:** DATAMATE MIX-TEK COAX CONTACT MALE STRAIGHT CRIMP

**DRAWING NUMBER:**  
 M80-315 TO M80-317

SHT 2 OF 2